

M-14484

1

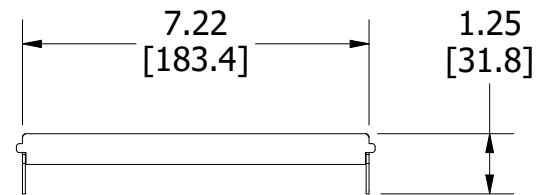
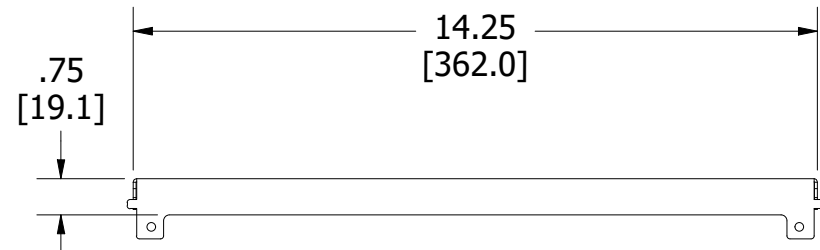
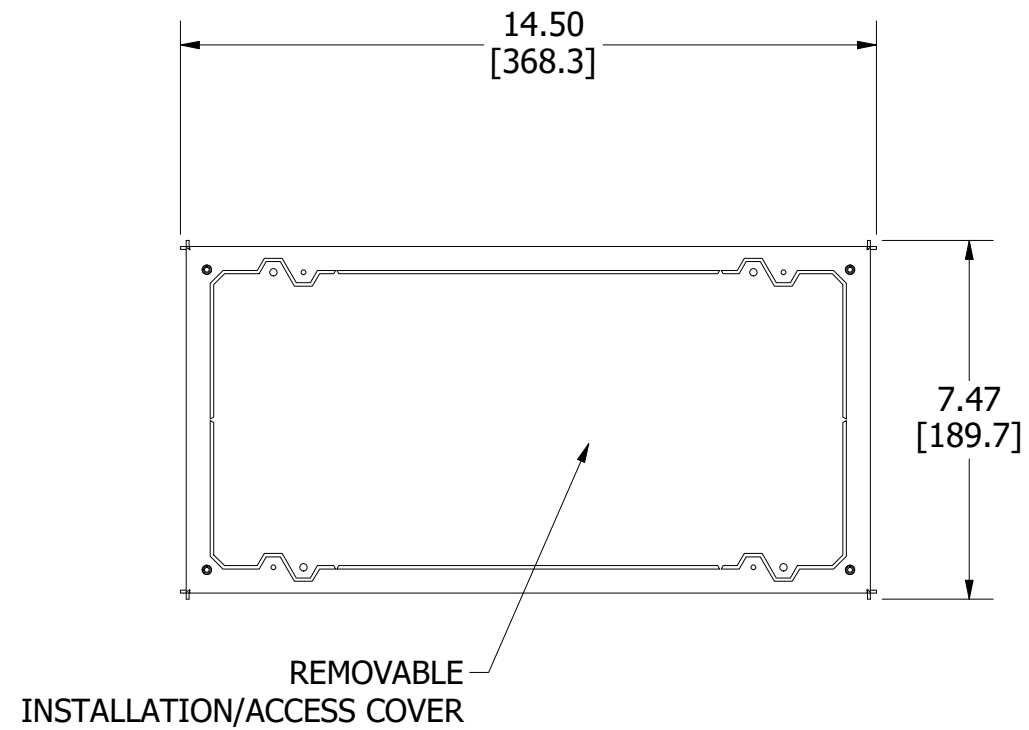

NOTES:

1. ALL DIMENSIONS ARE IN INCHES AND [MILLIMETERS].
2. COMPATIBLE WITH HRWB25xxx 5 GANG RECESSED WALL BOX.
3. INSTALLATION HARDWARE PROVIDED.

LIST OF PARTS

DESCRIPTION	MATERIAL	FINISH
EXTENSION COVER	STEEL	ZINC
FASTENERS	STEEL	ZINC

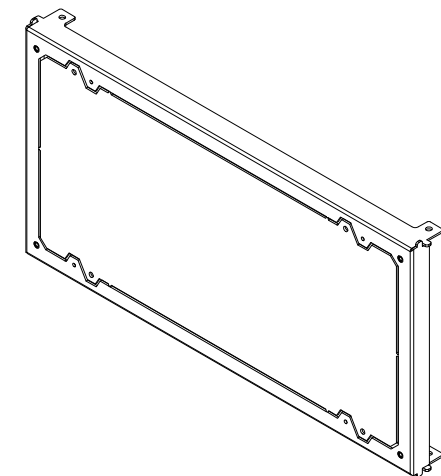

ISOMETRIC VIEW

1	DRAWING RELEASE PER EC 221101025273 TS	SW	11/01/22
REV	DESCRIPTION	APP	DATE

THE DESIGN AND DIMENSIONS OF THE PRODUCT SHOWN ON THIS DRAWING ARE SUBJECT TO CHANGE WITHOUT NOTICE. DIMENSIONS ARE IN INCHES [mm].

TITLE  
3/4" BOX EXTENSION, HRWB25 BOX SERIES



WIRING DEVICE-KELLEMS  
HUBBELL INCORPORATED  
SHELTON, CT

TOLERANCES UNLESS OTHERWISE SPECIFIED .XX = ± .01 .XXX = ± .005 ANGLE TOL. ±2'	DR. BY VKK	SCALE 1 : 4
	CHK. BY SW	DATE 12/14/21

DIMENSION SHEET FOR CAT. NO.  
HRWB25BE075

**B**

M-14484

**1**