

**LINE TERMINAL DETAIL**

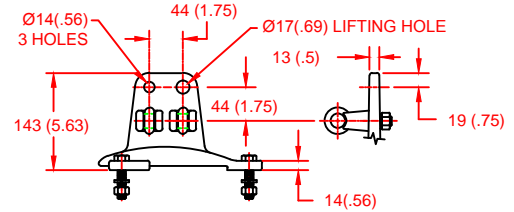

HDG 4-HOLE TERMINAL PAD, PART No. 901704001  
 TWO HDG TERMINALS, PART No. 2714143001  
 SUITABLE FOR COPPER OR ALUMINUM CONDUCTOR SIZE  
 Ø 7 (.25) - Ø 21 (.81)  
 25 - 240 sq mm  
 AWG#4 - 500 MCM

**GROUND TERMINAL DETAIL**

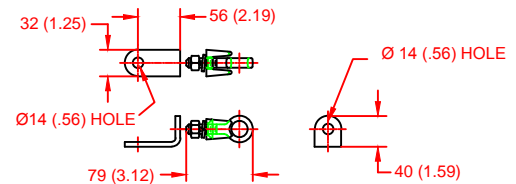

HDG TERMINAL BRACKET, PART No. 896064001  
 ONE HDG TERMINAL, PART No. 2714143001  
 SUITABLE FOR COPPER OR ALUMINUM CONDUCTOR SIZE  
 Ø 7 (.25) - Ø 21 (.81)  
 25 - 240 sq mm  
 AWG#4 - 500 MCM

Ø = DIAMETER  
 HDG = HOT DIP GALVANIZED

| CHARACTERISTICS   |                  |
|-------------------|------------------|
| RATED VOLTAGE, Ur | 192 kVrms        |
| MCOV, Uc          | 153.6 kVrms      |
| MASS              | 232kg (510lb)    |
| CREEPAGE DISTANCE | 6414 (252.5)     |
| LIGHTNING IMP W/S | 1018 kV          |
| SWITCHING IMP W/S | 936 kV           |
| POWER FREQ W/S    | 588 kVrms        |
| TOV 1s            | 212 kVrms        |
| TOV 10s           | 199 kVrms        |
| SLL BENDING FORCE | 2800 N (629lbf)  |
| SSL BENDING FORCE | 6999 N (1573lbf) |
| COG ABOVE BASE    | 1219 (48.0)      |
| HOUSING           | BROWN PORCELAIN  |

| RECOMMENDED CLEARANCE (TO METAL PARTS) |             |
|--|-------------|
| PHASE TO GROUND                        | 887 (34.9)  |
| PHASE TO PHASE                         | 1017 (40.0) |

- NOTES:  
 1. DIMENSIONS IN millimeters(inches) SUBJECT TO ±3% TOLERANCE  
 2. CLEARANCE AND INSULATION W/S VOLTAGE APPLY AT SEA LEVEL  
 3. ARRESTER SUITABLE FOR OPERATION AT ALTITUDES UP TO 3650m (12000ft)

| RESIDUAL VOLTAGE (kV) FOR INDICATED IMPULSE TYPES AND CURRENT MAGNITUDES |                   |      |                        |       |       |       |
|--|-------------------|------|------------------------|-------|-------|-------|
| STEEP CURRENT IMPULSE  | SWITCHING IMPULSE |      | 8/20 LIGHTNING IMPULSE |       |       |       |
| 20 kA  | 0.5 kA            | 2 kA | 5 kA                   | 10 kA | 20 kA | 40 kA |
| 591  | 375               | 398  | 430                    | 451   | 483   | 532   |

IEC CLASS 4  
 SURGE ARRESTER

Program Revision  
 2018.12.3.03.25.15

REV DATE  
 12/03/15

CONFIDENTIAL: THIS DRAWING AND ITS CONTENTS ARE CONFIDENTIAL AND THE EXCLUSIVE PROPERTY OF HUBBELL POWER SYSTEMS. NO PUBLICATION, DISTRIBUTION OR COPIES MAY BE MADE WITHOUT THE WRITTEN CONSENT OF HUBBELL POWER SYSTEMS. HUBBELL POWER SYSTEMS UNPUBLISHED ALL RIGHTS RESERVED UNDER THE COPYRIGHT LAWS.

| TITLE  |          |                       |        |
|--|----------|-----------------------|--------|
| <b>MH4 ARRESTER<br/>192 KV RATED VOLTAGE</b> |          |                       |        |
| SIZE   | DWG NO.  | CAT / PART / ASSY NO. | REV    |
| S  | 19831441 | MH4245BH192AA         | 2      |
| DO NOT SCALE THIS DRAWING                    | DRN BY   | DATE                  | SHEET  |
|  | NON      | 03/22/11              | 1 OF 1 |



**HUBBELL POWER SYSTEMS**