

LINE TERMINAL DETAIL

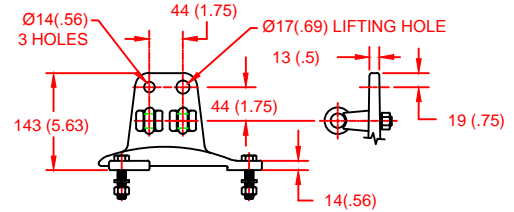

HDG 4-HOLE TERMINAL PAD, PART No. 901704001
 TWO HDG TERMINALS, PART No. 2714143001
 SUITABLE FOR COPPER OR ALUMINUM CONDUCTOR SIZE
 Ø 7 (.25) - Ø 21 (.81)
 25 - 240 sq mm
 AWG#4 - 500 MCM

GROUND TERMINAL DETAIL

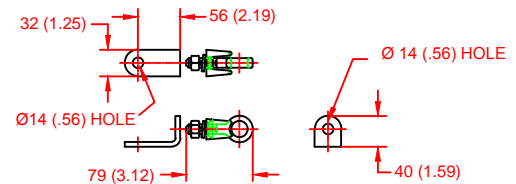

HDG TERMINAL BRACKET, PART No. 896064001
 ONE HDG TERMINAL, PART No. 2714143001
 SUITABLE FOR COPPER OR ALUMINUM CONDUCTOR SIZE
 Ø 7 (.25) - Ø 21 (.81)
 25 - 240 sq mm
 AWG#4 - 500 MCM

Ø = DIAMETER
 HDG = HOT DIP GALVANIZED

CHARACTERISTICS	
RATED VOLTAGE, Ur	216 kVrms
MCOV, Uc	172.8 kVrms
MASS	223kg (490lb)
CREEPAGE DISTANCE	5747 (226.3)
LIGHTNING IMP W/S	950 kV
SWITCHING IMP W/S	870 kV
POWER FREQ W/S	506 kVrms
TOV 1s	239 kVrms
TOV 10s	224 kVrms
SLL BENDING FORCE	3004 N (675lbf)
SSL BENDING FORCE	7509 N (1688lbf)
COG ABOVE BASE	1122 (44.2)
HOUSING	GREY PORCELAIN

RECOMMENDED CLEARANCE (TO METAL PARTS)	
PHASE TO GROUND	1003 (39.5)
PHASE TO PHASE	1147 (45.2)

- NOTES:
 1. DIMENSIONS IN millimeters(inches) SUBJECT TO ±3% TOLERANCE
 2. CLEARANCE AND INSULATION W/S VOLTAGE APPLY AT SEA LEVEL
 3. ARRESTER SUITABLE FOR OPERATION AT ALTITUDES UP TO 2650m (8600ft)

RESIDUAL VOLTAGE (kV) FOR INDICATED IMPULSE TYPES AND CURRENT MAGNITUDES						
STEEP CURRENT IMPULSE	SWITCHING IMPULSE		8/20 LIGHTNING IMPULSE			
20 kA	0.5 kA	2 kA	5 kA	10 kA	20 kA	40 kA
655	421	447	483	507	543	598

IEC CLASS 4
 SURGE ARRESTER

Program Revision
 2018.12.3.03.25.15

REV DATE
 12/03/15

CONFIDENTIAL: THIS DRAWING AND ITS CONTENTS ARE CONFIDENTIAL AND THE EXCLUSIVE PROPERTY OF HUBBELL POWER SYSTEMS. NO PUBLICATION, DISTRIBUTION OR COPIES MAY BE MADE WITHOUT THE WRITTEN CONSENT OF HUBBELL POWER SYSTEMS. HUBBELL POWER SYSTEMS UNPUBLISHED ALL RIGHTS RESERVED UNDER THE COPYRIGHT LAWS.

TITLE
**MH4 ARRESTER
 216 KV RATED VOLTAGE**

SIZE	DWG NO.	CAT / PART / ASSY NO.	REV
S	19831440	MH4245GM216AA	2
DO NOT SCALE THIS DRAWING	DRN BY	DATE	SHEET
	NON	03/22/11	1 OF 1



HUBBELL POWER SYSTEMS