

LINE TERMINAL DETAIL

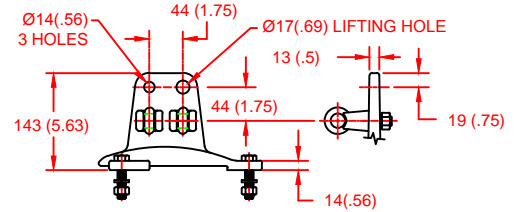

HDG 4-HOLE TERMINAL PAD, PART No. 901704001
 TWO HDG TERMINALS, PART No. 2714143001
 SUITABLE FOR COPPER OR ALUMINUM CONDUCTOR SIZE
 Ø 7 (.25) - Ø 21 (.81)
 25 - 240 sq mm
 AWG#4 - 500 MCM

GROUND TERMINAL DETAIL

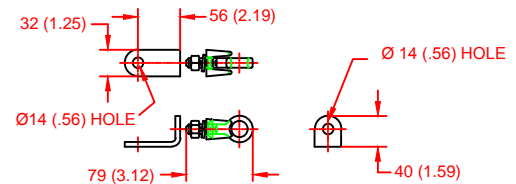

HDG TERMINAL BRACKET, PART No. 896064001
 ONE HDG TERMINAL, PART No. 2714143001
 SUITABLE FOR COPPER OR ALUMINUM CONDUCTOR SIZE
 Ø 7 (.25) - Ø 21 (.81)
 25 - 240 sq mm
 AWG#4 - 500 MCM

Ø = DIAMETER
 HDG = HOT DIP GALVANIZED

CHARACTERISTICS	
RATED VOLTAGE, Ur	240 kVrms
MCOV, Uc	192 kVrms
MASS	242kg (532lb)
CREEPAGE DISTANCE	6414 (252.5)
LIGHTNING IMP W/S	1018 kV
SWITCHING IMP W/S	936 kV
POWER FREQ W/S	588 kVrms
TOV 1s	265 kVrms
TOV 10s	248 kVrms
SLL BENDING FORCE	2800 N (629lbf)
SSL BENDING FORCE	6999 N (1573lbf)
COG ABOVE BASE	1198 (47.2)
HOUSING	GREY PORCELAIN

RECOMMENDED CLEARANCE (TO METAL PARTS)	
PHASE TO GROUND	1120 (44.1)
PHASE TO PHASE	1280 (50.4)

- NOTES:
 1. DIMENSIONS IN millimeters(inches) SUBJECT TO ±3% TOLERANCE
 2. CLEARANCE AND INSULATION W/S VOLTAGE APPLY AT SEA LEVEL
 3. ARRESTER SUITABLE FOR OPERATION AT ALTITUDES UP TO 2500m (8200ft)

RESIDUAL VOLTAGE (kV) FOR INDICATED IMPULSE TYPES AND CURRENT MAGNITUDES						
STEEP CURRENT IMPULSE	SWITCHING IMPULSE		8/20 LIGHTNING IMPULSE			
20 kA	0.5 kA	2 kA	5 kA	10 kA	20 kA	40 kA
726	469	497	537	564	604	665

IEC CLASS 4
 SURGE ARRESTER

Program Revision
 2018.12.3.03.25.15

REV DATE
 12/03/15

CONFIDENTIAL: THIS DRAWING AND ITS CONTENTS ARE CONFIDENTIAL AND THE EXCLUSIVE PROPERTY OF HUBBELL POWER SYSTEMS. NO PUBLICATION, DISTRIBUTION OR COPIES MAY BE MADE WITHOUT THE WRITTEN CONSENT OF HUBBELL POWER SYSTEMS. HUBBELL POWER SYSTEMS UNPUBLISHED ALL RIGHTS RESERVED UNDER THE COPYRIGHT LAWS.

TITLE			
MH4 ARRESTER 240 KV RATED VOLTAGE			
SIZE	DWG NO.	CAT / PART / ASSY NO.	REV
S	19831439	MH4300GM240AA	2
DO NOT SCALE THIS DRAWING	DRN BY	DATE	SHEET
	NON	03/22/11	1 OF 1