

LINE TERMINAL DETAIL

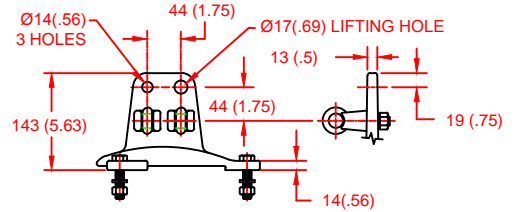

HDG 4-HOLE TERMINAL PAD, PART No. 901704001
 TWO HDG TERMINALS, PART No. 2714143001
 SUITABLE FOR COPPER OR ALUMINUM CONDUCTOR SIZE
 Ø 7 (.25) - Ø 21 (.81)
 25 - 240 sq mm
 AWG#4 - 500 MCM

GROUND TERMINAL DETAIL

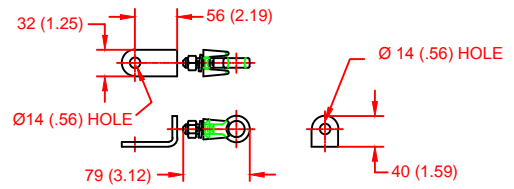

HDG TERMINAL BRACKET, PART No. 896064001
 ONE HDG TERMINAL, PART No. 2714143001
 SUITABLE FOR COPPER OR ALUMINUM CONDUCTOR SIZE
 Ø 7 (.25) - Ø 21 (.81)
 25 - 240 sq mm
 AWG#4 - 500 MCM

Ø = DIAMETER
 HDG = HOT DIP GALVANIZED

CHARACTERISTICS	
RATED VOLTAGE, Ur	288 kVrms
MCOV, Uc	230.4 kVrms
MASS	280kg (615lb)
CREEPAGE DISTANCE	7748 (305.0)
LIGHTNING IMP W/S	1206 kV
SWITCHING IMP W/S	1064 kV
POWER FREQ W/S	690 kVrms
TOV 1s	318 kVrms
TOV 10s	298 kVrms
SLL BENDING FORCE	2464 N (554lbf)
SSL BENDING FORCE	6161 N (1385lbf)
COG ABOVE BASE	1376 (54.2)
HOUSING	GREY PORCELAIN

RECOMMENDED CLEARANCE (TO METAL PARTS)	
PHASE TO GROUND	1350 (53.2)
PHASE TO PHASE	1540 (60.6)

- NOTES:
 1. DIMENSIONS IN millimeters(inches) SUBJECT TO ±3% TOLERANCE
 2. CLEARANCE AND INSULATION W/S VOLTAGE APPLY AT SEA LEVEL
 3. ARRESTER SUITABLE FOR OPERATION AT ALTITUDES UP TO 2150m (7100ft)

RESIDUAL VOLTAGE (kV) FOR INDICATED IMPULSE TYPES AND CURRENT MAGNITUDES						
STEEP CURRENT IMPULSE	SWITCHING IMPULSE		8/20 LIGHTNING IMPULSE			
20 kA	0.5 kA	2 kA	5 kA	10 kA	20 kA	40 kA
868	562	596	644	676	724	797

IEC CLASS 4
 SURGE ARRESTER

Program Revision
 2018.12.3.03.25.15

REV DATE
 12/03/15

CONFIDENTIAL: THIS DRAWING AND ITS CONTENTS ARE CONFIDENTIAL AND THE EXCLUSIVE PROPERTY OF HUBBELL POWER SYSTEMS. NO PUBLICATION, DISTRIBUTION OR COPIES MAY BE MADE WITHOUT THE WRITTEN CONSENT OF HUBBELL POWER SYSTEMS. HUBBELL POWER SYSTEMS UNPUBLISHED ALL RIGHTS RESERVED UNDER THE COPYRIGHT LAWS.

TITLE			
MH4 ARRESTER 288 KV RATED VOLTAGE			
SIZE	DWG NO.	CAT / PART / ASSY NO.	REV
S	19831492	MH4362GM288AA	2
DO NOT SCALE THIS DRAWING	DRN BY	DATE	SHEET
	NON	03/22/11	1 OF 1



HUBBELL POWER SYSTEMS