

LINE TERMINAL DETAIL

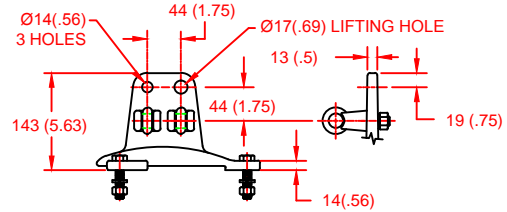

HDG 4-HOLE TERMINAL PAD, PART No. 901704001
 TWO HDG TERMINALS, PART No. 2714143001
 SUITABLE FOR COPPER OR ALUMINUM CONDUCTOR SIZE
 Ø 7 (.25) - Ø 21 (.81)
 25 - 240 sq mm
 AWG#4 - 500 MCM

GROUND TERMINAL DETAIL

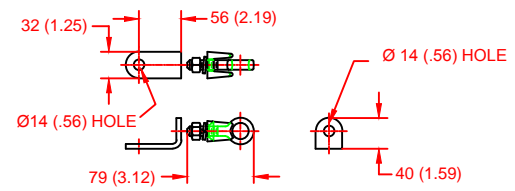

HDG TERMINAL BRACKET, PART No. 896064001
 ONE HDG TERMINAL, PART No. 2714143001
 SUITABLE FOR COPPER OR ALUMINUM CONDUCTOR SIZE
 Ø 7 (.25) - Ø 21 (.81)
 25 - 240 sq mm
 AWG#4 - 500 MCM

Ø = DIAMETER
 HDG = HOT DIP GALVANIZED

CHARACTERISTICS	
RATED VOLTAGE, Ur	336 kVrms
MCOV, Uc	268.8 kVrms
MASS	393kg (866lb)
CREEPAGE DISTANCE	10955 (431.3)
LIGHTNING IMP W/S	1715 kV
SWITCHING IMP W/S	1532 kV
POWER FREQ W/S	984 kVrms
TOV 1s	371 kVrms
TOV 10s	348 kVrms
SLL BENDING FORCE	1743 N (392lbf)
SSL BENDING FORCE	4357 N (979lbf)
COG ABOVE BASE	2033 (80.1)
HOUSING	BROWN PORCELAIN

RECOMMENDED CLEARANCE (TO METAL PARTS)	
PHASE TO GROUND	1583 (62.3)
PHASE TO PHASE	1803 (71.0)

- NOTES:
 1. DIMENSIONS IN millimeters(inches) SUBJECT TO ±3% TOLERANCE
 2. CLEARANCE AND INSULATION W/S VOLTAGE APPLY AT SEA LEVEL
 3. ARRESTER SUITABLE FOR OPERATION AT ALTITUDES UP TO 3150m (10300ft)

RESIDUAL VOLTAGE (kV) FOR INDICATED IMPULSE TYPES AND CURRENT MAGNITUDES						
STEEP CURRENT IMPULSE	SWITCHING IMPULSE		8/20 LIGHTNING IMPULSE			
20 kA	0.5 kA	2 kA	5 kA	10 kA	20 kA	40 kA
1026	655	696	752	789	845	930

IEC CLASS 4
 SURGE ARRESTER

Program Revision
 2018.12.3.03.25.15
 REV DATE 12/03/15

CONFIDENTIAL: THIS DRAWING AND ITS CONTENTS ARE CONFIDENTIAL AND THE EXCLUSIVE PROPERTY OF HUBBELL POWER SYSTEMS. NO PUBLICATION, DISTRIBUTION OR COPIES MAY BE MADE WITHOUT THE WRITTEN CONSENT OF HUBBELL POWER SYSTEMS. HUBBELL POWER SYSTEMS UNPUBLISHED ALL RIGHTS RESERVED UNDER THE COPYRIGHT LAWS.

TITLE			
MH4 ARRESTER 336 KV RATED VOLTAGE			
SIZE	DWG NO.	CAT / PART / ASSY NO.	REV
S	19831494	MH4420BH336AA	2
DO NOT SCALE THIS DRAWING	DRN BY	DATE	SHEET
	NON	03/22/11	1 OF 1

