

**LINE TERMINAL DETAIL**

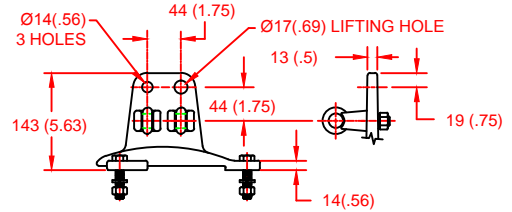

HDG 4-HOLE TERMINAL PAD, PART No. 901704001  
 TWO HDG TERMINALS, PART No. 2714143001  
 SUITABLE FOR COPPER OR ALUMINUM CONDUCTOR SIZE  
 Ø 7 (.25) - Ø 21 (.81)  
 25 - 240 sq mm  
 AWG#4 - 500 MCM

**GROUND TERMINAL DETAIL**

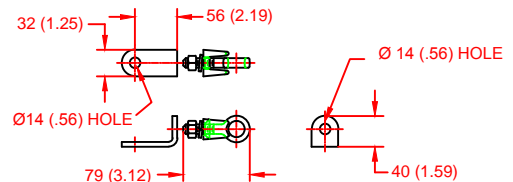

HDG TERMINAL BRACKET, PART No. 896064001  
 ONE HDG TERMINAL, PART No. 2714143001  
 SUITABLE FOR COPPER OR ALUMINUM CONDUCTOR SIZE  
 Ø 7 (.25) - Ø 21 (.81)  
 25 - 240 sq mm  
 AWG#4 - 500 MCM

Ø = DIAMETER  
 HDG = HOT DIP GALVANIZED

CHARACTERISTICS	
RATED VOLTAGE, Ur	312 kVrms
MCOV, Uc	249.6 kVrms
MASS	350kg (770lb)
CREEPAGE DISTANCE	8954 (352.5)
LIGHTNING IMP W/S	1459 kV
SWITCHING IMP W/S	1338 kV
POWER FREQ W/S	800 kVrms
TOV 1s	345 kVrms
TOV 10s	323 kVrms
SLL BENDING FORCE	1996 N (449lbf)
SSL BENDING FORCE	4990 N (1122lbf)
COG ABOVE BASE	1759 (69.3)
HOUSING	GREY PORCELAIN

- NOTES:  
 1. DIMENSIONS IN millimeters(inches) SUBJECT TO ±3% TOLERANCE  
 2. CLEARANCE AND INSULATION W/S VOLTAGE APPLY AT SEA LEVEL  
 3. ARRESTER SUITABLE FOR OPERATION AT ALTITUDES UP TO 2400m (7900ft)

RECOMMENDED CLEARANCE (TO METAL PARTS)	
PHASE TO GROUND	1465 (57.7)
PHASE TO PHASE	1670 (65.8)

RESIDUAL VOLTAGE (kV) FOR INDICATED IMPULSE TYPES AND CURRENT MAGNITUDES						
STEEP CURRENT IMPULSE	SWITCHING IMPULSE		8/20 LIGHTNING IMPULSE			
20 kA	0.5 kA	2 kA	5 kA	10 kA	20 kA	40 kA
948	608	645	697	732	784	863

IEC CLASS 4  
 SURGE ARRESTER

Program Revision  
 2018.12.3.03.25.15

REV DATE  
 12/03/15

CONFIDENTIAL: THIS DRAWING AND ITS CONTENTS ARE CONFIDENTIAL AND THE EXCLUSIVE PROPERTY OF HUBBELL POWER SYSTEMS. NO PUBLICATION, DISTRIBUTION OR COPIES MAY BE MADE WITHOUT THE WRITTEN CONSENT OF HUBBELL POWER SYSTEMS. HUBBELL POWER SYSTEMS UNPUBLISHED ALL RIGHTS RESERVED UNDER THE COPYRIGHT LAWS.

TITLE  
**MH4 ARRESTER  
 312 KV RATED VOLTAGE**

SIZE S	DWG NO. 19831497	CAT / PART / ASSY NO. MH4420GM312AA	REV 2
DO NOT SCALE THIS DRAWING	DRN BY NON	DATE 03/22/11	SHEET 1 OF 1



**HUBBELL POWER SYSTEMS**