

LINE TERMINAL DETAIL

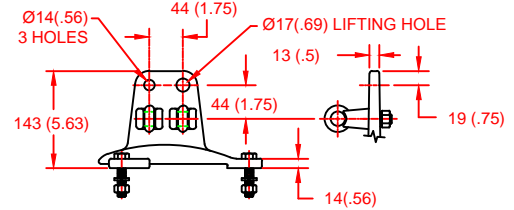

HDG 4-HOLE TERMINAL PAD, PART No. 901704001
 TWO HDG TERMINALS, PART No. 2714143001
 SUITABLE FOR COPPER OR ALUMINUM CONDUCTOR SIZE
 Ø 7 (.25) - Ø 21 (.81)
 25 - 240 sq mm
 AWG#4 - 500 MCM

GROUND TERMINAL DETAIL

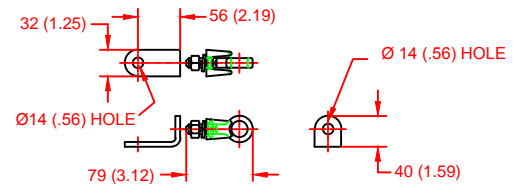

HDG TERMINAL BRACKET, PART No. 896064001
 ONE HDG TERMINAL, PART No. 2714143001
 SUITABLE FOR COPPER OR ALUMINUM CONDUCTOR SIZE
 Ø 7 (.25) - Ø 21 (.81)
 25 - 240 sq mm
 AWG#4 - 500 MCM

Ø = DIAMETER
 HDG = HOT DIP GALVANIZED

CHARACTERISTICS

RATED VOLTAGE, Ur	330 kVrms
MCOV, Uc	264 kVrms
MASS	354kg (778lb)
CREEPAGE DISTANCE	8954 (352.5)
LIGHTNING IMP W/S	1459 kV
SWITCHING IMP W/S	1338 kV
POWER FREQ W/S	800 kVrms
TOV 1s	365 kVrms
TOV 10s	342 kVrms
SLL BENDING FORCE	1996 N (449lbf)
SSL BENDING FORCE	4990 N (1122lbf)
COG ABOVE BASE	1754 (69.0)
HOUSING	GREY PORCELAIN

RECOMMENDED CLEARANCE (TO METAL PARTS)

PHASE TO GROUND	1554 (61.2)
PHASE TO PHASE	1770 (69.7)

- NOTES:
 1. DIMENSIONS IN millimeters(inches) SUBJECT TO ±3% TOLERANCE
 2. CLEARANCE AND INSULATION W/S VOLTAGE APPLY AT SEA LEVEL
 3. ARRESTER SUITABLE FOR OPERATION AT ALTITUDES UP TO 1950m (6400ft)

RESIDUAL VOLTAGE (kV) FOR INDICATED IMPULSE TYPES AND CURRENT MAGNITUDES

STEEP CURRENT IMPULSE	SWITCHING IMPULSE		8/20 LIGHTNING IMPULSE			
	0.5 kA	2 kA	5 kA	10 kA	20 kA	40 kA
20 kA	644	683	738	775	830	913
999						

IEC CLASS 4
 SURGE ARRESTER

Program Revision
 2018.12.3.03.25.15

REV DATE
 12/03/15

CONFIDENTIAL: THIS DRAWING AND ITS CONTENTS ARE CONFIDENTIAL AND THE EXCLUSIVE PROPERTY OF HUBBELL POWER SYSTEMS. NO PUBLICATION, DISTRIBUTION OR COPIES MAY BE MADE WITHOUT THE WRITTEN CONSENT OF HUBBELL POWER SYSTEMS. HUBBELL POWER SYSTEMS UNPUBLISHED ALL RIGHTS RESERVED UNDER THE COPYRIGHT LAWS.

TITLE
**MH4 ARRESTER
 330 KV RATED VOLTAGE**

SIZE	DWG NO.	CAT / PART / ASSY NO.	REV
S	19831498	MH4420GM330AA	2
DO NOT SCALE THIS DRAWING	DRN BY	DATE	SHEET
	NON	03/22/11	1 OF 1



HUBBELL POWER SYSTEMS