

LINE TERMINAL DETAIL

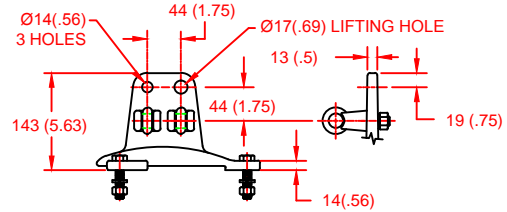

HDG 4-HOLE TERMINAL PAD, PART No. 901704001
 TWO HDG TERMINALS, PART No. 2714143001
 SUITABLE FOR COPPER OR ALUMINUM CONDUCTOR SIZE
 Ø 7 (.25) - Ø 21 (.81)
 25 - 240 sq mm
 AWG#4 - 500 MCM

GROUND TERMINAL DETAIL

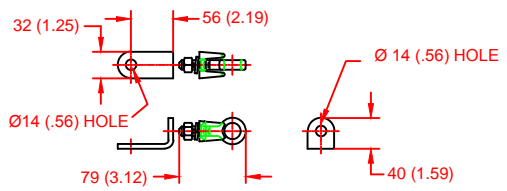

HDG TERMINAL BRACKET, PART No. 896064001
 ONE HDG TERMINAL, PART No. 2714143001
 SUITABLE FOR COPPER OR ALUMINUM CONDUCTOR SIZE
 Ø 7 (.25) - Ø 21 (.81)
 25 - 240 sq mm
 AWG#4 - 500 MCM

Ø = DIAMETER
 HDG = HOT DIP GALVANIZED

CHARACTERISTICS	
RATED VOLTAGE, Ur	444 kVrms
MCOV, Uc	355.2 kVrms
MASS	481kg (1058lb)
CREEPAGE DISTANCE	12828 (505.0)
LIGHTNING IMP W/S	2036 kV
SWITCHING IMP W/S	1872 kV
POWER FREQ W/S	1176 kVrms
TOV 1s	491 kVrms
TOV 10s	460 kVrms
SLL BENDING FORCE	1442 N (324lbf)
SSL BENDING FORCE	3606 N (811lbf)
COG ABOVE BASE	2435 (95.9)
HOUSING	BROWN PORCELAIN

RECOMMENDED CLEARANCE (TO METAL PARTS)	
PHASE TO GROUND	2101 (82.7)
PHASE TO PHASE	2389 (94.1)

- NOTES:
 1. DIMENSIONS IN millimeters(inches) SUBJECT TO ±3% TOLERANCE
 2. CLEARANCE AND INSULATION W/S VOLTAGE APPLY AT SEA LEVEL
 3. ARRESTER SUITABLE FOR OPERATION AT ALTITUDES UP TO 2250m (7300ft)

RESIDUAL VOLTAGE (kV) FOR INDICATED IMPULSE TYPES AND CURRENT MAGNITUDES						
STEEP CURRENT IMPULSE	SWITCHING IMPULSE		8/20 LIGHTNING IMPULSE			
20 kA	0.5 kA	2 kA	5 kA	10 kA	20 kA	40 kA
1346	865	919	992	1042	1115	1228

IEC CLASS 4
 SURGE ARRESTER

Program Revision
 2018.12.3.03.25.15
 REV DATE 12/03/15

CONFIDENTIAL: THIS DRAWING AND ITS CONTENTS ARE CONFIDENTIAL AND THE EXCLUSIVE PROPERTY OF HUBBELL POWER SYSTEMS. NO PUBLICATION, DISTRIBUTION OR COPIES MAY BE MADE WITHOUT THE WRITTEN CONSENT OF HUBBELL POWER SYSTEMS. HUBBELL POWER SYSTEMS UNPUBLISHED ALL RIGHTS RESERVED UNDER THE COPYRIGHT LAWS.

TITLE MH4 ARRESTER 444 KV RATED VOLTAGE			
SIZE S	DWG NO. 19831502	CAT / PART / ASSY NO. MH4550BM444AA	REV 2
DO NOT SCALE THIS DRAWING	DRN BY NON	DATE 03/22/11	SHEET 1 OF 1

