

CONNECTOR ONLY			CONNECTOR KIT			WIRE ACOMMODATES (EACH PORT)		INSTALLATION
ITEM NO	CATALOG NO	FIGURE	ITEM NO	KIT CATALOG NO	FIGURE	MIN WIRE	MAX WIRE	TOOLING (# CRIMPS)
50119042	YSMA1C4SL	1	50119043	YSMA1C4SLWC	2	6 AWG	1/0 AWG (COMPACT ONLY)	444S SERIES (1 CRIMP)

REV	DATE	DESCRIPTION	ECO	BY	C'H'K.
B	03/19/21	PART MARIKINGS UPDATED	210319006256	JL	GR

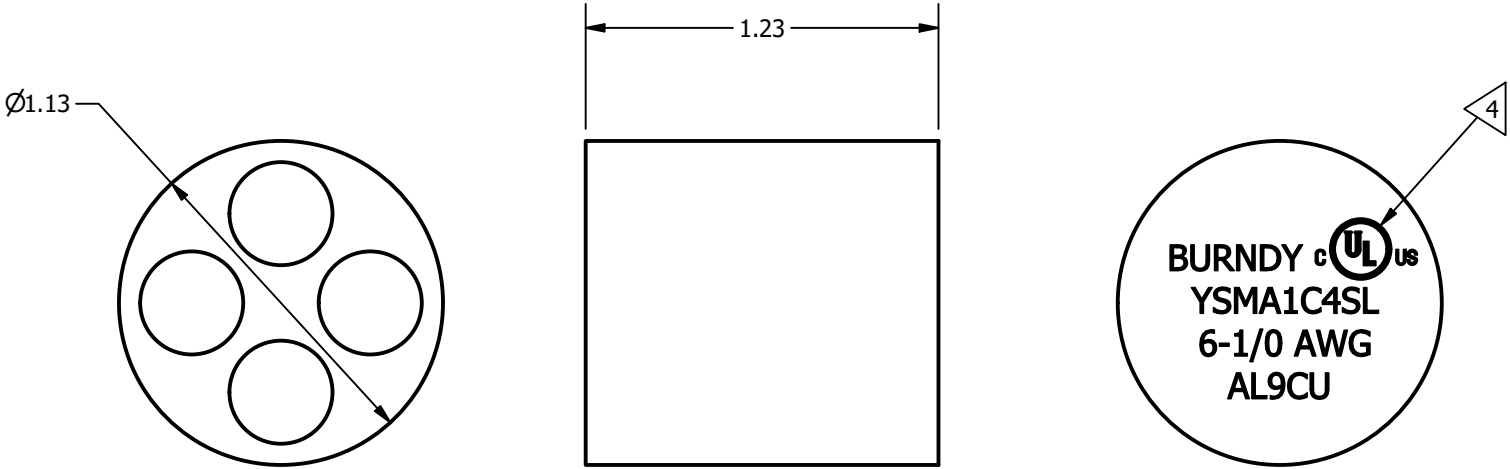

FIGURE 1

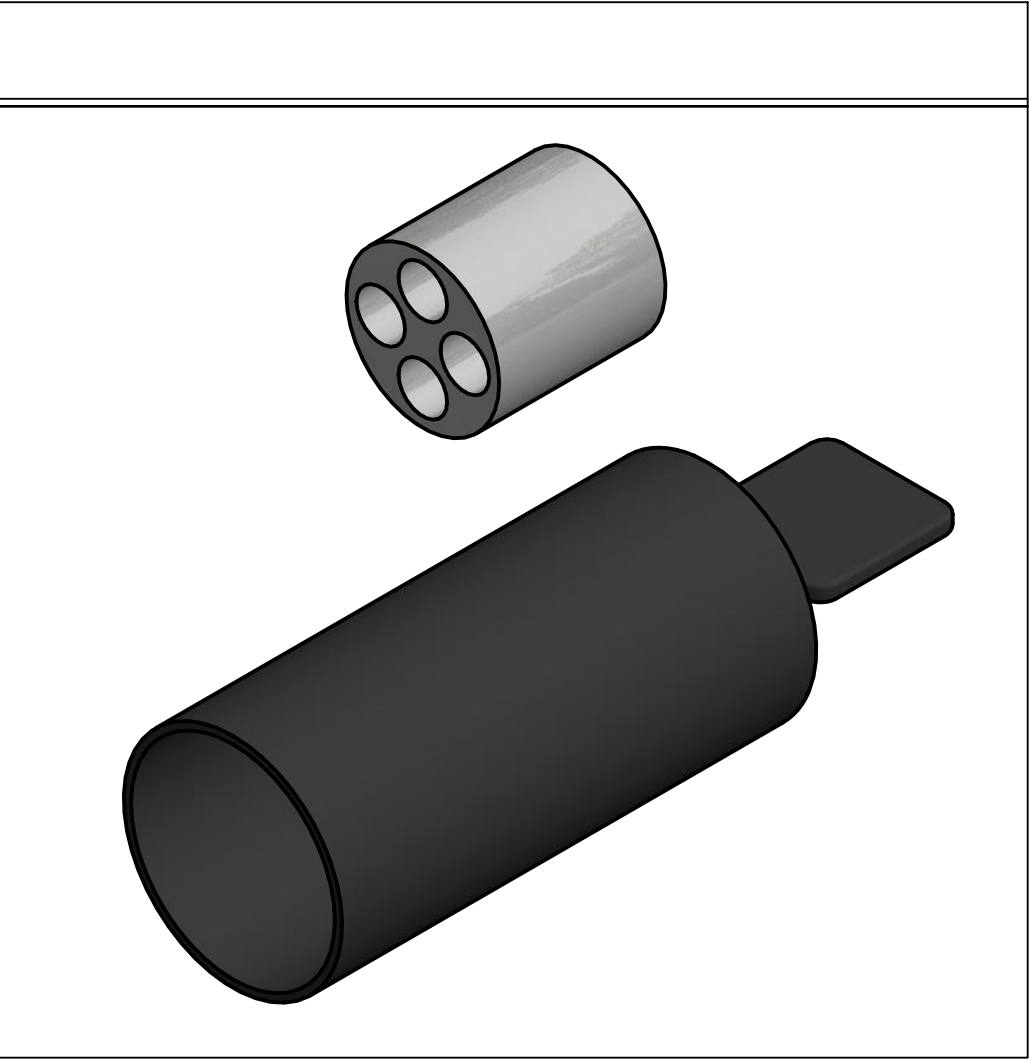

FIGURE 2

NOTES:

1. THIS DRAWING TO BE INTERPRETED PER ASME Y14.5M-2009.
2. BREAK ALL SHARP EDGES UNLESS OTHERWISE SPECIFIED.
- 3 CONNECTOR REQUIRES A MINIMUM OF 2 WIRES INSTALLED. CONNECTOR CAN BE INSTALLED WITH A MIN OF 2 #6 AWG, A MAXIMUM OF 4 1/0 COMPACT, AND ANY COMBINATION IN BETWEEN
- 4 LISTED FOR cULus PER UL486A-B, COPPER AND ALUMINUM. CONNECTORS ARE DUAL RATED TO ACCOMMODATE BOTH COPPER AND ALUMINUM WIRE AND ARE INDICATED WITH AL9CU
5. CONNECTOR MATERIAL: TIN PLATED ALUMINUM
- 6 WC SUFFIX INCLUDES CONNECTOR AND HEATSHRINK END CAP COVER PACKAGED TOGETHER IN POLYBAG

TO ORDER BURNDY® PRODUCTS CALL		STREETLIGHT CONNECTOR			
UNITED STATES 1-800-346-4175 (LONDONDERRY, NH) CANADA: 1-800-361-6975 (QUEBEC) 1-800-387-6487 (ALL OTHER PROVINCES) FOR PRODUCT INFO: http://www.burndy.com		ITEM NO: SEE TABLE			
		CAT. NO:SEE TABLE			
		DRAWN BY: gruggiero		2/3/2021	
		CHECKER: --			
		DSN APRVL: gruggiero		2/3/2021	
		MFG APRVL: B.MICHAUD		3/10/2021	
		QA APRVL: T.WATTS		3/10/2021	
		MKT APRVL: --			
		PROD FAM: --		DRAWING NO	
		PROJECT #: --		50119208	
DOCUMENT TYPE: SALES		SHEET 1 OF 1			
REL LEVEL: Released					
		B			