

CATALOG NUMBER	DESCRIPTION
HPWPWR	ASSY, 19" 10 OUT 15AMP POWER STRIP

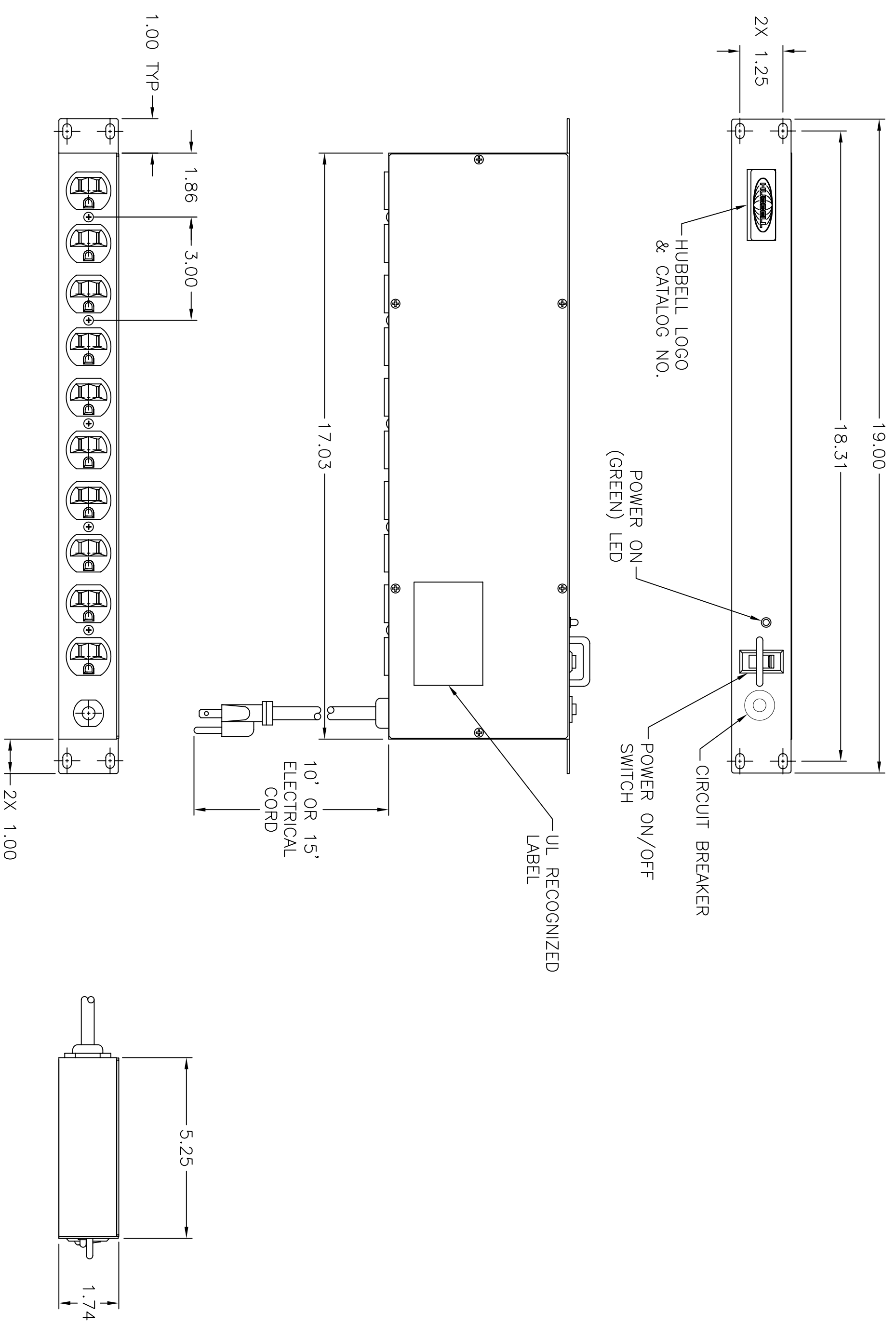
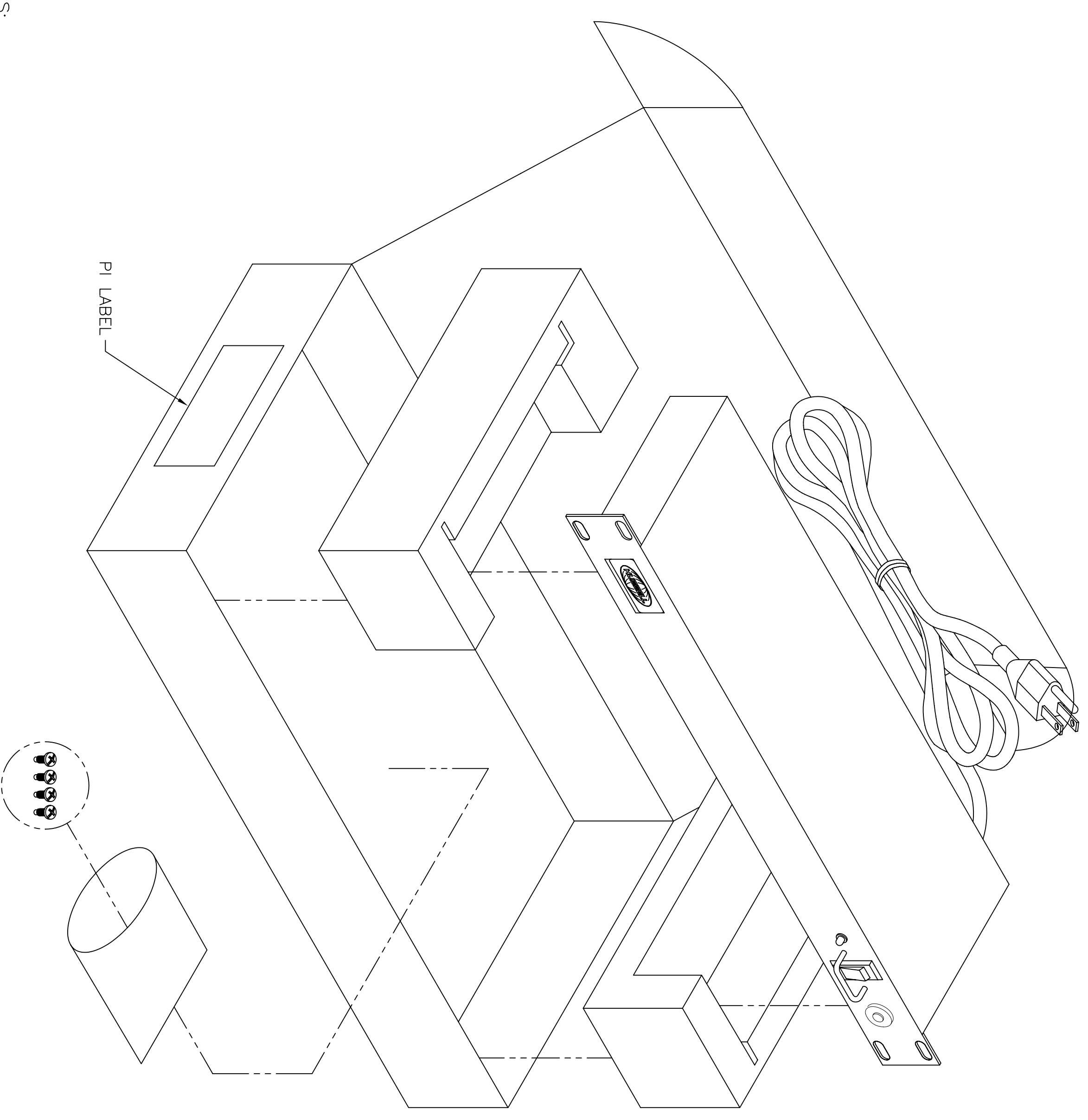

NOTES:

1. PARAMETER SPECIFICATIONS

OUTPUT RATING: 120VAC, 15 AMPS,
1800 WATTS 50/60HZ

RECEPTACLES: 5 - NEMA 5-15R DUPLEX

FEATURES:
- 10 OUTLETS - REAR
- 10' OR 15, 14/3 SJT POWER CORD
- POWER ON (GREEN) LED
- CIRCUIT BREAKER
- NON-SURGE

2. KIT SHOULD CONTAIN:
(1) POWER STRIP PER ABOVE SPECIFICATIONS,
(1) 77887001 HARDWARE KIT,
(1) 77836301 INSTRUCTION SHEET.

3. SURFACE FINISH:
DUPONT "BLACK WRINKLE" GFB 600 W3 OR
MARTIN "MIDNIGHT BLACK WRINKLE" 12-7001

REV.	EON	DATE
A	5445	10/08/04

DESCRIPTION	CHG BY	APPD BY
INITIAL RELEASE	GPE	MMA

Created on AUTOCAD	
DIMENSIONING AND TOLERANCE PER ANSI Y14.5M-2009 UNLESS OTHERWISE SPECIFIED. DIMENSIONS ARE IN INCHES (MM). TOLERANCES .XX = ±.01 (.25) .XXX = ±.005 (.127) XXXX = ±.0025 (.0635) ANGLE TOL. ±1°	
PROJECT REFERENCE:	MATERIAL:
DRAWN BY: GLEN P. EIG0, 10/8/04	CHECKED BY: MARJANA ABBY, 10/11/04
APPROVED BY: DAVE MCBAIN, 10/11/04	
TITLE: ASSY, 19" RACK POWER STRIP, 10 OUTLETS 15 AMPS, 120VAC, 50/60HZ, NON-SURGE	SCALE: N/A
SIZE: DRAWING NO. C10961	SHEET 1 OF 1

