

ITEM NO.	DESCRIPTION	QTY.
1	ADAPTER, SC TO ST DUPLEX (BLUE)	6
2	SCREW, ADAPTER	12
3	DUST CAP, ST	12
4	DUST CAP, SC	12

CATALOG NUMBER	SPLIT SLEEVE	DESCRIPTION
FASTSCMPB6	PHOS BRONZE	ST/SC DUPLEX ADAPTER

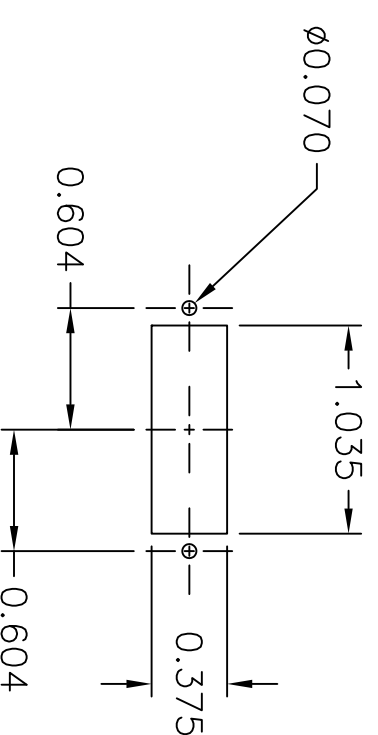
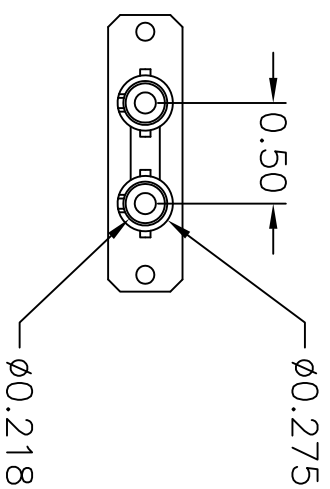
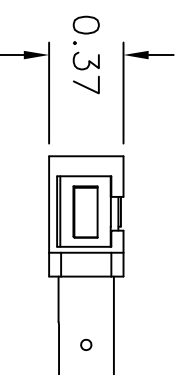
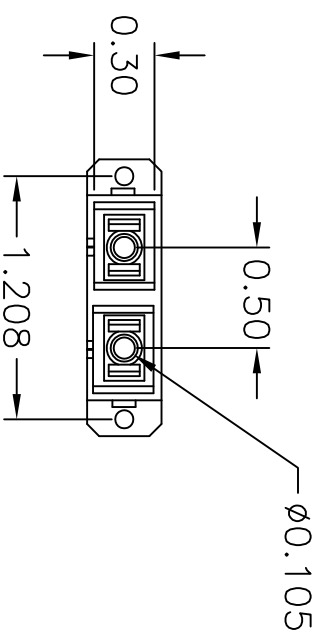
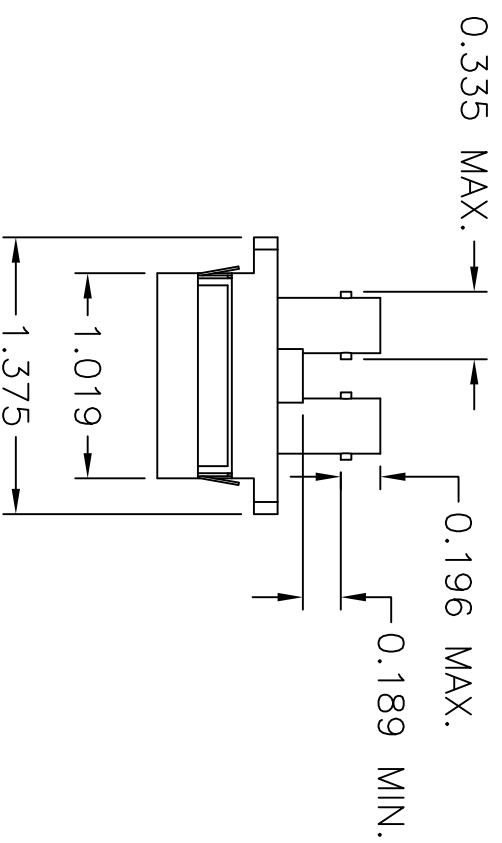
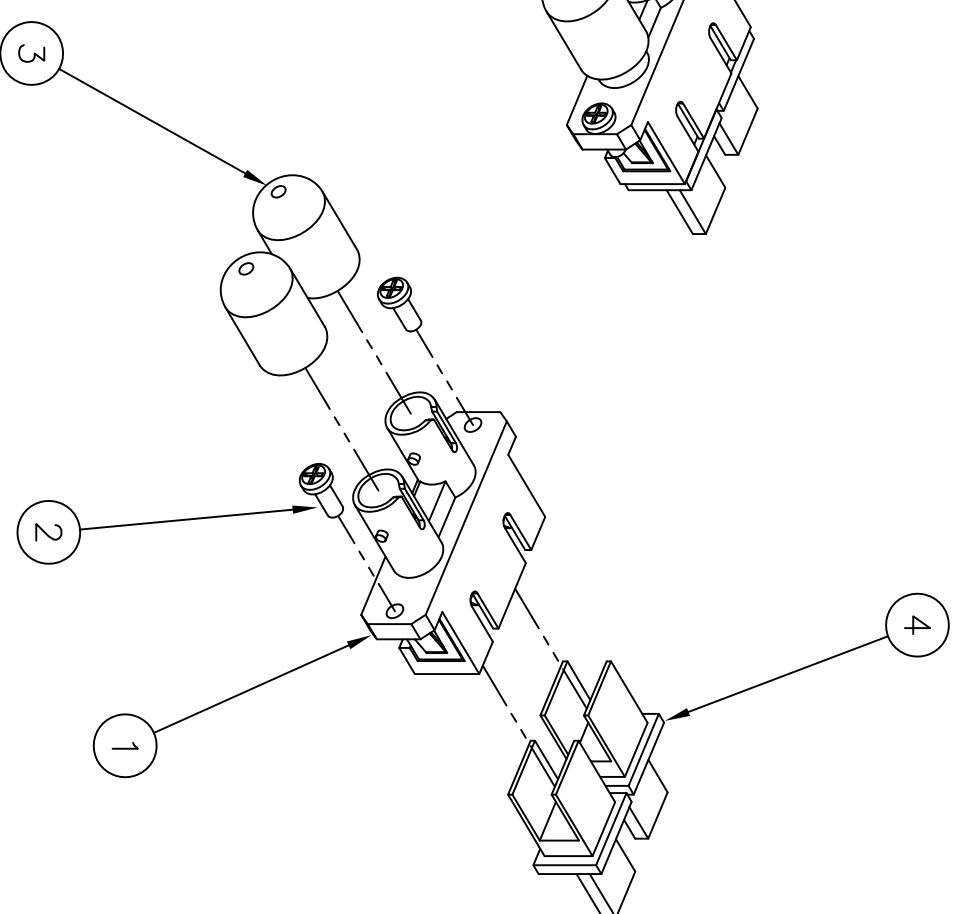
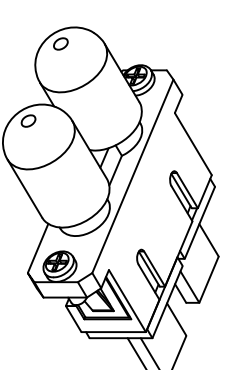
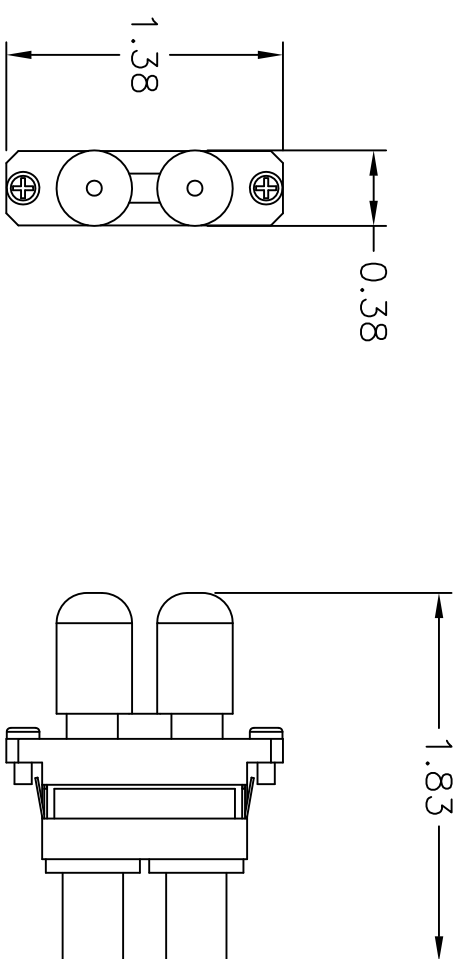

**RECOMMENDED
PANEL CUTOOUT**

NOTES:

- ADAPTERS SUPPLIED WITH (2) SCREWS AND DUST CAPS INSTALLED.
- ADAPTER MATERIAL IS UL-V0 ENGINEERING THERMOPLASTIC.
- CLIP MATERIAL IS STAINLESS STEEL.
- ALIGNMENT SLEEVE MATERIAL - SEE TABLE. ZIRCONIA COMPATIBLE WITH BOTH SINGLEMODE AND MULTIMODE FIBER. PHOSPHOR BRONZE COMPATIBLE WITH MULTIMODE FIBER ONLY.
- SPECIFICATIONS SUBJECT TO CHANGE WITHOUT NOTICE.

REV.	ECN	DATE	DESCRIPTION	CHG BY	APPD BY
B	17038	3/15/11	ADDED SPLIT SLEEVE TYPE, UPDATED NOTE #4	CG	

Created on AUTOCAD

DIMENSIONING AND TOLERANCE PER
ANSI Y14.5M-1982
UNLESS OTHERWISE SPECIFIED,
DIMENSIONS ARE IN INCHES (MM).
TOLERANCES
.XX = ±.01 (.25)
.XXX = ±.005 (.127)
.XXXX = ±.0025 (.0635)
ANGLE TOL. ±1°

IN ACCEPTING OUR DRAWINGS,
BLUEPRINTS, OR SUPPORTING
DOCUMENTATION FOR QUOTATION
OR OTHER PURPOSES, YOU AGREE
NOT TO DISCLOSE TO OTHERS
THE IDEAS, INFORMATION, OR
DESIGNS SHOWN HEREIN, AND
THAT YOU WILL MAKE NO USE
OF SAME WITHOUT PERMISSION

PROJECT REFERENCE:
MATERIAL:
DRAWN BY:
PAUL S. MAGUIRE 05/10/02
CHECKED BY:
JOHN LUTZEN 05/22/02
APPROVED BY:
JOHN LUTZEN 05/22/02

HUBBELL

Hubbell Premise Wiring
HUBBELL INCORPORATED (Delaware)
14 Lord's Hill Road, Stonington, Connecticut 06378

FIBER OPTIC PRODUCTS
ADAPTER, SC TO ST DUPLEX

TITLE:
FIBER OPTIC PRODUCTS
ADAPTER, SC TO ST DUPLEX

SIZE: C
DRAWING NO.: 11184C
SCALE: 1/1
SHEET 1 OF 1

REV. B