

6

5

4

3

2

1

CATALOG NO.

HPWRRRA

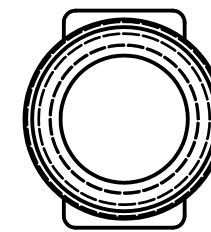
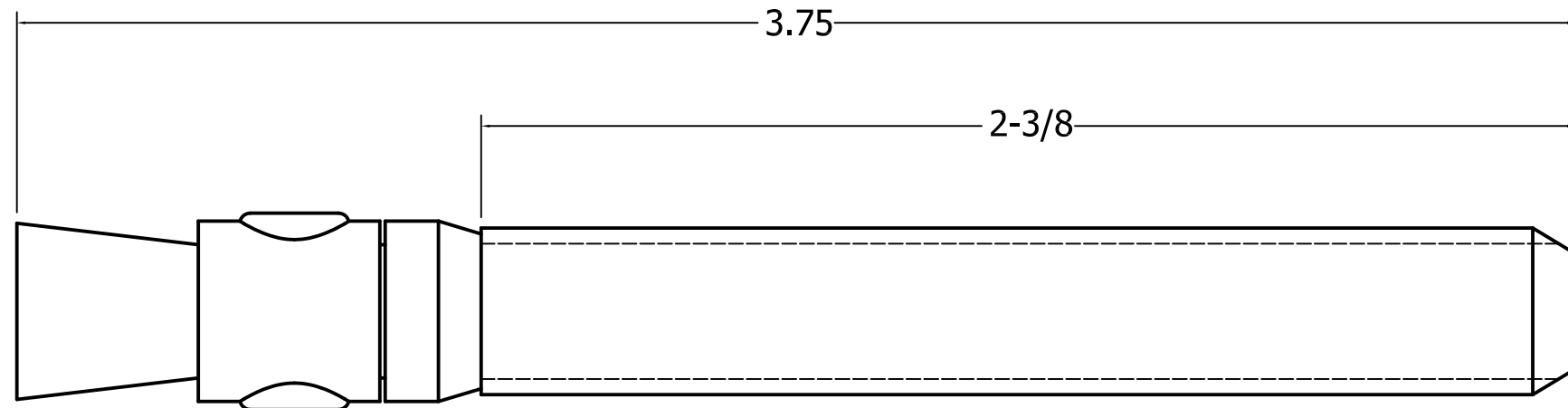

NOTES:

1. HPWRRRA ANCHOR KIT INCLUDES:

- (4) 3/8"-16 X 3.75" WEDGE STYLE CEMENT ANCHOR BOLT
- (4) 3/8"-16 HEX NUT
- (4) 3/8" WASHER

2. FOR SECURING RELAY RACKS TO A CEMENT FLOOR.

3. SPECIFICATIONS SUBJECT TO CHANGE WITHOUT PRIOR NOTICE.

DIMENSIONING AND TOLERANCE PER
ANSI Y14.5M-1982
UNLESS OTHERWISE SPECIFIED,
DIMENSIONS ARE IN INCHES (MM).
TOLERANCES
.XX = ±.01 (.25)
.XXX = ±.005 (.127)
.XXXX = ±.0025 (.0635)
ANGLE TOL ±1°

PROJECT REFERENCE:
043-13

MATERIAL:
SEE NOTES

DRAWN BY:
JRUOTJACKSON 7/26/16 / D.O'CONNOR

CHECKED BY:

APPROVED BY:



Hubbell Premise Wiring
HUBBELL INCORPORATED (Delaware)
23 Clara Drive, Mystic, Connecticut 06355

TITLE: WEDGE STYLE CONCRETE ANCHOR KIT

SIZE C	DRAWING NO. HWS14533C	REV. 1
------------------	---------------------------------	------------------

SCALE: NTS SHEET 1 OF 1

Created on AUTOCAD

IN ACCEPTING OUR DRAWINGS,
BLUEPRINTS, OR SUPPORTING
DOCUMENTATION FOR QUOTATION
OR OTHER PURPOSES, YOU AGREE
NOT TO DISCLOSE TO OTHERS
THE IDEAS, INFORMATION, OR
DESIGNS SHOWN HEREIN, AND
THAT YOU WILL MAKE NO USE
OF SAME WITHOUT PERMISSION

1	21405	07/26/16	INITIAL RELEASE.	JJRJ	MMA
REV.	ECN	DATE	DESCRIPTION	CHG BY	APPD BY