

ITEM NO.	DESCRIPTION	QTY.
1	ADAPTER, LC QUAD	1
2	SCREW, ADAPTER	2
3	DUST CAP, LC	8

CATALOG NUMBER	HOUSING COLOR	DESCRIPTION	SLEEVE MATERIAL
FANLCQSS6BE	BEIGE	LC QUAD SCREW MOUNT ADAPTER, PK	ZIRCONIA
FANLCQSS6B	BLUE	LC QUAD SCREW MOUNT ADAPTER, PK	ZIRCONIA
FANLCQSS6OR	ORANGE	LC QUAD SCREW MOUNT ADAPTER, PK	ZIRCONIA
FANLCQSS6BK	BLACK	LC QUAD SCREW MOUNT ADAPTER, PK	ZIRCONIA
FANLCQSS6R	RED	LC QUAD SCREW MOUNT ADAPTER, PK	ZIRCONIA
FANLCQSS6AQ	AQUA	LC QUAD SCREW MOUNT ADAPTER, PK	ZIRCONIA
FANLCQSS6Y	YELLOW	LC QUAD SCREW MOUNT ADAPTER, PK	ZIRCONIA
FANLCQSS6GN	GREEN	LC QUAD SCREW MOUNT ADAPTER, PK	ZIRCONIA

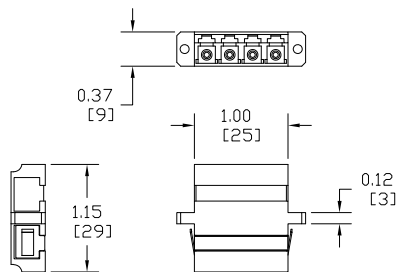

**LC QUAD ADAPTER**

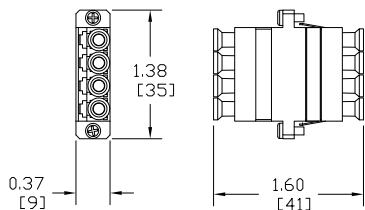
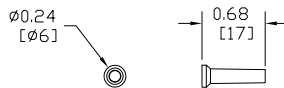

**ADAPTER DUST CAP**

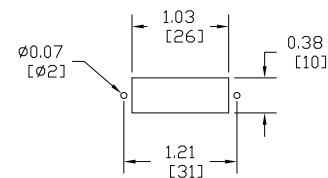
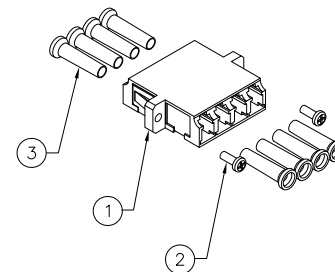

**RECOMMENDED  
PANEL CUTOUT**

**NOTES:**

- ADAPTERS SUPPLIED WITH (2) SCREWS AND DUST CAPS INSTALLED.
- ADAPTER MATERIAL IS UL-V0 ENGINEERING THERMOPLASTIC.
- CLIP MATERIAL IS STAINLESS STEEL.
- ZIRCONIA ALIGNMENT SLEEVES SUITABLE FOR BOTH SINGLEMODE AND MULTIMODE APPLICATIONS.
- SPECIFICATIONS SUBJECT TO CHANGE WITHOUT NOTICE.

REV.	ECN	DATE	DESCRIPTION	CHG BY	APPD BY
1	210202004508	2/1/21	INITIAL RELEASE	DPO	MMA

Created on AUTOCAD

**DIMENSIONING AND TOLERANCE PER ANSI Y14.5M-1982 UNLESS OTHERWISE SPECIFIED, DIMENSIONS ARE IN INCHES (MM). TOLERANCES**  
 .XX = ±.01 (.25)  
 .XXX = ±.005 (.127)  
 .XXXX = ±.0025 (.0635)  
 ANGLE TOL ±1°

**IN ACCEPTING OUR DRAWINGS, BLUEPRINTS, OR SUPPORTING DOCUMENTATION FOR QUOTATION OR OTHER PURPOSES, YOU AGREE NOT TO DISCLOSE TO OTHERS THE IDEAS, INFORMATION, OR DESIGNS SHOWN HEREIN, AND THAT YOU WILL MAKE NO USE OF SAME WITHOUT PERMISSION**

**PROJECT REFERENCE:**  
NPD-03368

**MATERIAL:**  
SEE NOTES

**DRAWN BY:**  
D.O'CONNOR 2/1/21

**CHECKED BY:**

**APPROVED BY:**

**HUBBELL** Hubbell Premise Wiring  
HUBBELL INCORPORATED (Delaware)  
23 Clara Drive, Mystic Connecticut 06355

**TITLE:**  
FIBER OPTIC PRODUCTS  
LC QUAD ADAPTER

**SIZE:** C **DRAWING NO.:** HWS14997C **REV.:** 1

**SCALE:** **SHEET 1 OF 1**