

ITEM NO.	DESCRIPTION	QTY.
1	4-40 THREADED STUD/NUT	2
2	15-PIN D-SUB, FEMALE SCREW TERMINAL	1

CATALOG NUMBER	DESCRIPTION
15ST10	15-PIN D-SUB, FEMALE SCREW TERMINAL

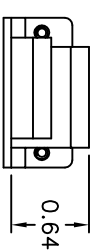

PIN OUT DETAIL

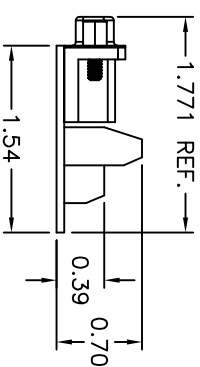
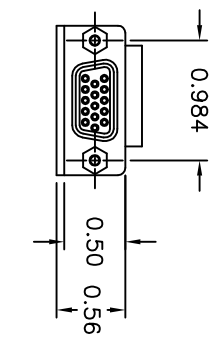
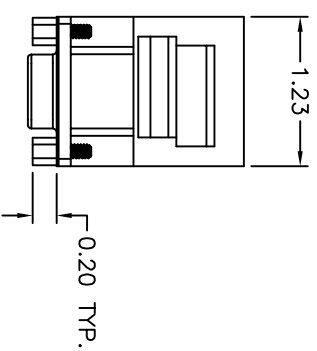
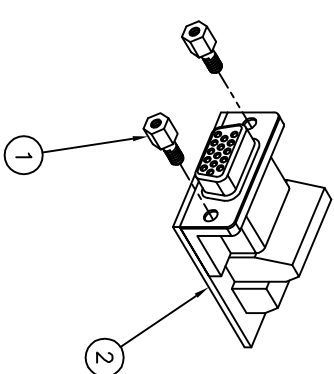
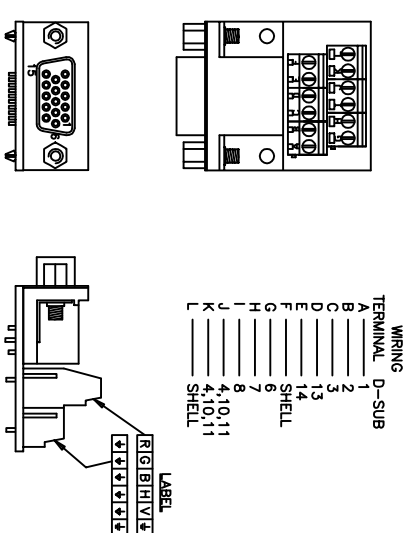

NOTES  
UNLESS OTHERWISE SPECIFIED:

- SOLD IN CARTON INCREMENTS ONLY. CARTON CONTAINS 10 MODULES (INDIVIDUALLY BAGGED).
- CATALOG NUMBER DENOTES THE NUMBER OF PINS IN D-SUB AND CARTON INCREMENTS.
- HIGH DENSITY STYLE D-SUB FOOTPRINT.
- SPECIFICATIONS SUBJECT TO CHANGE WITHOUT NOTICE.

A		5790		1/16/06		WAS P/N 773695C		DPO		CHG BY		APPD BY	
REV.		ECN		DATE		DESCRIPTION							
Created on AUTOCAD													
<p>DIMENSIONING AND TOLERANCE PER ANSI Y14.5M-1982 UNLESS OTHERWISE SPECIFIED, DIMENSIONS ARE IN INCHES (MM). TOLERANCES .XX = ±.01 (.25) .XXX = ±.005 (.127) .XXXX = ±.0025 (.0635) ANGLE TOL. ±1°</p> <p>IN ACCEPTING OUR DRAWINGS, BLUEPRINTS, OR SUPPORTING DOCUMENTATION FOR QUOTATION OR OTHER PURPOSES, YOU AGREE NOT TO DISCLOSE TO OTHERS THE IDEAS, INFORMATION, OR DESIGNS SHOWN HEREIN, AND THAT YOU WILL MAKE NO USE OF SAME WITHOUT PERMISSION</p>													
PROJECT REFERENCE:				DRAWN BY:				TITLE:					
MATERIAL:				PAUL S. MAGUIRE 11/01/02				<p><b>Hubbell Premise Wiring</b> HUBBELL INCORPORATED (Delaware) 14 Lord's Hill Road, Stonington, Connecticut 06378</p>					
CHECKED BY:				GLINN KIERSTAD 11/06/02				<p>JACKS/CONNECTORS</p> <p>MULTIMEDIA MODULES AND CONNECTORS</p> <p>15-PIN D-SUB, FEMALE SCREW TERMINAL</p>					
APPROVED BY:				GLINN KIERSTAD 11/06/02				<p>SIZE: C</p> <p>DRAWING NO. CHWST74389</p>					
SCALE:				1/1				<p>SHEET 1 OF 1</p> <p>REV. A</p>					