

REVISIONS			
REV.	DATE	DESCRIPTION	BY
-	04-28-15	INITIAL RELEASE OF DRAWING	K.K.
1	10-27-20	UPDATED CM BRACKET	RMV

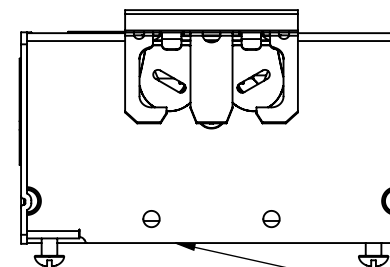

INSTALLED

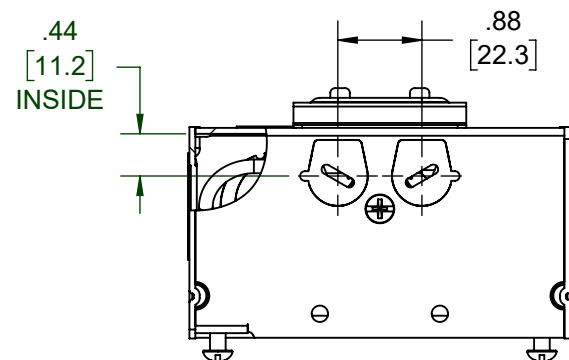
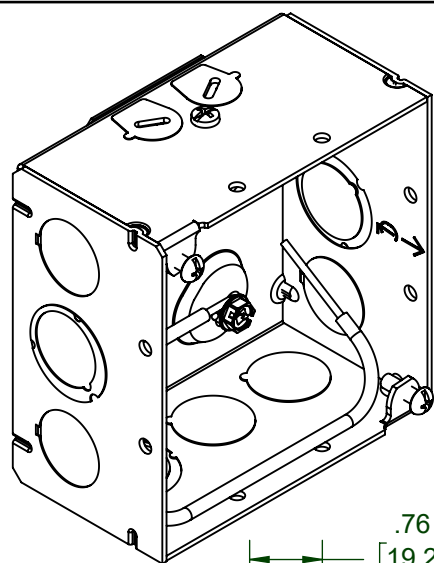
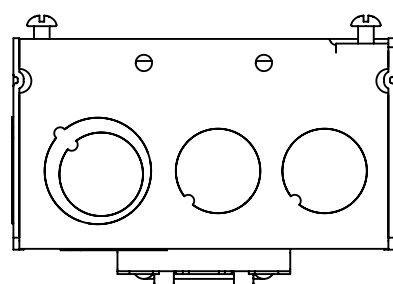
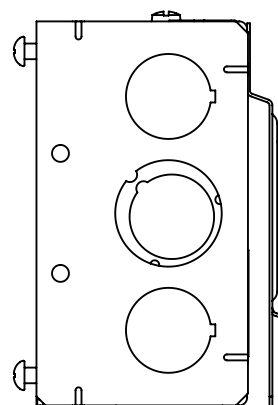
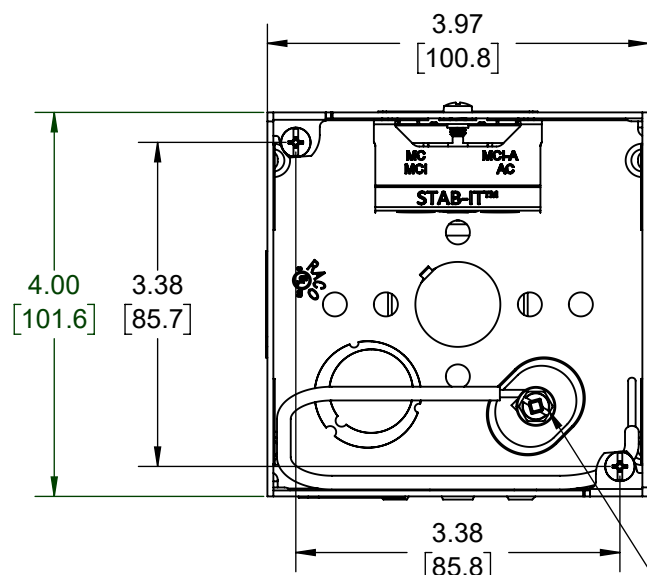
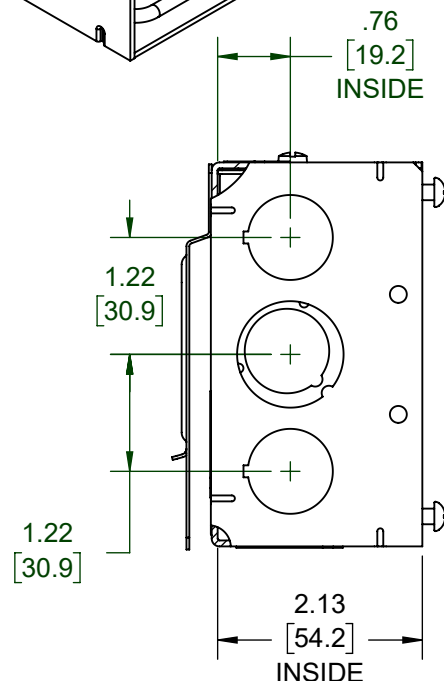
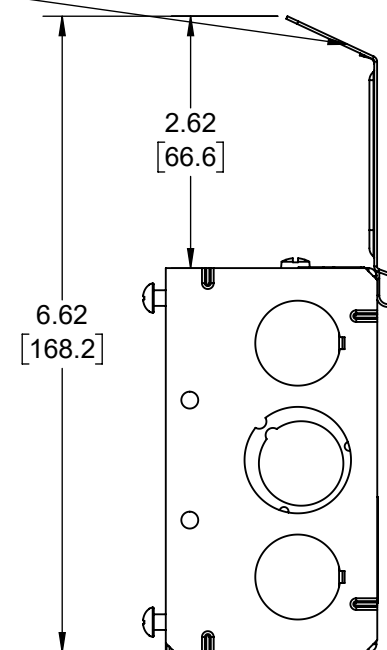
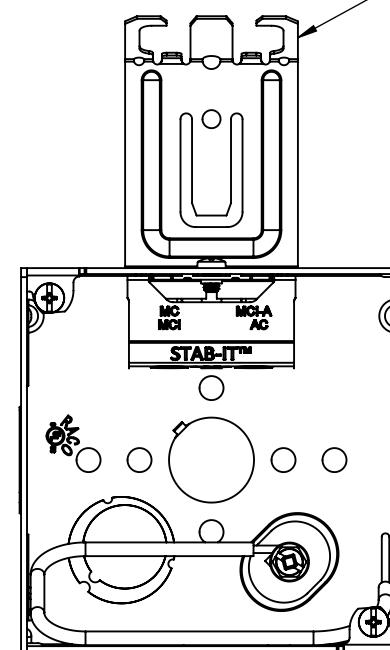

PIGTAIL:
WIRE: #12 AWG SOLID, 8-1/2" LONG, GREEN TW
INSULATED, U.L. LISTED, 600 VOLT MAX,
STRIPPED 1" IN FROM EACH END;
#10-32 X 3/8" GROUND SCREW W/COMBO HEX
WASHER HEAD (SLOTTED, #2 PHILLIPS AND
ROBERTSON)

- NOTES:
1. ALL DIMENSIONS ARE IN INCHES AND [MILLIMETERS]
2. BOX VOLUME: 30.3 IN³ [496.5 CM³]
3. cULus LISTED

NOTE:
FOR INSTRUCTION SHEET,
SEE NEXT SHEET

KNOCKOUTS	
TRADE SIZE	LOCATION
1/2" KO	1- ON THE BOTTOM, 2-ON EACH SIDE, 2 -ON THE SIDE OF THE SPACER
1/2", 3/4" TKO®	1- ON THE BOTTOM, 1-ON EACH SIDE, 1 -ON THE SIDE OF THE SPACER
CABLE PRIOUTS	2- ON THE SIDE OF THE SPACER

CABLE TYPES AND RANGES FOR STAB-IT CLAMP	
CABLE TYPES	CABLE RANGES
AC STEEL & ALUMINIUM	14-2,14-3,14-4,12-2,12-3,12-4,10-2,10-3
HCF AC STEEL	14-2,14-3,14-4,12-2,12-3,10-2,10-3
HCF AC ALMINUM	12-2,12-3,12-4,10-2,10-3
MC STEEL & ALUMINIUM	14-2,14-3,14-4,12-2,12-3,12-4,10-2,10-3
MCI-A STEEL & ALUMINIUM	14-2,14-3,14-4,12-2,12-3,12-4,10-2,10-3
HCF MCI-A STEEL	12-2,12-3,10-2
HCF MCI-A ALUMINIUM	14-2,14-3,14-4,12-2,12-3,12-4,10-2,10-3
3/8 TRADE SIZE FLEX,REFM C CONDUIT STEEL & ALUMINIUM. ANTI SHORT BUSHING REQUIRED	
CABLE RANGE .400" DIA. MIN TO .605" DIA. MAX	

DESCRIPTION	MATERIAL	FINISH
CABLE MANAGEMENT	STEEL	GALVANIZED
PIG TAIL	COPPER	SEE NOTE
STAB-IT® CLAMP	STEEL	GALVANIZED
FASTENERS	STEEL	GALVANIZED
SIDE	STEEL	GALVANIZED
SPACER	STEEL	GALVANIZED

LIST OF PARTS
THE DESIGN AND DIMENSIONS OF THE
PRODUCT SHOWN ON THIS DRAWING ARE
SUBJECT TO CHANGE WITHOUT NOTICE

TITLE:
**4" SQ. 2-1/8" DEEP WELDED BOX
WITH STAB-IT® BX/MC CABLE CLAMP
AND CABLE MANAGMENT**

TOLERANCE UNLESS OTHERWISE SPECIFIED			DRAWN BY: K.K.	SCALE: 1:2
.XX DECIMAL ±.015 .XXX DECIMAL ±.005 ANGLE ±2°			APP. BY: N.S.	DATE: 04-28-15

Instructions For Using the RACO® Cable Support Bracket with STAB-IT® Boxes

Step 1. Install box to stud.

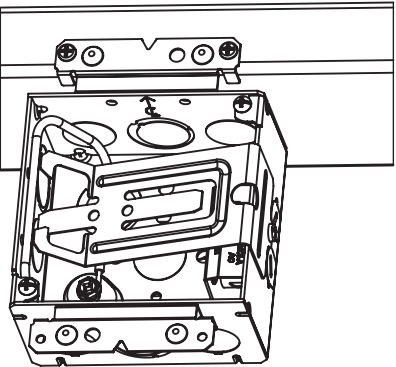

Step 2. Remove Pry-Out(s).

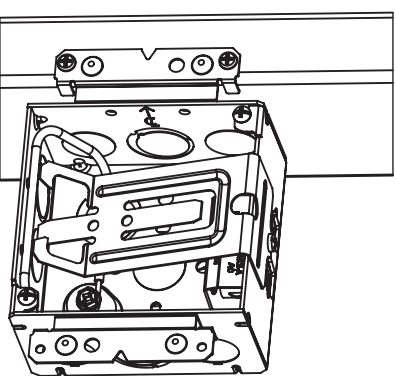

Step 3. Pre-bend Cable Support Bracket
as shown and install cables.

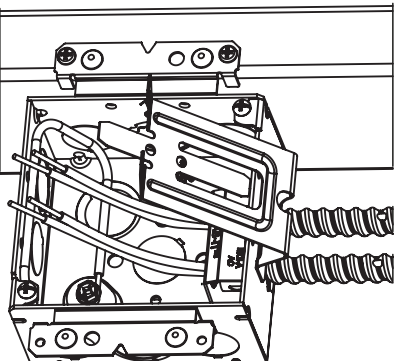

Step 4. Bend Cable Support
Bracket as shown.

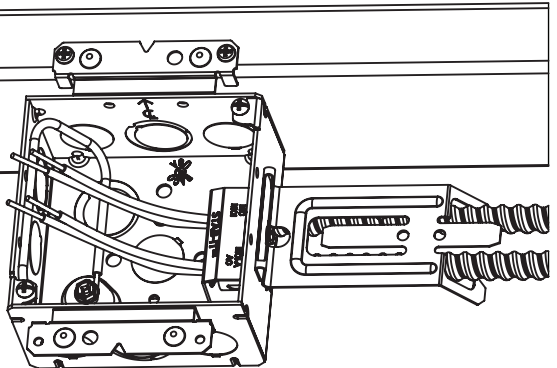

Step 5. Bend down two center tabs
to lock cables as shown.

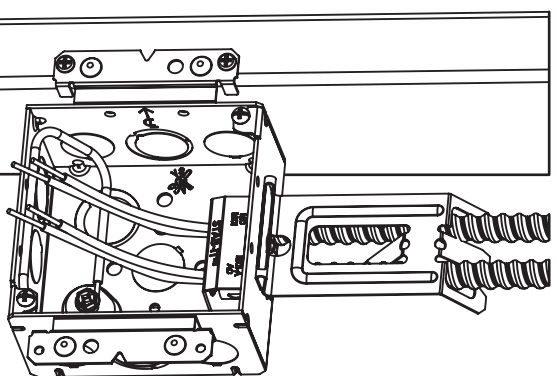

Hubbell Electrical Products
Hubbell Incorporated (Delaware)

RACO INC.

3902 W. Sample St. P.O. Box 4002 South Bend, IN 46634
Phone: (574) 234-7151 FAX (574) 283-4244

MADE IN CHINA

RA-Inst 345
119088