

CAT. #	SIZE	A	B	C	D	E	F	G	H	J	K	L	M
2902	1/2"	1.84 [46.7]	1.01 [25.7]	1.03 [26.2]	1.13 [28.6]	1.08 [27.5]	0.72 [18.4]	0.69 [17.4]	0.81 [20.7]	0.64 [16.3]	0.84 [21.5]	0.858-14 UNS	1/2-14 NPSM
2903	3/4"	1.94 [49.1]	1.25 [31.7]	1.29 [32.7]	1.40 [35.1]	1.37 [34.8]	0.94 [23.9]	0.92 [23.3]	1.01 [25.7]	0.80 [20.2]	1.07 [27.3]	1.087-14 UNS	3/4-14 NPSM
2904	1"	2.12 [53.8]	1.50 [38.0]	1.54 [39.0]	1.70 [43.3]	1.63 [41.5]	1.18 [29.9]	1.16 [29.6]	1.26 [32.0]	1.02 [25.9]	1.32 [33.4]	1.331-18 UNS	1-11.5 NPSM
2905	1-1/4"	2.54 [64.4]	1.86 [47.2]	1.89 [48.0]	2.07 [53.4]	2.03 [51.4]	1.54 [39.0]	1.55 [39.3]	1.60 [40.7]	1.35 [34.3]	1.71 [43.4]	1.701-14 UNS	1 1/4-11.5 NPSM
2906	1-1/2"	2.91 [73.9]	2.16 [54.9]	2.14 [54.3]	2.36 [60.2]	2.26 [57.5]	1.76 [44.8]	1.79 [45.3]	1.85 [46.9]	1.59 [40.4]	1.94 [49.4]	1.933-14 UNS	1 1/2-11.5 NPSM
2908	2"	3.20 [81.3]	2.60 [65.9]	2.64 [67.1]	2.85 [73.0]	2.77 [70.3]	2.23 [56.6]	2.25 [57.0]	2.33 [59.1]	2.02 [51.3]	2.42 [61.5]	2.398-14 UNS	2-11.5 NPSM
2940	2-1/2"	3.99 [101.4]	3.37 [85.5]	3.43 [87.1]	3.43 [87.0]	3.60 [91.4]	2.92 [74.2]	2.92 [74.2]	2.82 [71.5]	2.43 [61.6]	3.16 [80.3]	3.142-11.5 UNS	2 1/2-8 NPSM
2942	3"	4.45 [113.1]	4.06 [103.1]	4.05 [102.9]	4.11 [104.4]	4.28 [108.8]	3.54 [90.0]	3.55 [90.2]	3.44 [87.3]	3.01 [76.5]	3.80 [96.5]	3.776-11.5 UNS	3-8 NPSM
2944	3-1/2"	4.65 [118.2]	4.56 [115.8]	4.57 [116.0]	4.70 [119.4]	4.77 [121.2]	4.06 [103.0]	4.05 [102.8]	3.94 [100.0]	3.48 [88.4]	4.29 [108.9]	4.276-11.5 UNS	3 1/2-8 NPSM
2946	4"	4.82 [122.5]	5.05 [128.4]	5.05 [128.1]	5.27 [133.8]	5.27 [133.9]	4.54 [115.3]	4.60 [116.8]	4.44 [112.7]	3.97 [100.7]	4.78 [121.4]	4.776-11.5 UNS	4-8 NPSM

TIGHTENING TORQUE			
(SEE CLAUSES 6.2.1 8.17.2.1 8.27.2.1, 8.28.2.2, and 8.28.2.5.)			
TRADE SIZE OF FITTING	METRIC DESIGNATOR	TIGHTENING TORQUE	
		N-m	(lbf-in)
1/4a	10	19.8	175
3/8	12	22.6b	200
1/2	16	33.9	300
3/4	21	56.5	500
1	27	79.1	700
1-1/4	35	113	1000
1-1/2	41	136	1200
2	53	181	1600
2-1/2	63	181	1600
3	78	181	1600
3-1/2	91	181	1600
4	103	181	1600

a APPLIES TO FLEXIBLE CORD FITTINGS ONLY

b A 3/8 (12) TRADE-SIZE FITTING FOR USE WITH LIQUID-TIGHT FLEXIBLE METAL CONDUIT SHALL BE TIGHTENED WITH A TORQUE OF 26.5 N-M (235 LBF-IN).

REVISIONS			
REV.	DATE	DESCRIPTION	BY:
-	07-29-21	INITIAL RELEASE OF DRAWING	MS

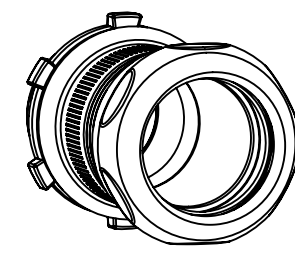

ISOMETRIC VIEW

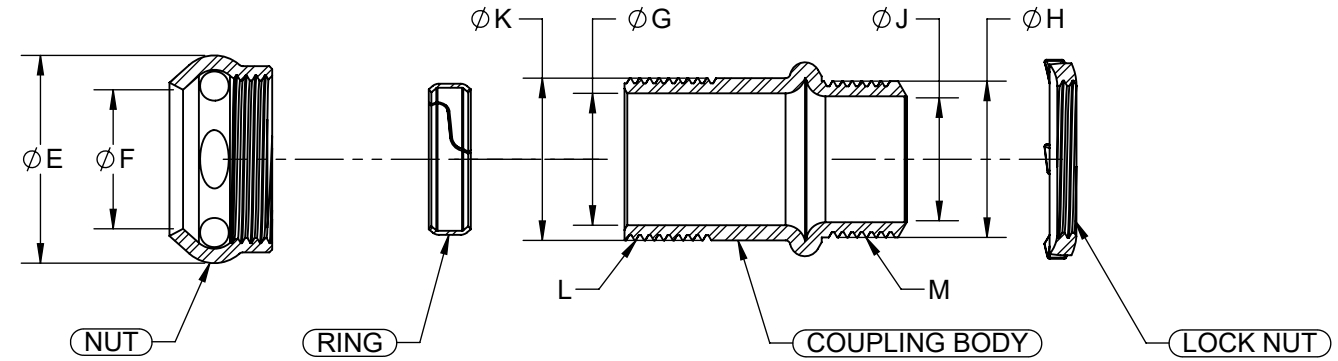
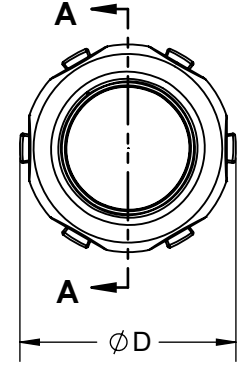
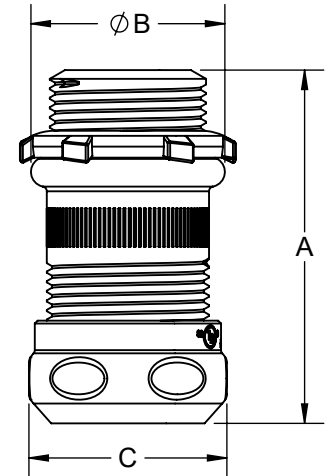

SECTION A-A

- NOTES:**
- ALL DIMENSIONS ARE IN INCHES AND [MILLIMETERS].
 - LOCKNUT SHALL BE HAND-TIGHTENED AND THEN FURTHER TIGHTENED 1/4 TURN WITH A HAMMER AND A FLAT BLADED SCREWDRIVER OR BY AN EQUIVALENT METHOD.
 - cULus LISTED.

DESCRIPTION	MATERIAL	FINISH
LOCK NUT	STEEL	ZINC
RING	STEEL	ZINC
COMPRESSION NUT	STEEL	ZINC
COUPLING BODY	STEEL	ZINC

LIST OF PARTS

THE DESIGN AND DIMENSIONS OF THE PRODUCT SHOWN ON THIS DRAWING ARE SUBJECT TO CHANGE WITHOUT NOTICE

TITLE:
COMPRESSION CONNECTOR-STEEL UNINSULATED CUS

TOLERANCE UNLESS OTHERWISE SPECIFIED	RACO	
.XX DECIMAL ±.015	DRAWN BY: MS	SCALE: SIZE:
.XXX DECIMAL ±.005	APP. BY: N.S.	1:1
ANGLE ±2°	DATE: 07-29-21	