

NOTES:

1 MATERIAL: ELECTROLYTIC COPPER, ALLOY TYPE 110 ETP, ASTM B187. $\text{\textcircled{A}}$

REVISIONS					
ZONE	REV.	DESCRIPTION	DRAWN BY	DATE	APPR.
A3 F4 E2	A	THE TOLERANCE TABLE CHANGE FOR HIGHER PRECISION. ADD THE NOTE #1: MATERIAL THE $\text{\textcircled{A}}$ HOLE MOVE OF .010"	J. CLICHE	2014-10-29	Y.V.

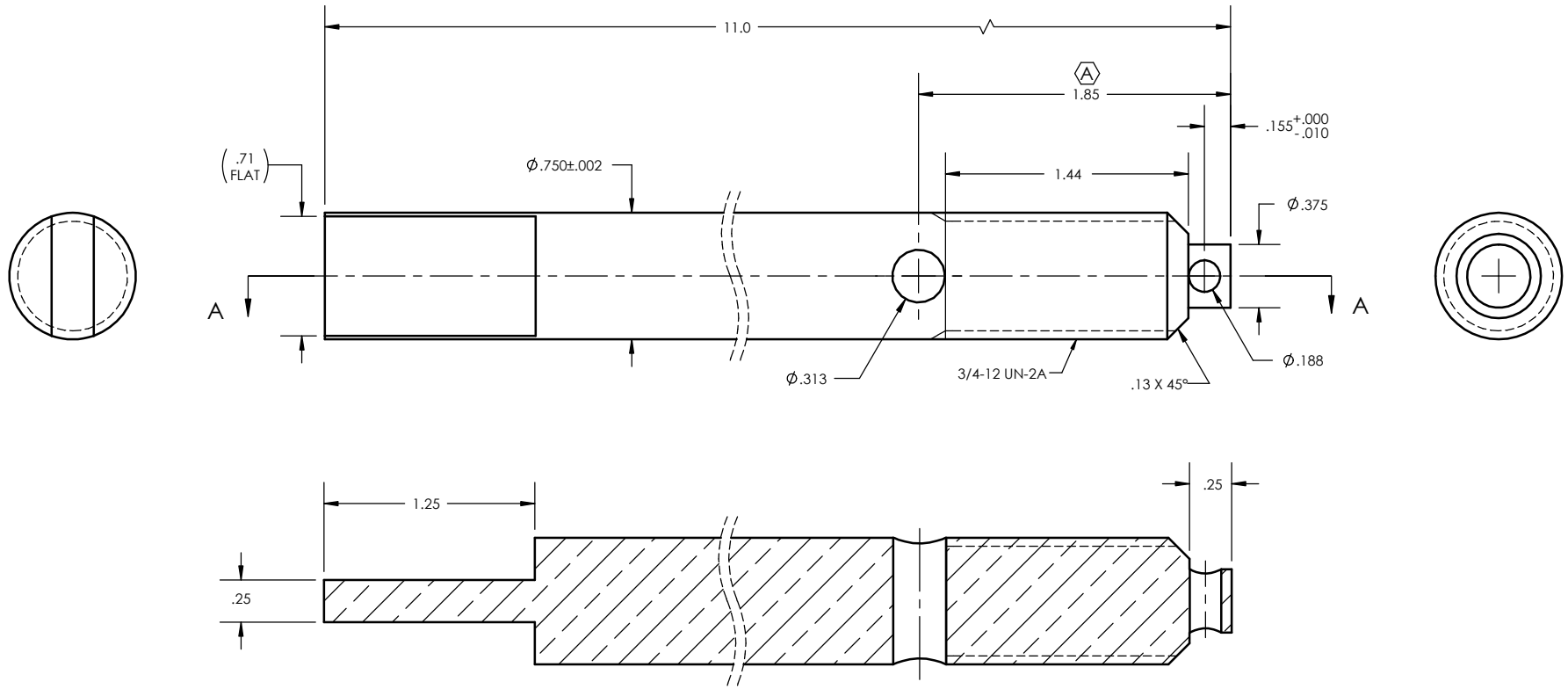

SECTION A-A

1	1	S-6042-5630	CONNECTOR 3/4-12 UN-24	COPPER	
ITEM NO.	QTY	DRAWING NO.	PART NO.	DESCRIPTION	NOTE / MAT'L
PARTS LIST					
GENERAL TOLERANCES (UNLESS OTHERWISE SPECIFIED)				Electro Composites solid HV bushings solution	
X.		±0.040			
.X		±0.020			
.XX		±0.010			
.XXX		±0.004			
ANGLES		±0.25°			
RADIUS		±0.010			
$\text{\textcircled{A}}$ REMOVE BURRS AND BREAK SHARP EDGES DIMENSIONS ARE IN INCHES (UNLESS OTHERWISE SPECIFIED)				TITLE: CONNECTOR 3/4-12 X 11"	
DRAWN BY: J.N.PILOTTE		DATE: 2009/12/14		FORMAT: A	DRAWING NO.: S-6042-5630
CHECK BY:		PROJECTING:		CAGE CODE:	REVISION: A
PROJECT MANAGER:		SCALE: 1:1		GENERATED BY: SolidWorks 2013	SHEET: 1 of 1

This drawing is the proprietary property of Electro Composites (2008) ULC, not part of the public domain, and is issued with the express understanding and agreement that it is not to be reproduced or copied in whole or in part or issued for furnishing information to others, or used directly or indirectly, in any way detrimental to the interest of Electro Composites (2008) ULC and is to be returned upon request by Electro Composites (2008) ULC. All Rights Reserved.