

# COMPRESSION/TENSION NEW CONSTRUCTION CAPS FOR PIPE SHAFTS

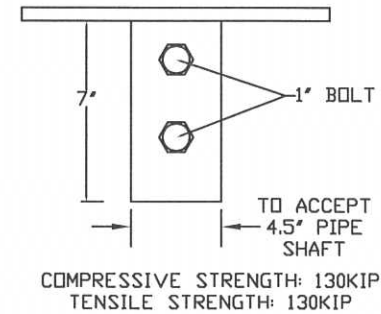
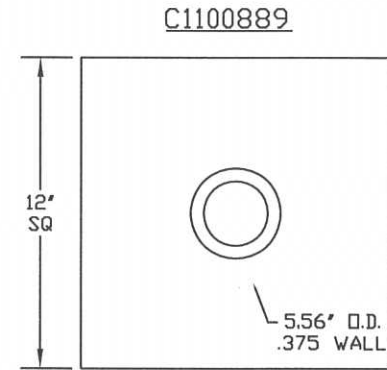
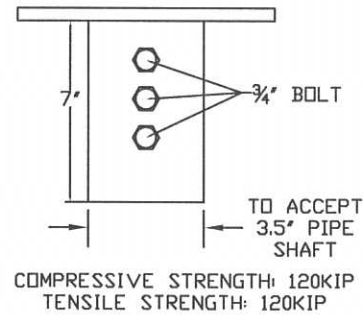
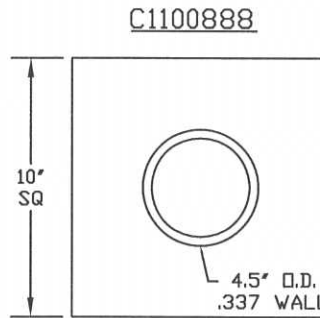
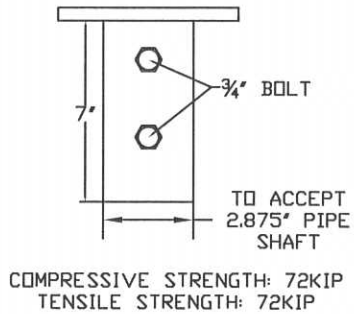
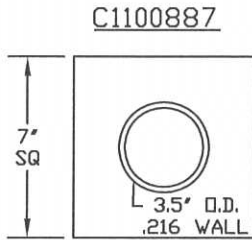

## =NOTES=

1. FINISH: STANDARD CATALOG NUMBER IS MILL FINISH STEEL.  
TO ORDER GALVANIZED FINISH ADD "G" TO STANDARD CATALOG NUMBER.
2. MATERIAL SPECIFICATIONS:  
 PLATE: HOT ROLLED STEEL PLATE PER ASTM A572 GRD. 50.  
 PIPE: ERW PIPE PER ASTM A53 GRADE B OR PER ASTM A500 GRADE 50.  
 BOLTS: 3/4" BOLTS PER SAE J429 GRADE 5.  
 1" BOLTS PER GRADE 8.

<b>CHANCE</b> TOLERANCE CHART	<b>HUBBELL POWER SYSTEMS</b> POWER SYSTEMS, INC.		
CONFIDENTIAL: THIS DRAWING AND ITS CONTENTS ARE CONFIDENTIAL AND THE EXCLUSIVE PROPERTY OF HUBBELL POWER SYSTEMS. NO PUBLICATION, DISTRIBUTION OR COPIES MAY BE MADE WITHOUT THE WRITTEN CONSENT OF HUBBELL POWER SYSTEMS. HUBBELL POWER SYSTEMS UNPUBLISHED ALL RIGHTS RESERVED UNDER THE COPYRIGHT LAWS.	<b>TITLE</b> BRACKET, COMPRES./TEN. NEW CONSTRUCTION		
	SIZE   DWG NO. SB   SA1100887	CAT / PART / ASSY NO. SEE DRAWING	REV -
DO NOT SCALE THIS DRAWING	DRN BY ksh	DATE 10/4/10	SHEET 1 OF 1