

# CATALOG NUMBER: PSC2060702

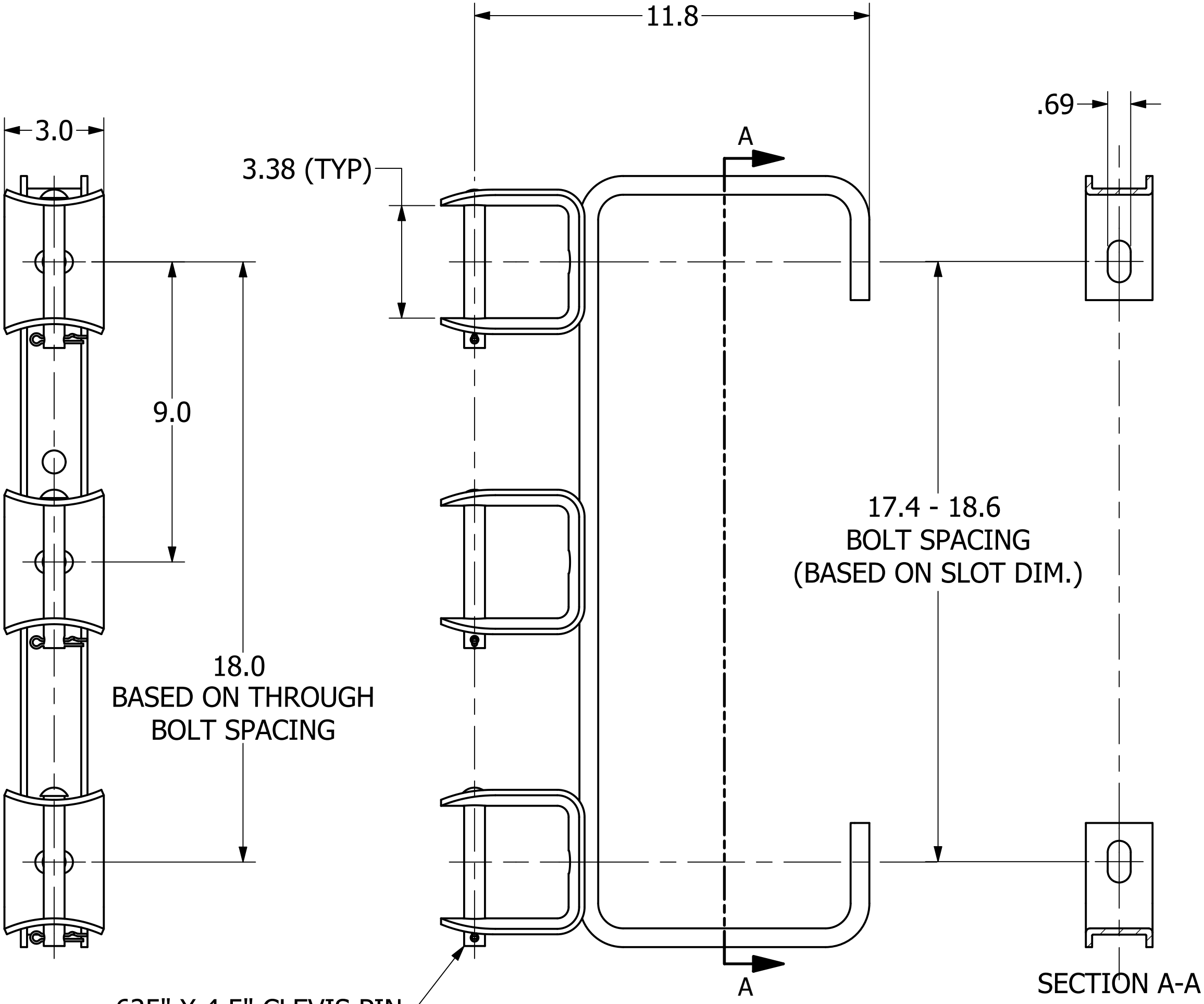

.625" X 4.5" CLEVIS PIN WITH COTTER KEY (3 PLACES)

**-NOTES-**

1. ASSEMBLED COMPLETE AS SHOWN.
2. MATERIAL: STRUCTURAL GRADE CHANNEL 2" X 9/16" X 3/16".
3. HOT DIP GALVANIZED PER ASTM A153.
4. MAXIMUM LOAD RATING AS FOLLOWS:
  - TRANSVERSE: 3000 LBS (1000 LBS PER CLEVIS)
  - LONGITUDINAL: 650 LBS
  - VERTICAL: 750 LBS

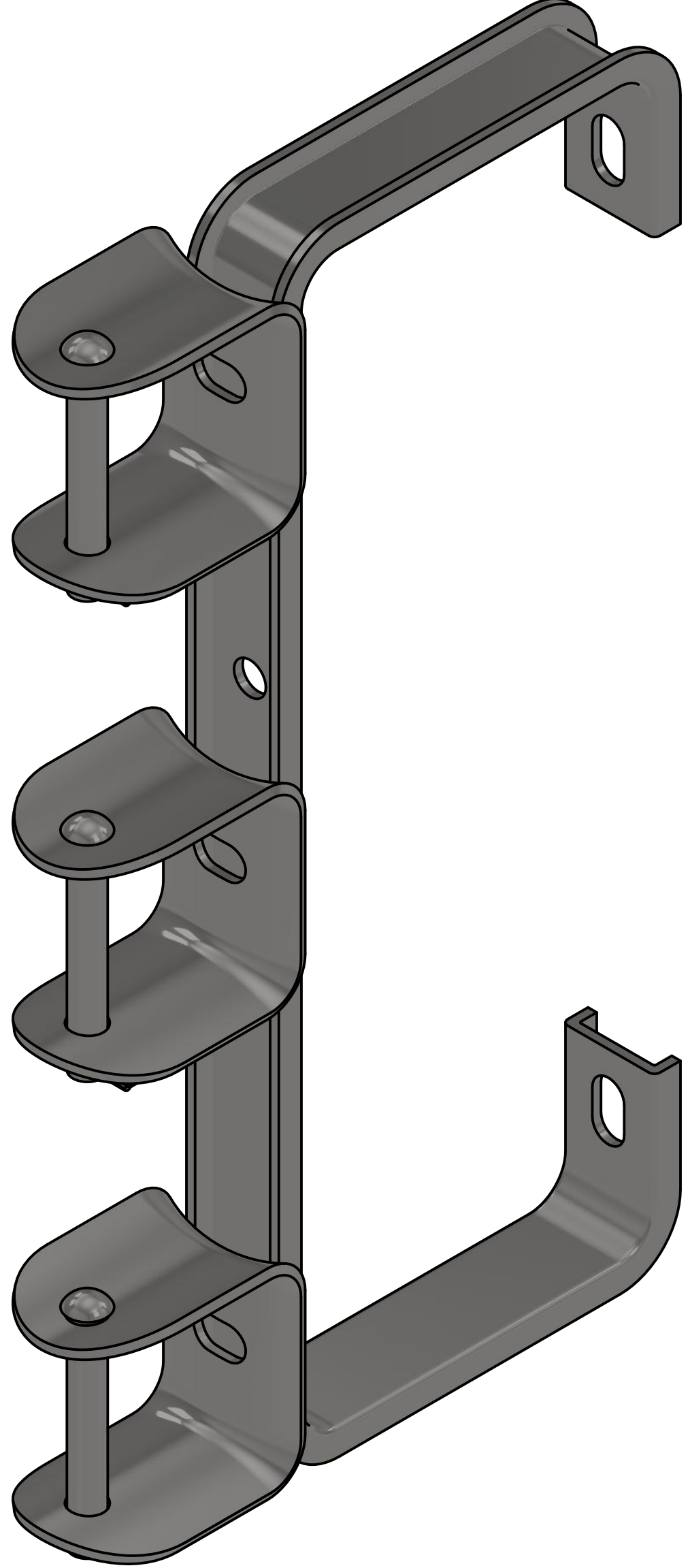

TRANSVERSE  
VERTICAL  
LONGITUDINAL  
NOTE-4

<b>CHANCE</b> <sup>®</sup> <small>CONFIDENTIAL: THIS DRAWING AND ITS CONTENTS ARE CONFIDENTIAL AND THE EXCLUSIVE PROPERTY OF HUBBELL POWER SYSTEMS. NO PUBLICATION, DISTRIBUTION, OR COPIES MAY BE MADE WITHOUT THE WRITTEN CONSENT OF HUBBELL POWER SYSTEMS. HUBBELL POWER SYSTEMS UNPUBLISHED ALL RIGHTS RESERVED UNDER THE COPYRIGHT LAWS.</small>	HUBBELL POWER SYSTEMS, INC.	
	TITLE <b>THREE WIRE SECONDARY RACK</b>	
SIZE <b>C</b>	CAT / PART / ASSY NO. <b>PSC2060702</b>	DWG NO. <b>SA2060702</b>
DO NOT SCALE THIS DRAWING	DRN BY HOEK	DATE 9/16/19
		REV <b>A</b>
		SHEET 1 OF 1