

- * * NOTES * *
1. MAT'L:
 TOOL BODY - CAST STEEL
 COIL LOCK - SPRING STEEL
 BENT ARM PIN - COLD DRAWN STEEL
 2. FINISH:
 TOOL BODY - PAINTED SPRUCE GREEN
 COIL LOCK - ZINC PLATED WITH YELLOW COATING
 BENT ARM PIN - ZINC PLATED
 3. FITS C3030981 LOCKING DDG ASSEMBLY.

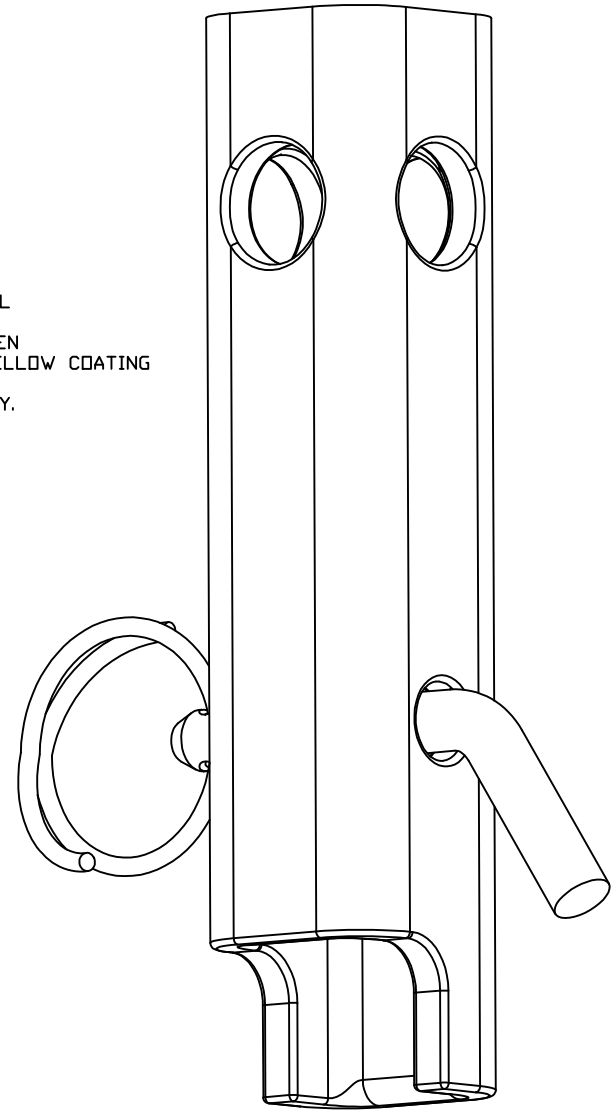
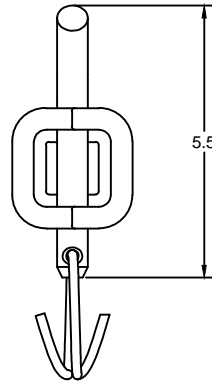
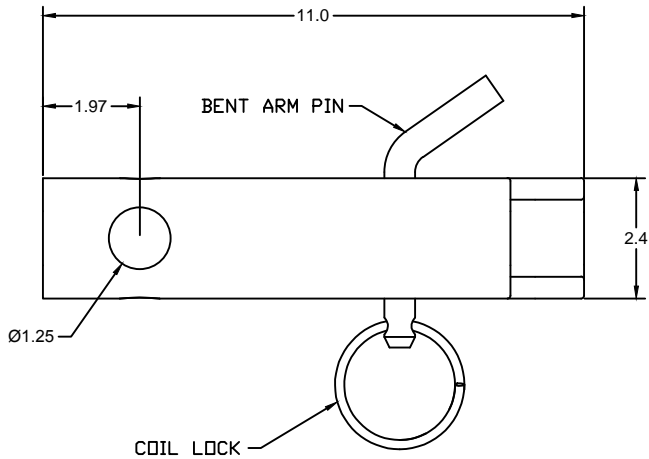

CATALOG NUMBER	INCLUDES
C3031035	SS5/ SS150 DRIVE TOOL, BENT ARM PIN AND COIL LOCK
C3031226	BENT ARM PIN & COIL LOCK

CHANCE TOLERANCE CHART		HUBBELL® POWER SYSTEMS DRIVE TOOL	
CONFIDENTIAL: THIS DRAWING AND ITS CONTENTS ARE CONFIDENTIAL AND THE EXCLUSIVE PROPERTY OF HUBBELL POWER SYSTEMS. NO PUBLICATION, DISTRIBUTION OR COPIES MAY BE MADE WITHOUT THE WRITTEN CONSENT OF HUBBELL POWER SYSTEMS. HUBBELL POWER SYSTEMS UNPUBLISHED. ALL RIGHTS RESERVED UNDER THE COPYRIGHT LAWS.		TITLE SS5/ SS150 DRIVE TOOL	
SIZE B	DWG NO. SA3031035	GAT / PART / ASSY NO. SEE CHART	REV A
DDI NOT SCALE THIS DRAWING	DRN BY TMK	DATE 11/6/12	SHEET 1 OF 1