

C403-2073 1-1/4" X 6' DISCONNECT
T403-2278 1-1/4" X 24' DISCONNECT

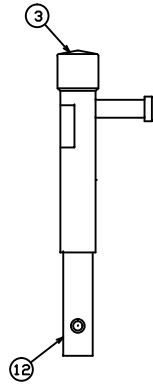

C403-2095
1-1/4" PLASTIC DISCONNECT

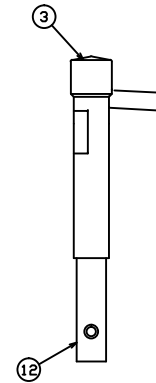

T403-2260
1-1/4" PLASTIC DISCONNECT

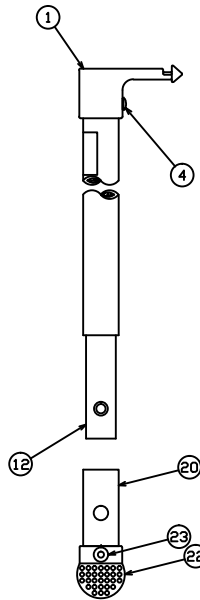

C403-2053 1-1/4" X 4' METAL DISCONNECT
C403-2054 1-1/4" X 6' METAL DISCONNECT
C403-2055 1-1/4" X 8' METAL DISCONNECT

C403-2340 1-1/4" X 4' METAL DISCONNECT
C403-2341 1-1/4" X 6' METAL DISCONNECT
C403-2342 1-1/4" X 8' METAL DISCONNECT

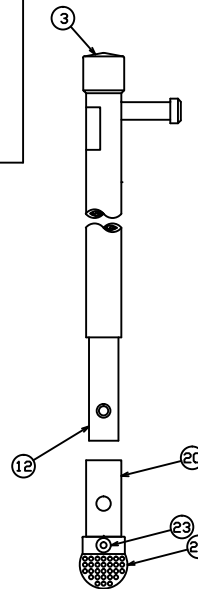
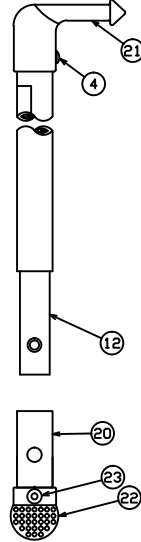

C403-2059 1-1/4" X 4' PLASTIC DISCONNECT
C403-2060 1-1/4" X 6' PLASTIC DISCONNECT
C403-2061 1-1/4" X 8' PLASTIC DISCONNECT

REPLACEMENT PARTS LIST

PART NUMBER	ITEM	DESCRIPTION
069068P	1	SWITCH STICK HEAD
056394P	3	PLASTISOL CAP
P0010779P	4	DRIVE SCREW
E4032221P	12	SPLICE
C4032069	20	NON CONDUCTIVE SPLICE
068965P	21	DISCONNECT HEAD
P4032312P	22	POLE CAP
058735P	23	DRIVE RIVET

CONFIDENTIAL: THIS DRAWING AND ITS CONTENTS ARE CONFIDENTIAL AND THE EXCLUSIVE PROPERTY OF HUBBELL POWER SYSTEMS. NO PUBLICATION, DISTRIBUTION OR COPIES MAY BE MADE WITHOUT THE WRITTEN CONSENT OF HUBBELL POWER SYSTEMS. HUBBELL POWER SYSTEMS UNPUBLISHED ALL RIGHTS RESERVED UNDER THE COPYRIGHT LAWS.

HUBBELL POWER SYSTEMS
POWER SYSTEMS, INC.

TITLE: **NON-CONDUCTIVE DISCONNECT STICK**

SIZE	DWG NO.	CAT / PART / ASSY NO.	REV
B	SA403-2053	SEE DRAWING	--
DO NOT SCALE THIS DRAWING	DRN BY RAM	DATE 5/19/14	SHEET 1 OF 1