

-NOTES-

1. MATERIAL: PORCELAIN, LIGHT GRAY
2. USED TO ISOLATE SECTIONS OF THE GUY WIRE.
3. MEETS ANSI/NEMA C29.4

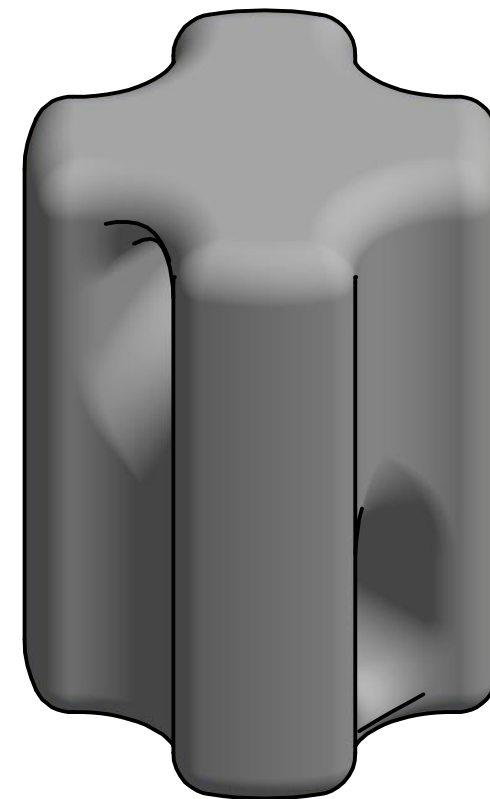

CATALOG NUMBER	ANSI CLASS	TENSILE STRENGTH (LBS)	MAX. CABLE DIAMETER	"A"	"B"	"C"	"D"	"E"
C9091041	54-1	10,000	3/8	5/8	1 3/4	3 1/2	2 1/2	1 3/4
C9091042	54-2	12,000	1/2	7/8	2 1/4	4 1/4	2 7/8	2 1/8

CHANCE®



HUBBELL POWER SYSTEMS, INC.

TITLE

**INSULATOR
GUY-STRAIN**

CONFIDENTIAL: THIS DRAWING AND ITS CONTENTS ARE CONFIDENTIAL AND THE EXCLUSIVE PROPERTY OF HUBBELL POWER SYSTEMS. NO PUBLICATION, DISTRIBUTION, OR COPIES MAY BE MADE WITHOUT THE WRITTEN CONSENT OF HUBBELL POWER SYSTEMS. HUBBELL POWER SYSTEMS UNPUBLISHED ALL RIGHTS RESERVED UNDER THE COPYRIGHT LAWS.

SIZE B	CAT / PART / ASSY NO. SEE CHART	DWG NO. SA9091041	REV C
DO NOT SCALE THIS DRAWING	DRN BY HOEK	DATE 3/30/22	SHEET 1 OF 1