

(ϕ .75)

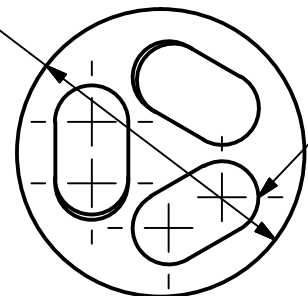

ϕ .19 X .16 SLOTS REF
3X

UNUSED PORT INSERTS
(2X) PSP4040308P

FLAT DROP GROMMET
3 PORT

(1.0)

ϕ (.63)

-NOTES-

1. GROMMET MAT'L: POURED URETHANE
2. GROMMET IS FOR 570 AND 790 CLOSURES ONLY.
3. FOR GROMMET SERIES 570 CLOSURES, USE ONLY IN SMALL PORTS
4. FOR STANDARD CLOSURES, USE PROVIDED TAPE GAGE TO DETERMINE NUMBER OF RINGS TO REMOVE.
5. GROMMET PROVIDED WITH 1 OZ TUBE OF SILICONE RUBBER FOR SEALING IN CLOSURE.

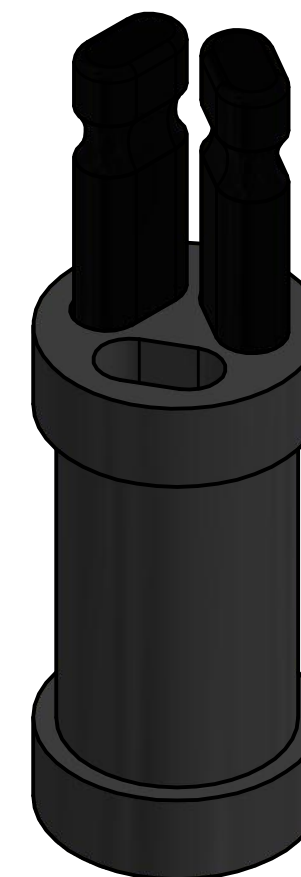

CHANCE[®]



HUBBELL POWER SYSTEMS, INC.

TITLE

3 PORT FLAT DROP
570 AND 790 SERIES

CONFIDENTIAL: THIS DRAWING AND ITS CONTENTS ARE CONFIDENTIAL AND THE EXCLUSIVE PROPERTY OF HUBBELL POWER SYSTEMS. NO PUBLICATION, DISTRIBUTION, OR COPIES MAY BE MADE WITHOUT THE WRITTEN CONSENT OF HUBBELL POWER SYSTEMS. HUBBELL POWER SYSTEMS UNPUBLISHED ALL RIGHTS RESERVED UNDER THE COPYRIGHT LAWS.

SIZE B	CAT / PART / ASSY NO. PSC4040352	DWG NO. SAC4040352	REV A
DO NOT SCALE THIS DRAWING	DRN BY GKT	DATE 2/28/19	SHEET 1 OF 1