

3/8-16UNC-2A X 5 1/2" CARRIAGE BOLTS
WITH SQUARE NUTS AND ROUND WASHERS

3/8-16UNC-2A X 1 1/4" HEX HEAD BOLT
WITH HEX NUT, LOCKWASHER, ROUND
WASHER, AND CUP WASHER.

1/2-13UNC-2A X 2" CARRIAGE BOLT
WITH HEX NUT, LOCKWASHER, AND EXTERNAL
TOOTH LOCKWASHER

NOTES:

1.) MATERIAL: STEEL, HOT DIP GALVANIZED PER ASTM
A153 (LATEST REVISION).

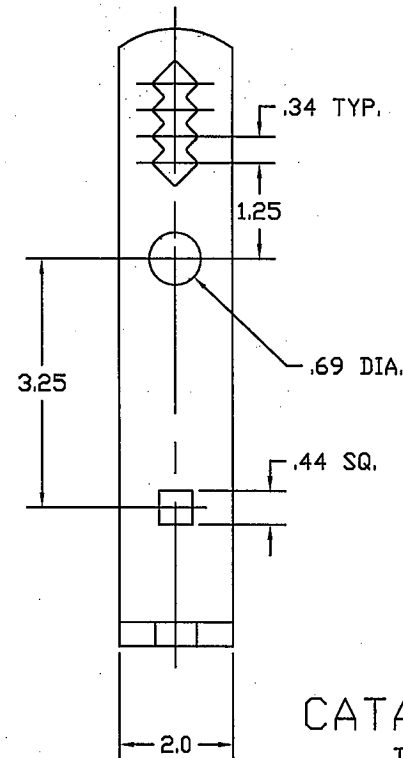

CATALOG NUMBER:
DC63B5

CHANCE
TOLERANCE CHART

CONFIDENTIAL: THIS DRAWING AND ITS
CONTENTS ARE CONFIDENTIAL AND THE
EXCLUSIVE PROPERTY OF HUBBELL
POWER SYSTEMS. NO PUBLICATION,
DISTRIBUTION OR COPIES MAY BE MADE
WITHOUT THE WRITTEN CONSENT OF
HUBBELL POWER SYSTEMS.
HUBBELL POWER SYSTEMS UNPUBLISHED
ALL RIGHTS RESERVED UNDER THE
COPYRIGHT LAWS.

 HUBBELL POWER SYSTEMS

TITLE NEMA STANDARD
CROSSARM BRACKET

SIZE	DWG NO.	CAT / PART / ASSY NO.	REV
SB	SADC63B5	DC63B5	---
DO NOT SCALE THIS DRAWING	DRN BY JJL	DATE 09/12/08	SHEET 01 OF 01