

CATALOG NUMBER	CONDUCTOR RANGE		FIG. NO.	WIRE STRIP LENGTH	DIE INDEX
	BARREL 'A'	BARREL 'B'			
YRB29U2	250 Kcmil	# 1 STR. # 2 STR.	1	1/8"	21AB 299
YRB29U25		1/0 STR.	1		
YRB29U26		2/0 STR.	2		
YRB29U27		3/0 STR.	2	1-13/16"	
YRB29U28		4/0 STR.	2		

CATALOG NUMBER	CONDUCTOR RANGE		FIG. NO.	WIRE STRIP LENGTH	DIE INDEX
	BARREL 'A'	BARREL 'B'			
YRB30U2	300 Kcmil	# 1 STR. # 2 STR.	1	1/8"	21AB 299
YRB30U25		1/0 STR.	1		
YRB30U26		2/0 STR.	2		
YRB30U27		3/0 STR.	2	1-13/16"	
YRB30U28		4/0 STR.	2		
YRB30U29	250 Kcmil	2			

CATALOG NUMBER	CONDUCTOR RANGE		FIG. NO.	WIRE STRIP LENGTH	DIE INDEX
	BARREL 'A'	BARREL 'B'			
YRB31U2	350 Kcmil	# 1 STR. # 2 STR.	1	1/8"	21AB 299
YRB31U25		1/0 STR.	1		
YRB31U26		2/0 STR.	2		
YRB31U27		3/0 STR.	2	1-13/16"	
YRB31U28		4/0 STR.	2		
YRB31U29		250 Kcmil	2		
YRB31U30		300 Kcmil	2		

REV	DATE	DESCRIPTION	ECO	BY	C'H'K.
C	10/13/2020	UPDATED AS PER MARKUP	54397	YR	SS

BURNDY® INSTALLATION TOOLING (# OF CRIMPS OR INDENTS PER END) FIGURE 1 < 9

COLOR CODE	DIE INFORMATION		MECHANICAL RATCHET		HYDRAULIC						
	DIE INDEX	TYPE	OUR840	MD6 MD7	Y29B	Y34B	Y35, Y39 Y750, BAT35 PAT750	8 > Y46	7 > Y45	Y488	Y60BHU
---	21AB	NEST INDENTOR	---	---	---	---	---	P35D (1) P48PR -1	---	C310 (1) Y48PR-1	---
BROWN	299	BROWN DIE SET NEST INDENTOR	---	---	---	---	U31ART (1)	U31ART (1) P35D (1) P48PR1	U31ART (1)	C31AR (1) C35D (1) Y48PR-1	L31ART (1)

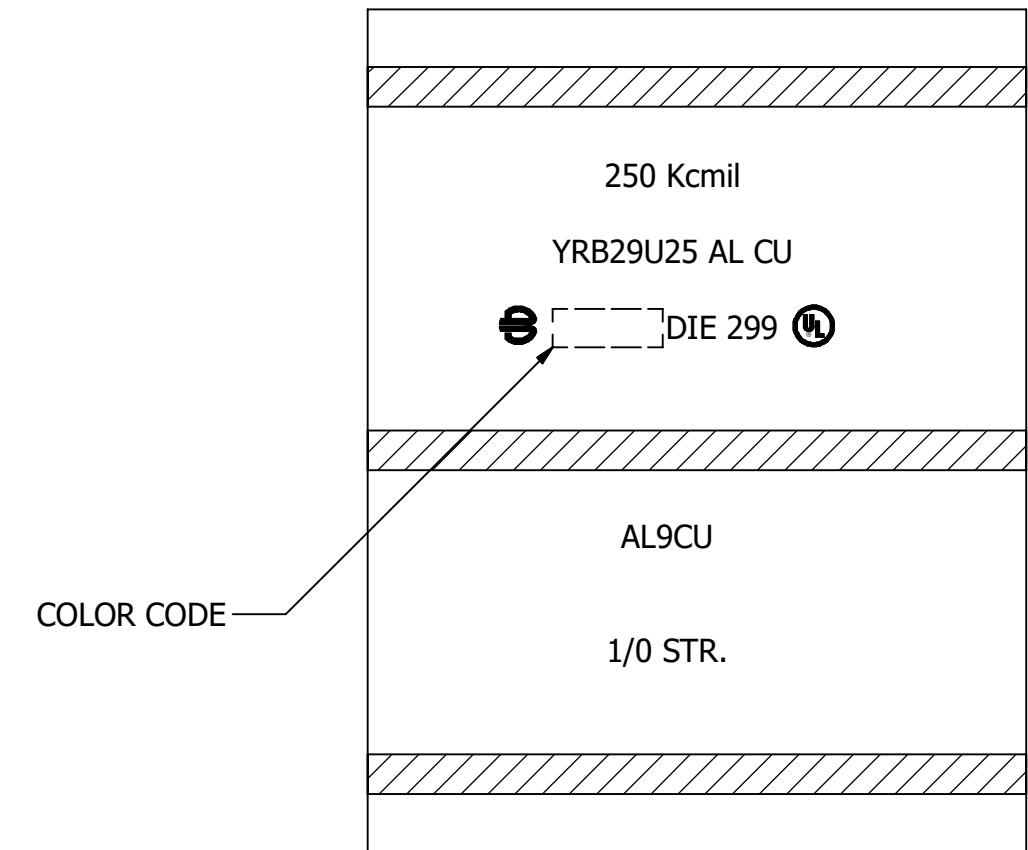

TYPICAL LETTERING VIEW:

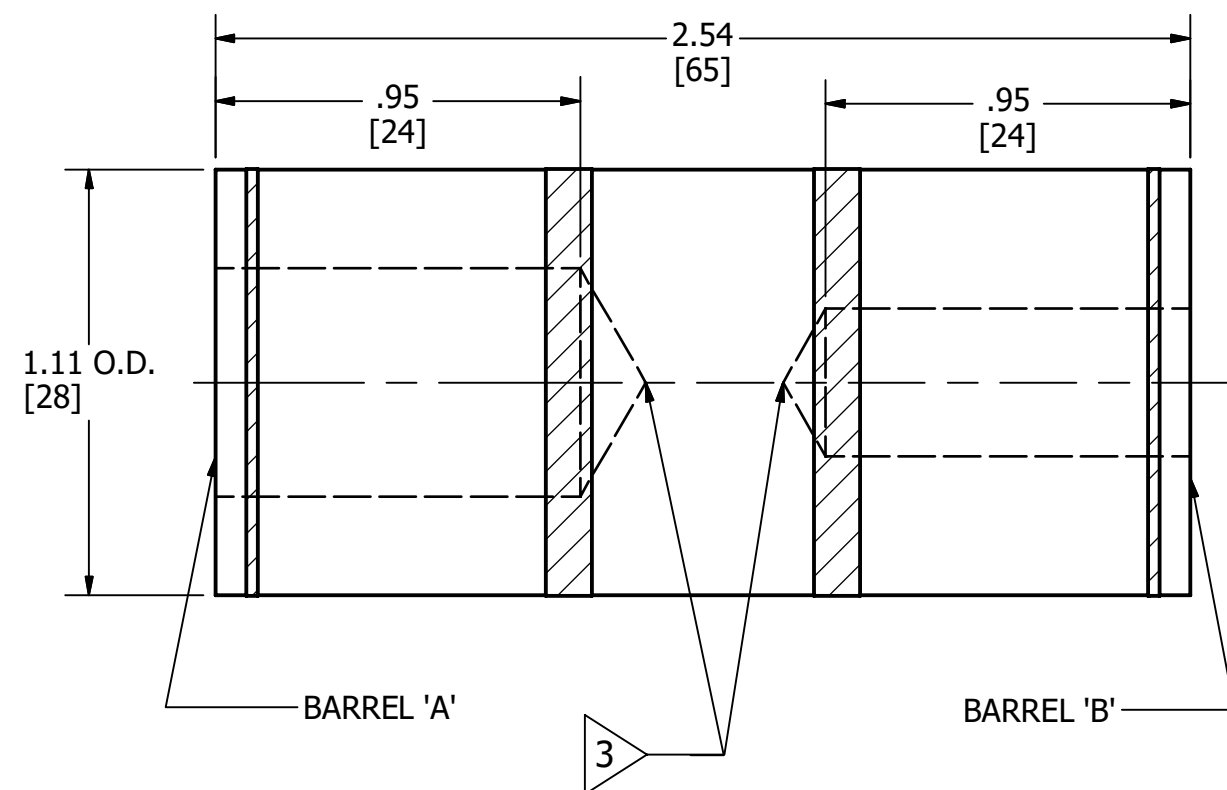

FIG. 1.

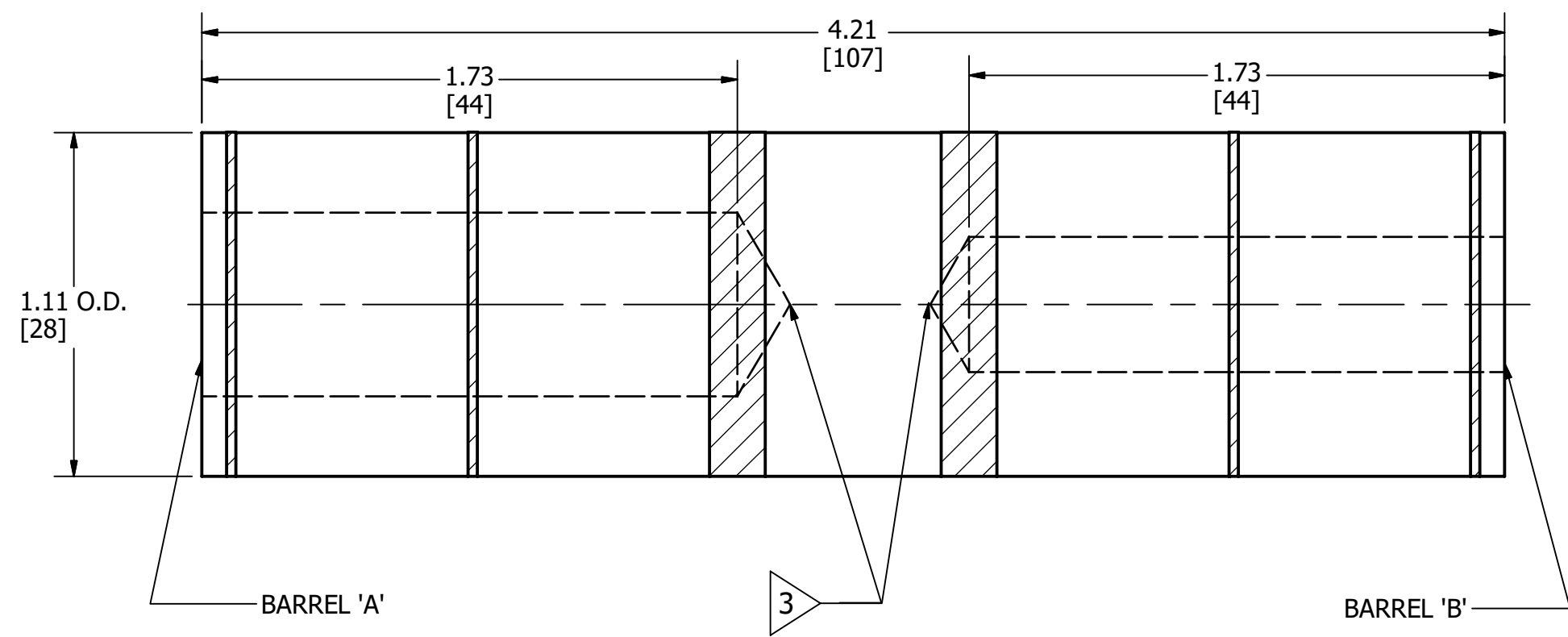

FIG. 2. < 9

NOTES:

1. MATERIAL: ALUMINUM
2. FINISH: TIN PLATED
3. BARRELS ARE PARTIALLY FILLED WITH PENETROX™ AND SEALED.
4. SCRATCH BRUSHING OF ALL CONDUCTORS BEFORE MAKING INSTALLATION IS RECOMMENDED
5. NOT FOR USE WITH COPPER TO COPPER APPLICATIONS.
6. DIMENSIONS IN BRACKETS [] ARE IN MILLIMETERS ROUNDED OFF TO THE NEAREST MILLIMETER, UNLESS OTHERWISE NOTED, AND ARE FOR REFERENCE ONLY.
7. CATALOG #PT6515 ADAPTOR IS REQUIRED TO USE "U" DIES IN Y45 SERIES TOOLS.
8. CATALOG #PUADP-1 ADAPTOR IS REQUIRED TO USE "U" DIES IN Y46 SERIES TOOLS.
9. FIGURE 2 TAKES TWICE AS MANY CRIPMS.

TO ORDER BURNDY® PRODUCTS CALL		HYREDUCER™	
UNITED STATES 1-800-346-4175 (LONDONDERRY, NH)		CANADA: 1-800-361-6975 (QUEBEC) 1-800-387-6487 (ALL OTHER PROVINCES)	
FOR PRODUCT INFO: http://www.burndy.com		DRAWING NO. REV	
ITEM NO: N/A		SD074136 C	
CAT. NO: YRB-U- (TABLE)		SIZE	
DRAWN BY: S.D.C. 08/08/1972		C	
CHECKER: J.P.S. 11/23/1972		C	
DSN APRVL: E.F.N. 11/23/1972		C	
MFG APRVL: N/A		C	
CR APRVL: YARIO 12/21/1995		C	
MKT APRVL: L.HERRON 11/28/1995		C	
PROJ FAMIL: ---		C	
PROJECT #: ---		C	
DOCUMENT TYPE: SALES		C	
REL LEVEL: Released		C	