

CONDUCTOR (ACSR)		FIG No.	CATALOG NUMBER	H	L	P	Q	INSTALLATION DATA								SEE NOTE NO.	PENETROX PTS/C (MIN. REQ'D)	REFERENCE										
SIZE Kcmil OR AWG	STR							HYPRESSES WITH No. OF CRIMPS																				
								TOOL INDEX No.	Y35 DIE SET		Y48B		Y486RB		Y60													
101.8 (.461)	12/7	1	YOU251R	1.17 [29.7]	11.19 [284.2]	0.62 [15.7]	0.55 [14.0]	316	U33RYFT	18	C316	6	F33RYF	6	L316	6	3	5.5 [139.7]	FC032168									
134.6 (.530)	12/7		YOU261R	1.17 [29.7]	11.19 [284.2]	0.53 [13.5]	0.55 [14.0]										317 OR 426	U35RYFT	18	C317	6	--	--	L317 /L426	6	3	5.5 [139.7]	FC024537
159.0 (.576)	12/7		YOU271R	1.28 [32.5]	11.19 [284.2]	0.58 [14.7]	0.61 [15.5]																			316	U33RYFT	21
300 (.680)	26/7		YOU32R	1.22 [31.0]	12.94 [328.7]	0.72 [18.3]	0.74 [18.8]	317 OR 426	U35RYFT	21	C317	7	--	--	L317 /L426	7		8.0 [203.2]	FC024052									
336.4 (.684)	18/1		YOU33R	1.22 [31.0]	12.94 [328.7]	0.77 [19.6]	0.80 [20.3]										327	U361RYFT	21	C317	7	--	--	L317 /L426	7		9.0 [228.6]	FC023290
336.4 (.721)	26/7		YOU35R	1.32 [33.5]	12.91 [327.9]	0.84 [21.3]	0.86 [21.8]	261	U261	21	C317	7	--	--	L317 /L426	7											9.0 [228.6]	FC024533
(0.741)	30/7		YOU361R	1.35 [34.3]	12.94 [328.7]	0.81 [20.6]	0.88 [22.4]										261	U261	21	C327	7	--	--	L327	7		9.0 [228.6]	FC023528
397.5 (.783)	26/7		YOU37R	1.40 [35.6]	12.94 [328.7]	0.93 [23.7]	0.94 [23.9]	261	U261	21	C261	7	F37RYF	7	L261	7											9.5 [241.3]	FC023294
(0.743)	18/1																											
(0.806)	30/7																											
477 (.814)	18/1																											
556.5 AAC (.858)	19/37																											
477 (.846)	24/7																											
(.858)	26/7																											
(0.883)	30/7																											

REV	DATE	DESCRIPTION	ECO	BY	C'H'K.
A	04/28/2020	DEVELOP A COMPLETE SET OF PRODUCTION DRAWINGS AND 3D MODELS FOR YOU453R - 193565	53502	MRA	NJS

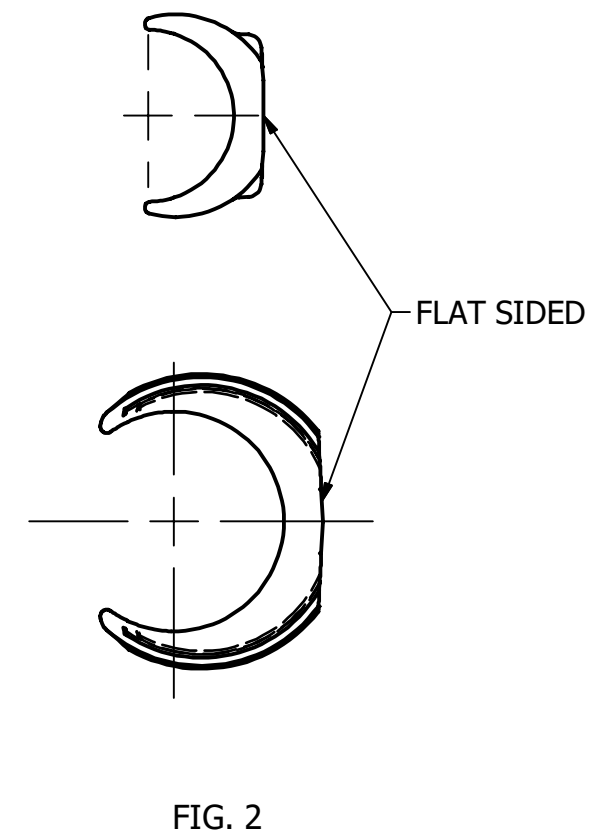
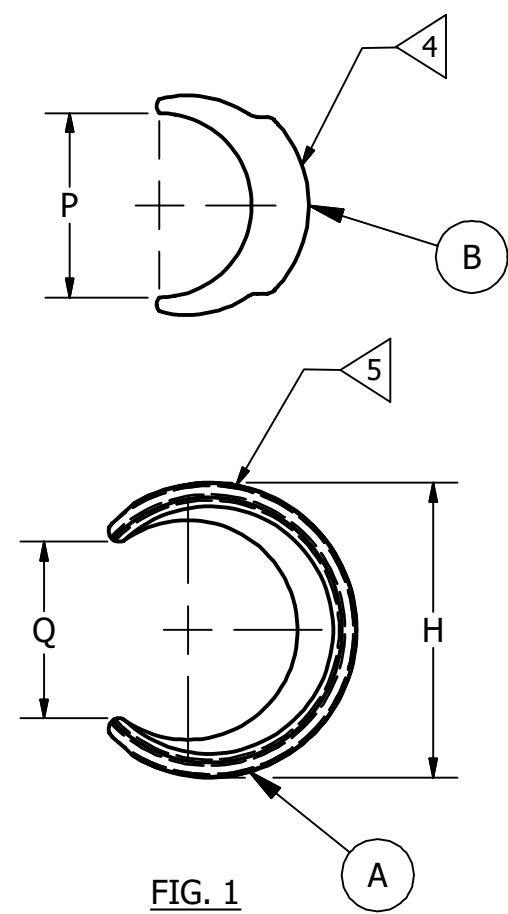
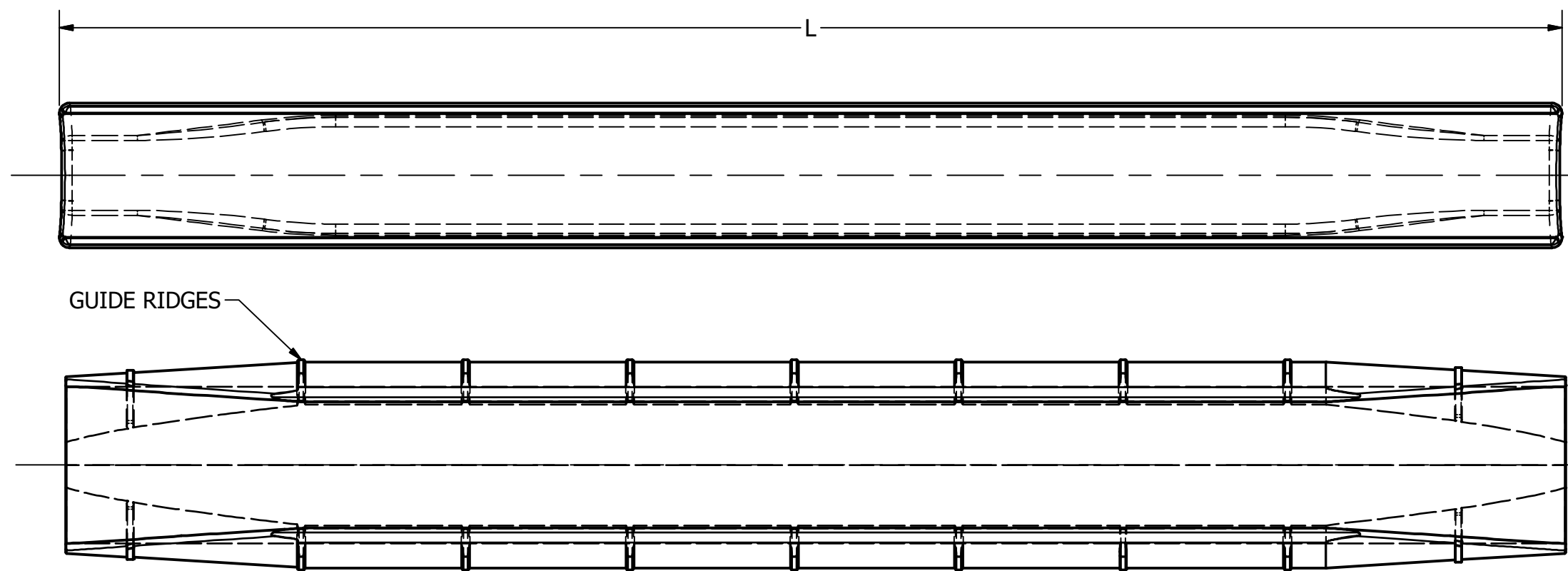

BEFORE INSTALLATION REPAIR SLEEVE CONSIST OF TWO PARTS SHOWN : (A) SLEEVE
(B) INTERLOCKING KEY

NOTES:

- 1 > YOU35R ALSO ACCOMMODATES 397.5 Kcmil (.724 DIA.) AAC.
- 2 > CAN BE INSTALLED WITH K 1-1/4 DIE.
- 3 > ALTERNATE RECOMMENDATION FOR REPAIR SLEEVE INSTALLED WITH Y34A HYPRESS-SD022443-01.
- 4 > TYPICAL LETTERING ON THIS SURFACE :
 BURNDY
 USE DIE 316
 101.8 Kcmil ACSR 12/7.
- 5 > TYPICAL LETTERING ON THIS SURFACE :
 BURNDY
 USE DIE 316
 YOU251R
 101.8 Kcmil ACSR 12/7.

GENERAL NOTES:		COMPRESSION REPAIR SLEEVE	
1. ALTHOUGH THIS DRAWING MAY ORIGINALLY HAVE BEEN DEVELOPED TO SCALE, THE USE OF ELECTRONIC DESIGN AND REPRODUCTION TECHNIQUES MAY RESULT IN THIS COPY NOT BEING TO SCALE. THEREFORE, DO NOT SCALE THIS PRINT.		ITEM NO: NA	
2. THE DIMENSIONS, TOLERANCES AND SPECIFICATIONS OF THIS DESIGN ARE GIVEN TO PROVIDE A DEFINITION OF THE FUNCTIONAL REQUIREMENTS FOR THIS COMPONENT OR PRODUCT. ANY PART NOT MEETING THESE REQUIREMENTS SHALL BE CONSIDERED AS SCRAP.		CAT. NO: SEE TABLE	
THIS DRAWING AND/OR SPECIFICATION IS THE PROPERTY OF BURNDY, MANCHESTER NH 03109 USA. IT IS ISSUED IN STRICT CONFIDENCE AND SHALL NOT BE REPRODUCED, OR COPIED, OR DISCLOSED TO OTHERS, OR USED AS THE BASIS FOR THE MANUFACTURE OR SALE OF APPARATUS WITHOUT THE PERMISSION OF THE OWNER.		DRAWN BY: M.RAMESH	04/28/2020
		CHECKER: NJ SUDHAKAR	05/27/2020
		DSN APRVL: NJ SUDHAKAR	05/27/2020
		MFG APRVL: T WAWRZYNIAK	06/04/2020
		QA APRVL: J BRODEUR	06/05/2020
		MKT APRVL: MA THERRIEN	08/19/2020
PROD FAM: OVERHEAD DISTRIBUTION	DRAWING NO	REV	
PROJECT #: --	SIZE	SD021894	A
DOCUMENT TYPE: SALES	C	SHEET 1 OF 2	
REL LEVEL: Released			



CONDUCTOR (ACSR)		FIG No.	CATALOG NUMBER	H	L	P	Q	INSTALLATION DATA								PENETROX PTS/C (MIN. REQ'D)	REFERENCE	
SIZE Kcmil OR AWG	STR							HYPRESSES WITH No. OF CRIMPS				TOOL INDEX No.						
								Y35 DIE SET	Y48B	Y486RB	Y60							
500 (.904)	30/7	2	YOU38R	1.56 [39.6]	13.69 [347.7]	0.97 [24.6]	0.94 [23.9]	614	--	--	C614	8	--	--		11.00 [279.4]	FC032465	
556.5 (.914) (0.927)	24/7 26/7		YOU39R	1.72 [43.7]	13.69 [347.7]	1.02 [25.9]	1.06 [26.9]	608	U39RYFT	24	C608	8	--	--	L608	8	12.00 [304.8]	FC031596
636 (.930)	36/1		YOU421R	2.00 [50.8]	13.69 [347.7]	0.95 [24.1]	1.06 [26.9]	292 OR 578	--	--	C421RYF-1	8	F421RYF-1	8	L292 /L578	8	12.00 [304.8]	FD023600
605 (.953)	54/7		YOU41R	1.84 [46.7]	13.69 [347.7]	1.02 [25.9]	1.00 [25.4]				C421RYF-1	8	F421RYF-1	8	L292 /L578	8	12.00 [304.8]	FC028971
605 (.994)	30/19		YOU43R	2.00 [50.8]	13.69 [347.7]	1.06 [26.9]	1.06 [26.9]	292, 578 OR 319	--	--	C421RYF-1 /C319	8	F421RYF-1 /F43RYF	8	L292 /L319	8	13.00 [330.2]	FD022656
636 (.990) (1.019)	26/7 30/19																	
666.6 (1.000)	24/7		YOU44R	1.84 [46.7]	13.69 [347.7]	1.14 [29.0]	1.08 [27.4]	319	--	--	C319	8	F43RYF	8	L319	8	15.00 [381.0]	FC032463
795 (1.093) (1.108)	54/7 26/7		YOU45R	1.84 [46.7]	13.69 [347.7]	1.18 [30.0]	1.16 [29.4]	352 OR 579	--	--	C352 /C579	8	F45RYF --	8	L352 /L579	8	15.00 [381.0]	FC024535
795 (1.04)	36/1		YOU453R	1.88 [47.8]	13.69 [347.7]	1.12 [28.4]	1.15 [29.2]	292 OR 578	--	--	C421RYF-1	8	F421RYF-1	8	L292 /L578	8	15.00 [381.0]	FC029180
715.5 (1.051)	26/7		YOU48R	2.12 [53.8]	14.18 [360.1]	1.27 [32.2]	1.32 [33.6]	575	--	--	C575	10	F48RYF	10	L575	10	16.00 [406.4]	FC028648
900 (1.162) 954 (1.196)	54/7 54/7		YOU49R	2.14 [54.4]	14.81 [376.1]	1.32 [33.6]	1.36 [34.6]	422	--	--	--	--	F49RYF	10	L422	10	16.00 [406.4]	FC024054
1033.5 (1.246) 1113 (1.293) 1192.5 (1.333)	54/7 54/19		YOU50R	2.14 [54.4]	15.00 [381.0]	1.32 [33.6]	1.39 [35.3]	422	--	--	--	--	F49RYF	10	L422	10	16.00 [406.4]	FC059719

REV	DATE	DESCRIPTION	ECO	BY	C'H'K.
A	04/28/2020	DEVELOP A COMPLETE SET OF PRODUCTION DRAWINGS AND 3D MODELS FOR YOU453R - 193565	53502	MRA	NJS

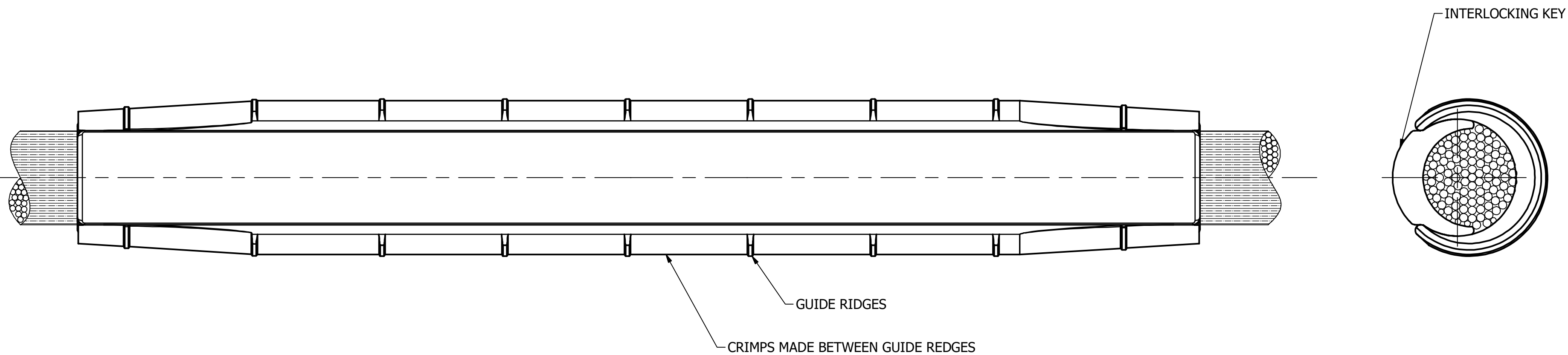

NOTES:

- SCRATCH BRUSH CONDUCTOR & CONNECTOR CONTACT SURFACE DRY, THEN APPLY 'PENETROX™-A'. 'PENETROX™-A' CAN BE PURCHASED FROM THE BURNDY CORP. IN CANS OR SQUEEZE BOTTLES.
- CRIMPS TO START FROM THE CENTER & WORK TOWARD THE ENDS.

GENERAL NOTES:		COMPRESSION REPAIR SLEEVE			
1. ALTHOUGH THIS DRAWING MAY ORIGINALLY HAVE BEEN DEVELOPED TO SCALE, THE USE OF ELECTRONIC DESIGN AND REPRODUCTION TECHNIQUES MAY RESULT IN THIS COPY NOT BEING TO SCALE. THEREFORE, DO NOT SCALE THIS PRINT.		ITEM NO: NA			
2. THE DIMENSIONS, TOLERANCES AND SPECIFICATIONS OF THIS DESIGN ARE GIVEN TO PROVIDE A DEFINITION OF THE FUNCTIONAL REQUIREMENTS FOR THIS COMPONENT OR PRODUCT. ANY PART NOT MEETING THESE REQUIREMENTS SHALL BE CONSIDERED AS SCRAP.		CAT. NO: SEE TABLE			
THIS DRAWING AND/OR SPECIFICATION IS THE PROPERTY OF BURNDY, MANCHESTER NH 03109 USA. IT IS ISSUED IN STRICT CONFIDENCE AND SHALL NOT BE REPRODUCED, OR COPIED, OR DISCLOSED TO OTHERS, OR USED AS THE BASIS FOR THE MANUFACTURE OR SALE OF APPARATUS WITHOUT THE PERMISSION OF THE OWNER.		DRAWN BY: M.RAMESH	04/28/2020	REV	
	CHECKER: NJ SUDHAKAR	05/27/2020	A		
	DSN APRVL: NJ SUDHAKAR	05/27/2020	SD021894		
	MFG APRVL: T WAWRZYNIAK	06/04/2020	SHEET 2 OF 2		
	QA APRVL: J BRODEUR	06/05/2020			
	MKT APRVL: MA THERRIEN	08/19/2020			
PROD FAM: OVERHEAD DISTRIBUTION	DRAWING NO	REV			
PROJECT #: --	SIZE				
DOCUMENT TYPE: SALES	C				
REL LEVEL: Released					

