

CAT. NO.	CONDUCTOR ACSR OR ALUM. ALL STRANDING.	L	O.D.	INSTALLATION DATA OVERLAP CRIMP EACH END 5				
				TOOL INDEX NO.	BURNDY HYPRESS™ AND DIE SET Y60	ALCOA DIE SET		T&B DIE SET
						150B 1	H2H	T&B 21940 TYPE PRESS
YNU32R	300 - 336.4 Kcmil ACSR 336.4 - 350 Kcmil ALUM.	14.00 [356]	1.19 [30]	717	L717	M717	H717	96
YNU34R	397.5 Kcmil ACSR, 26/7 397.5 - 477 Kcmil ALUM.	14.00 [356]	1.30 [33]	719	L719	M719	H719	106
YNU36R	477 Kcmil ACSR 500 - 556.5 Kcmil ALUM.	14.00 [356]	1.41 [36]	720	L720	M720	H720	115
YNU39R	556.5 Kcmil ACSR 600 - 650 Kcmil ALUM.	16.00 [406]	1.50 [38]	722	L722	M722	H722	125
YNU43R	605 - 666.6 Kcmil ACSR 700 - 800 Kcmil ALUM.	16.00 [406]	1.61 [41]	724	L724	M724	H724	140
YNU451R	715.5 - 874.5 Kcmil ACSR 795 - 1000 Kcmil ALUM.	16.00 [406]	1.80 [46]	725	L725	M725	H725	150
YNU49R	900 - 1113 Kcmil ACSR, 45 - 7 STR 1033.5 - 1272 Kcmil ALUM.	16.00 [406]	1.97 [50]	727	L727	M727	H727	161
YNU54R	1113 54 - 19 STR - 1431 Kcmil ACSR 1351.5 - 1600 Kcmil ALUM.	16.00 [406]	2.25 [57]	728	L728	M728	H728	189
YNU56R	1510.5 - 1590 Kcmil ACSR 1700 - 1800 Kcmil ALUM.	19.00 [483]	2.50 [64]	729	L729	M729	H729	204
YNU58R	1780 Kcmil ACSR 2000 Kcmil ALUM.	19.00 [483]	2.50 [64]	735	L735	M735	H735	212, 214
YNU59R	2032.1 - 2167 Kcmil ACSR 2300 Kcmil ALUM.	19.00 [483]	2.50 [64]	735	L735	M735	H735	214
YNU594R	2267 - 2500 Kcmil ACAR 2300 Kcmil ACSR, 2500 Kcmil ALUM.	20.00 [508]	2.60 [66]	740	L740	M740	H740	--
YNU595R	2515 Kcmil ACSR 2500 Kcmil ACAR 2500 Kcmil ALUM.	24.60 [625]	2.75 [70]	791	L791	M791	H791	--

REV	DATE	DESCRIPTION	ECO	BY	CHK.
B	04/23/2014	UPDATED AS PER MARKUP	35762	MRA	NJS

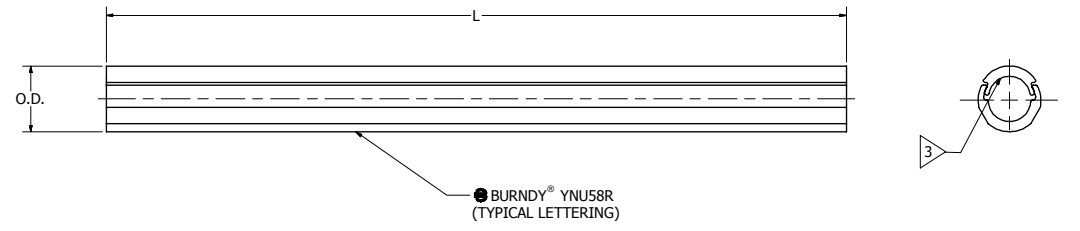
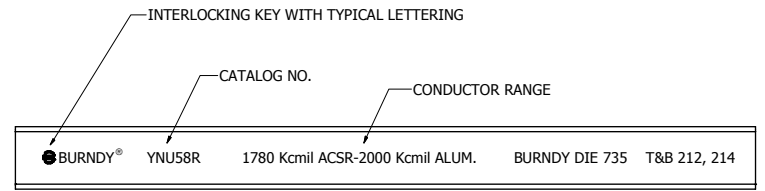

NOTES:

- THE DIES LISTED ARE MANUFACTURED BY BURNDY FOR USE IN ALCOA H2H & 150B PRESSES.
- THE EQUIVALENT T&B DIE INDEXES ARE LISTED FOR YOUR CONVINIENCE.
- PENETROX™A NOT INCLUDED IN CATALOG NO. MAY BE PURCHASED FROM BURNDY.
- CONNECTOR IS INDIVIDUALLY PACKAGED & SEALED IN POLYTUBE.
- FOR INSTALLATION INSTRUCTION REFER TO DRAWING 30003102, CAT.NO. FORM#3406.
- MATERIAL: ALUMINUM
- DIMENSIONS IN BRACKETS [] ARE IN MILLIMETERS ROUNDED OFF TO THE NEAREST MILLIMETER, UNLESS OTHERWISE SPECIFIED AND ARE FOR REFERENCE ONLY.

TO ORDER BURNDY® PRODUCTS CALL UNITED STATES 1-800-346-4175 (LONDONDERRY, NH) CANADA: 1-800-361-6975 (QUEBEC) 1-800-387-6487 (ALL OTHER PROVINCES) FOR PRODUCT INFO: http://www.burndy.com	REPAIR SLEEVE (EXTRUDED)	
	ITEM NO: --	
	CAT. NO: YNU--R (SEE TABLE)	
	DRAWN BY: R BOISVERT 3/31/2010 CHECKER: P WALTZ 5/9/2014 DSN APRVL: P WALTZ 5/9/2014 RFG APRVL: -- QA APRVL: C ACKERMAN 5/8/2014 MKT APRVL: B CRUTCHER 5/9/2014	
	PROD FAM: -- PROJECT #: -- DOCUMENT TYPE: SALES REL LEVEL: Released	DRAWING NO SD065207-01 SHEET 1 OF 1