

DRAWING NO. SE209240		7		6		5		4		3		2		1								
CATALOG NUMBER	STRANDED COPPER CONDUCTOR ACCOMMODATED			BOLT SIZE	METRIC BOLT SIZE	FIG. NO.	DIMENSIONS							REV	DATE	DESCRIPTION	ECO	BY	C'H'K.			
	CODE (AWG)	NAVY	METRIC SIZE (CLASS 2)				B	C	H REF.	K DIA.	L	N	O.D.	T REF.	Z MIN.	D	11/04/2011 09:30:00 AM	UPDATED TOOLING DETAILS AS PER MU	25809	BT	MA	
YA6CL445	#6 AWG	-----	-----	3/8	-----	1	.54 [14]	.64 [16]	.80 [20]	.41 [10]	1.36 [35]	.38 [10]	.29 [7]	.06 [2]	.36 [9]	CONNECTION SIZE	TOLERANCES					
YA6CL490						2	.58 [15]	.88 [22]	.40 [10]	1.05 [27]	.41 [10]	.06 [2]	.42 [11]	B	C		K DIA.	L	N	O.D.		
YA6CL645						1	.75 [19]	.79 [20]	.53 [13]	1.93 [49]	.53 [13]	.12 [3]	.55 [14]	-8C THRU -25	±.06		±.04	±.02	±.09	±.03	±.01	
YA6CL690						2	.75 [19]	.99 [25]	.53 [13]	1.33 [34]	.53 [13]	.12 [3]	.55 [14]	-26 THRU -34	±.08		±.04	±.02	±.12	±.03	±.01	
YA5CL45	#5 AWG	30	-----	1/4	M6	1	.44 [11]	.77 [20]	.27 [7]	1.31 [33]	.25 [6]	.30 [8]	.07 [2]	.33 [8]	-35 AND UP	±.09	±.06	±.02	±.15	±.06	±.01	
YA5CL90						2	.44 [11]	.92 [23]	.27 [7]	.81 [21]	.25 [6]	.30 [8]	.07 [2]	.33 [8]								

CONNECTION SIZE	TOLERANCES					
	B	C	K DIA.	L	N	O.D.
-8C THRU -25	±.06	±.04	±.02	±.09	±.03	±.01
-26 THRU -34	±.08	±.04	±.02	±.12	±.03	±.01
-35 AND UP	±.09	±.06	±.02	±.15	±.06	±.01

TOLERANCE BLOCK

INSTALLATION TOOLING (# CRIMPS)

CATALOG NO.	COLOR CODE	DIE INFORMATION		MECHANICAL				HYDRAULIC				DIELESS (# CRIMPS)	WIRE STRIP LENGTH												
		DIE INDEX	TYPE	6 YIMRTC	OUR840	MD6 MD7	MD6--R2 MD7-34R	PATMD6 PAT600	8 Y34A Y34B Y34BH	5 Y35, Y39 Y750, PAT750	5 4 Y46 PAT46			5 3 Y45	Y48B	Y60BHU									
YA6CL45	BLUE	7 374	BLUE DIE SET	BLUE (1)	X5CRT(1)	X5CRT(1)	X5CRT(1)	X5CRT(1)	-----	U5CRT(1)	U5CRT(1)	U5CRT(1)	MECHANICAL: MY29-3(1) MY29-11(1) MRC840(1)  HYDRAULIC: Y644(1) Y81KFT(1) Y4PC834(1)	9/16"											
YA6CL90			NEST	-----	-----	-----	-----	-----	-----	B6CD(1) A6CD(1)	U6CD-1(1)	U6CD-1(1)			U6CD-1(1)										
YA5CL45																INDENTOR	-----	-----	-----	-----	-----	Y34PR	Y34PR	Y34PR	Y34PR
YA5CL90																									

NOTES:

- MATERIAL : COPPER TUBING.
- FINISH: ELECTRO-TIN PLATED.
- CATALOG # PT6515 ADAPTOR IS REQUIRED TO USE "U" DIES IN Y45 SERIES TOOLS.
- CATALOG # PUADP-1 ADAPTOR IS REQUIRED TO USE "U" DIES IN Y46 SERIES TOOLS.
- Y35P3 INDENTOR ADAPTOR REQUIRED FOR Y34PR INDENTOR.
- PERMANENT DIE IN TOOLING.
- DIMENSIONS IN BRACKETS [ ] ARE IN MILLIMETERS ROUNDED OFF TO THE NEAREST MILLIMETER, UNLESS OTHERWISE NOTED, AND ARE FOR REFERENCE ONLY.
- FOR USE BY CUSTOMERS THAT HAVE THIS HYPRESS™. NO NEW Y34A HYPRESS™ TOOLS ARE BEING PROCESSED. Y34A USES A--D NEST DIES ONLY.
- CONNECTORS ARE UL LISTED; UNDRILLED VERSIONS ARE NOT UL LISTED.
- CONNECTORS ARE CSA CERTIFIED; UNDRILLED VERSIONS ARE NOT CSA CERTIFIED.
- FOR UNDRILLED VERSIONS ADD SUFFIX "-U" TO END OF CATALOG NUMBER. FOR UNDRILLED VERSIONS, USE D MIN. = N MAX. + Z MIN.
- "X", "W-RT", "W-VT", "U", & "L" DIE SETS ARE COLOR CODED. "A", "B", AND "C" DIES ARE NOT COLOR CODED. NESTS AND INDENTOR TYPE ARE NOT COLOR CODED.
- X8CABT & U8CABT DIES USED ON YA6C--HYLUG™ NOT YA5C--HYLUG™.

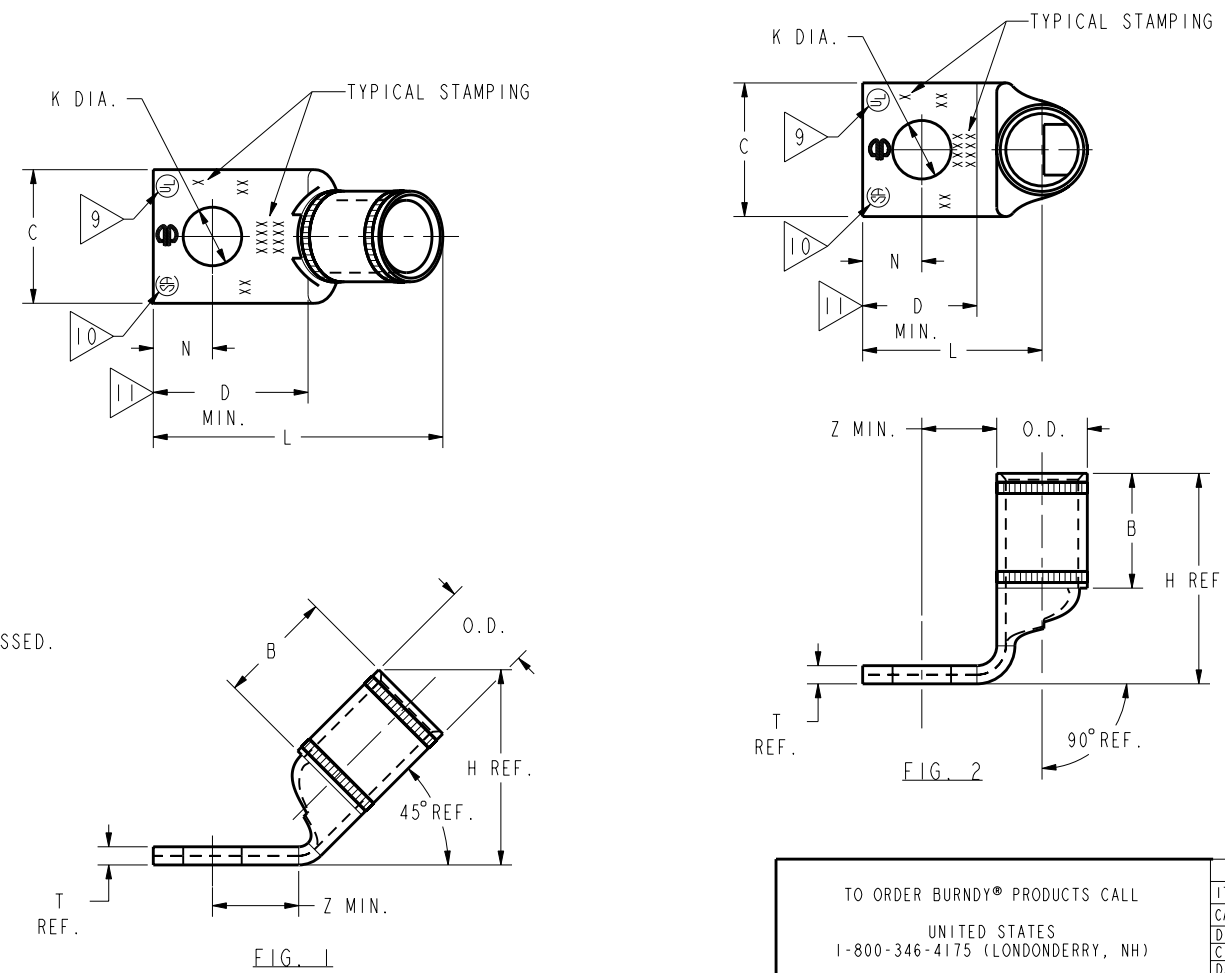

TO ORDER BURNDY® PRODUCTS CALL  
 UNITED STATES  
 1-800-346-4175 (LONDONDERRY, NH)  
 CANADA:  
 1-800-361-6975 (QUEBEC)  
 1-800-387-6487 (ALL OTHER PROVINCES)  
 FOR PRODUCT INFO: <http://www.burndy.com>

HYLUG™ COPPER

ITEM NO:	N/A
CAT. NO:	YA-L-TC- & YA-L- (TABLE)
DRAWN BY:	J MICHAUD 12/06/94
CHECKER:	D FELLION 12/08/94
DSN APPVL:	C PALAGI 12/09/94
MFG APPVL:	-- --
QA APPVL:	C ACKERMAN 12/23/94
MKT APPVL:	T NELSON 12/15/94
PROD FAM:	CM&R COMPRESSION
PROJECT #:	--
DOCUMENT TYPE:	Sales
REL LEVEL:	Released

**BURNDY**

SCALE: 1:1  
 DRAWING NO: SE209240  
 SHEET 4 OF 38

REV: PE0200