

DRAWING NO.
SE209343-01

CATALOG NUMBER	STRANDED COPPER CONDUCTOR ACCOMMODATED			BOLT SIZE	METRIC BOLT SIZE	DIMENSIONS							
	FLEXIBLE CABLE CODE (AWG)	NAVY	METRIC SIZE (CLASS 2)			B	C	K DIA.	L	N	O.D.	T REF	Z MIN
YAG1C-TC14-LD	AWG #1 STR CU	75	-----	1/4	M6	1.38 [35]	.75 [19]	.27 [7]	2.44 [62]	.31 [8]	.47 [12]	.12 [3]	.33 [8]
YAG1C-TC516-LD	AWG #1 FLEX CU (225/24)			5/16	-----	1.38 [35]	.75 [19]	.33 [8]	2.50 [64]	.34 [9]	.47 [12]	.12 [3]	.36 [9]
YAG25-TC14-LD	AWG 1/0 STR CU	100	-----	1/4	M6	1.50 [38]	.83 [21]	.27 [7]	2.58 [66]	.31 [8]	.52 [13]	.12 [3]	.33 [8]
YAG25-TC516-LD	AWG 1/0 FLEX CU (275/24)			5/16	-----	1.50 [38]	.83 [21]	.33 [8]	2.65 [67]	.34 [9]	.52 [13]	.12 [3]	.36 [9]
YAV28-TC516-LD	AWG 4/0 STR CU	200	-----	5/16	-----	1.62 [41]	1.14 [29]	.33 [8]	2.93 [74]	.34 [9]	.77 [20]	.14 [4]	.36 [9]
	AWG 4/0 FLEX CU (550/24)												

REV.	DATE	DESCRIPTION	ECO	BY	C'K'D.
A	10/24/05	CHANGE DIM. 'B' AND 'L' PER M/U.	11563	RB	PL

CONNECTOR SIZE	TOLERANCES					
	B	C	K DIA.	L	N	O.D.
-8C THRU -25	±.06	+04 -.02	±.02	±.09	±.03	±.01
-26 THRU -34	±.06	+04 -.03	±.02	±.12	±.03	±.01

TOLERANCE BLOCK

INSTALLATION TOOLING (# CRIMPS)

CATALOG NO.	COLOR CODE	DIE INFORMATION		MECHANICAL RATCHET				HYDRAULIC				DIELESS (# CRIMPS)	WIRE STRIP LENGTH		
		DIE INDEX	TYPE	Y2MR	OUR840	MD6 MD7	MD6--R2 BAT500	MD7-34R	Y34A Y34B Y34BH	Y35, Y39 Y750, BAT35 BAT750	Y46			Y45	Y48B
YAG1C-	GREEN	11 375	GREEN DIE SET	-----	X1CRT-1 (2)	W1CRT-1(2) W1CVT(2)	W1CRT-1(2) W1CVT(2)	W1CRT-1(2) W1CVT(2)	-----	U1CRT-1(2) U4CABT(2)	U1CRT-1(2) U4CABT(2)	U1CRT-1(2) U4CABT(2)	-----	MECHANICAL: MY29-3(2) MY29-11(2)	1-7/16"
			NEST	-----	-----	-----	-----	B1CD(2) A1CD(2)	U1CD-1(2)	U1CD-1(2)	U1CD-1(2)	-----	-----		
			INDENTOR	-----	-----	-----	-----	Y34PR	Y34PR	Y34PR	Y34PR	-----	-----		
YAG25-	PINK	12 348	PINK DIE SET	-----	X25RT(4)	W25RT(4) W25VT(4)	W25RT(4) W25VT(4)	W25RT(4) W25VT(4)	A25R(2)	U25RT(2) U2CABT(2)	U25RT(2) U2CABT(2)	U25RT(2) U2CABT(2)	-----	HYDRAULIC: Y644M(1) BAT644M(1)	1-7/16"
			NEST	-----	-----	-----	-----	B25D(2) A25D(2)	U25D-1(2)	U25D-1(2)	U25D-1(2)	-----	-----		
			INDENTOR	-----	-----	-----	-----	Y34PR	Y34PR	Y34PR	Y34PR	-----	-----		
YAV28-	PURPLE	15	PURPLE DIE SET	-----	-----	W28RT(4) W28VT(4)	W28RT(4) W28VT(4)	W28RT(4) W28VT(4)	-----	U28RT(2)	U28RT(2)	U28RT(2)	C28R(1)	1-11/16"	
			NEST	-----	-----	-----	-----	B28D(2) A28D(2)	U28D-1(2)	U28D-1(2)	U28D-1(2)	C28D(1)	-----		
			INDENTOR	-----	-----	-----	-----	Y34PR	Y34PR	Y34PR	Y34PR	Y48PR	-----		

NOTES:

- MATERIAL: COPPER TUBING
- FINISH: LEAD PLATED
- CATALOG # PT6515 ADAPTOR IS REQUIRED TO USE "U" DIES IN Y45 SERIES TOOLS.
- CATALOG # PUADP-1 ADAPTOR IS REQUIRED TO USE "U" DIES IN Y46 SERIES TOOLS.
- Y35P3 INDENTOR ADAPTOR REQUIRED FOR Y34PR INDENTOR.
- PERMANENT DIE IN TOOLING.
- DIMENSIONS IN BRACKETS [] ARE IN MILLIMETERS ROUNDED OFF TO THE NEAREST MILLIMETER, UNLESS OTHERWISE NOTED, AND ARE FOR REFERENCE ONLY.
- FOR USE BY CUSTOMERS THAT HAVE THIS HYPRESS.™ NO NEW Y34A HYPRESS™ TOOLS ARE BEING PROCESSED. Y34A USED A--D TYPE NEST DIES.
- CONNECTORS ARE UL LISTED; UNDRILLED VERSIONS ARE NOT UL LISTED.
- CONNECTORS ARE CSA CERTIFIED; UNDRILLED VERSIONS ARE NOT CSA CERTIFIED.
- FOR UNDRILLED VERSIONS ADD SUFFIX "-U" TO END OF CATALOG NUMBER. FOR UNDRILLED VERSIONS, USE D MIN. = N MAX. + Z MIN.
- NEST AND INDENTOR TYPE DIES ARE NOT COLOR CODED.
- FLEX TUBING IS THE SAME STYLE AS THE YAG'S.

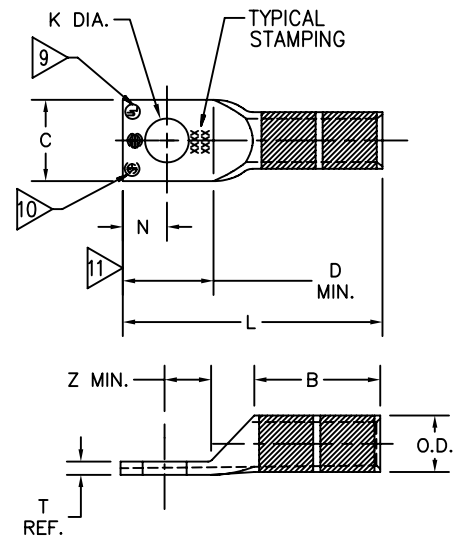

TO ORDER BURNDY*PRODUCTS CALL 1-800-346-4175
MANCHESTER, NH 03109, USA
FOR PRODUCT INFO = <http://www.fciconnect.com>

HYLUG™

ITEM NO: N/A

CAT NO: YAG-TC-LD

SCALE: 1/1

DRAWN BY: J.MICHAUD	10/07/94
CHECKER: D.FILLION	10/11/94
DSN APPV: R. MACDONALD	10/11/94
MFG APPV: N/A	---
QC APPV: D. VARIO	10/11/94
MKT APPV: T.NELSON	10/11/94

PROJ. # --- SIZE ---

DOC. TYPE: Sales

REL. LEVEL: AutoCAD

DRAWING NO: SE209343-01

REV: A

SHEET 1 of 1

