

CATALOG NUMBER	CONDUCTOR RANGE		DIMENSIONS		WIRE STRIP LENGTH		DIE NUMBER
	BARREL "A" CU & ALUM	BARREL "B" CU & ALUM	B MIN.	L	BARREL 'A'	BARREL 'B'	
YRB26U25T	2/0 (.419 DIA.) 19 STR OR 2/0 CMPCT (.376 DIA.) 19 STR	1/0 (.373 DIA.) 19 STR OR 1/0 CMPCT (.336 DIA.) 19 STR	1.53 [39]	3.69 [94]	1-5/8"	1-5/8"	298
YRB27U25T	3/0 (.470 DIA.) 19 STR OR 3/0 CMPCT (.423 DIA.) 19 STR	1/0 (.373 DIA.) 19 STR OR 1/0 CMPCT (.336 DIA.) 19 STR	↑	↓	↑	↑	↑
YRB28U3T	4/0 (.528 DIA.) 19 STR OR 4/0 CMPCT (.475 DIA.) 19 STR	#3 (.260 DIA.) 7 STR					
YRB28U2T	4/0 (.528 DIA.) 19 STR OR 4/0 CMPCT (.475 DIA.) 19 STR	#2 (.292 DIA.) 7 STR OR #2 CMPCT (.268 DIA.) 7 STR	↓	↑	↓	↓	↓
YRB28U1T	4/0 (.528 DIA.) 19 STR OR 4/0 CMPCT (.475 DIA.) 19 STR	#1 (.332 DIA.) 19 STR OR 1/0 CMPCT (.299 DIA.) 7 STR					
YRB28U25T	4/0 (.528 DIA.) 19 STR OR 4/0 CMPCT (.475 DIA.) 19 STR	1/0 (.373 DIA.) 19 STR OR 1/0 CMPCT (.336 DIA.) 19 STR					
YRB28U26T	4/0 (.528 DIA.) 19 STR OR 4/0 CMPCT (.475 DIA.) 19 STR	2/0 (.419 DIA.) 19 STR OR 2/0 CMPCT (.376 DIA.) 19 STR	1.53 [39]	3.69 [94]	1-5/8"	1-5/8"	298
YRB28U28T	4/0 (.528 DIA.) 19 STR OR 4/0 CMPCT (.475 DIA.) 19 STR	4/0 (.528 DIA.) 19 STR OR 4/0 CMPCT (.475 DIA.) 19 STR					

INSTALLATION TOOLING (# OF CRIMPS PER END)									
COLOR CODE	DIE INFORMATION		MECHANICAL		HYDRAULIC				DIELESS (# OF CRIMPS)
	DIE INDEX	TYPE	OUR840	MD6 MD7	BCT500 Y500CT PAT600	Y35, Y39 Y750, BAT35 BAT750	Y46	Y45	
WHITE	298	WHITE DIE SET	X28ART(3)	W28VT(2)	X28ART (3) W28VT (2)	U28ART(2)	U28ART(2)	U28ART(2)	MECHANICAL: MY29-3 (1) MY29-11 (1) HYDRAULIC: Y644M (1) BAT644M (1) PAT644M (1)

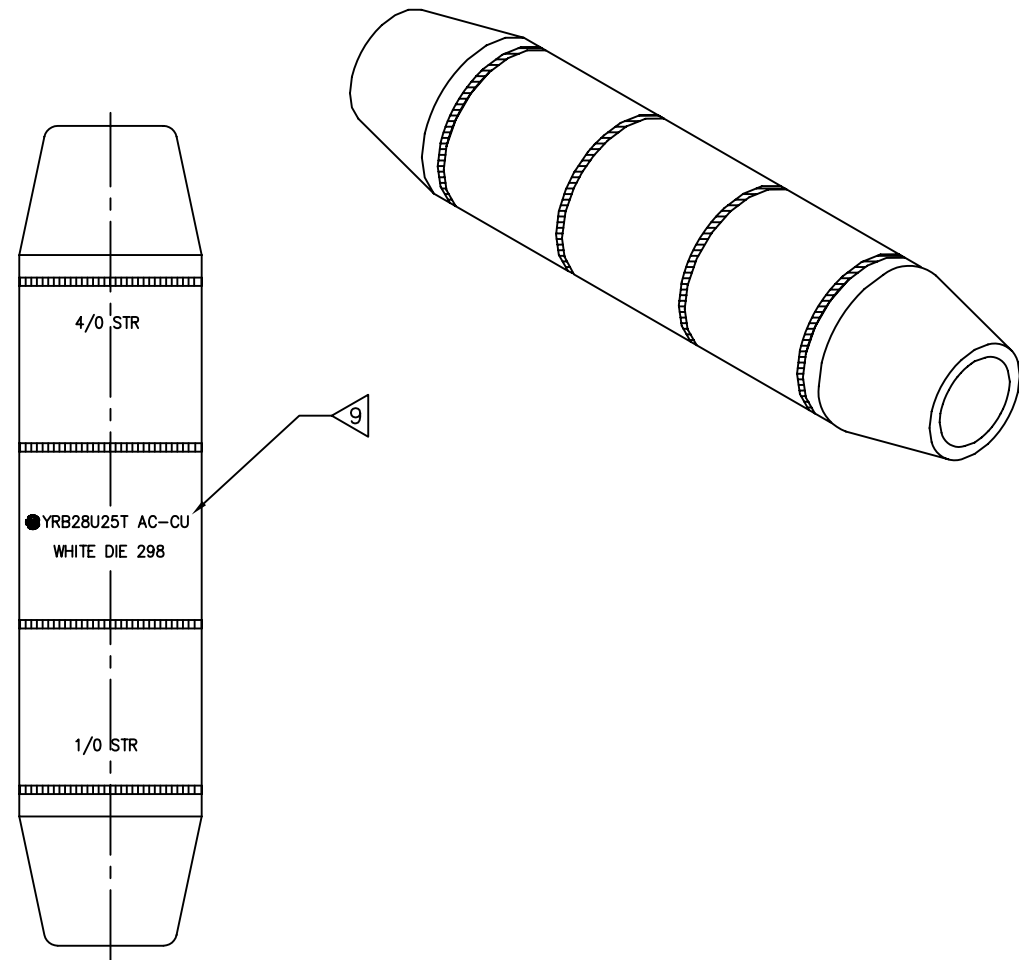
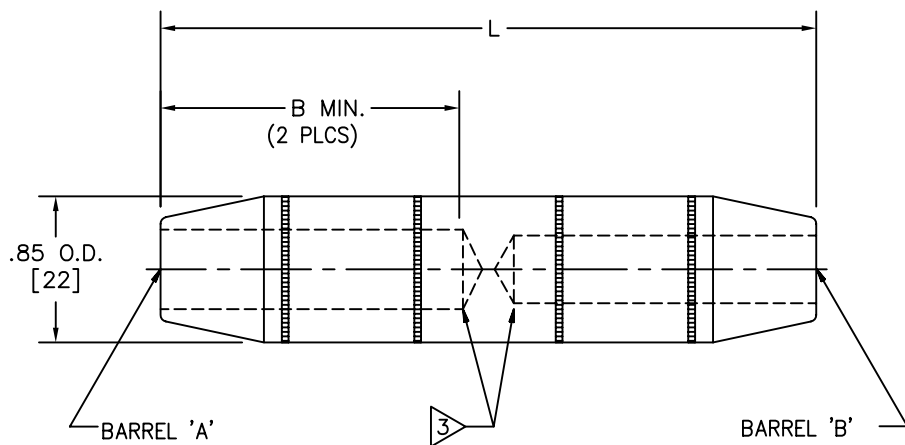

TYPICAL LETTERING VIEW

**NOTES:**

- MATERIAL: ALUMINUM
- FOR TIM PLATING ADD SUFFIX "TN" TO THE CATALOG NO. (EX. YRB27U25TTN). FOR HOT TIN DIPPED AND SUFFIX "W" TO THE CATALOG NO. (EX. YRB27U25TW).
- BARRELS ARE PARTIALLY FILLED WITH PENETROX™ AND SEALED.
- SCRATCH BRUSHING OF ALL CONDUCTORS BEFORE MAKING INSTALLATION IS RECOMMENDED.
- NOT FOR USE WITH COPPER TO COPPER APPLICATIONS.
- DIMENSIONS IN BRACKETS [ ] ARE IN MILLIMETERS ROUNDED OFF TO THE NEAREST MILLIMETER, UNLESS OTHERWISE NOTED, AND ARE FOR REFERENCE ONLY.
- CATALOG #PT6515 ADAPTOR IS REQUIRED TO USE "U" DIES IN Y45 SERIES TOOLS.
- CATALOG #PUADP-1 ADAPTOR IS REQUIRED TO USE "U" DIES IN Y46 SERIES TOOLS.
- SUFFIX "TN" AND "W" WILL NOT BE STAMPED ON PART.

TO ORDER BURNDY® PRODUCTS CALL 1-800-346-4175  
MANCHESTER, NH 03109, USA  
FOR PRODUCT INFO = <http://www.burndy.com>

**HYREDUCER™**

ITEM NO: N/A

CAT NO: YRB--U--T (TABLE)

SCALE: 1/1

DRAWN BY: R. BOISVERT	7/20/98
CHECKER: J. MICHAUD	08/05/04
DSN APPVL: D. WALTERS	07/13/98
MFG APPVL: N/A	--
QC APPVL: S. GRAY	07/14/98
MKT APPVL: B. HARGROVE	07/14/98

PROD FAM: --

DRAWING NO: SE211534

REV: C

PROJECT #: --

DOCUMENT TYPE: Sales

REL LEVEL: AutoCAD

SIZE: D

SHEET 2 OF 5

REV.	DATE	DESCRIPTION	ECO	BY	C'K'D
C	6/13/07	ADDED CAT. # YRB26U25T TO TABLE	14227	PL	RLB