

DRAWING NO.
SE211534

| CATALOG NUMBER | CONDUCTOR RANGE | | DIMENSIONS | | WIRE STRIP LENGTH | | DIE NUMBER |
|----------------|--|--|--------------|---------------|-------------------|---------------|------------|
| | BARREL "A" CU & ALUM | BARREL "B" CU & ALUM | B MIN. | L | BARREL "A" | BARREL "B" | |
| YRB29U25TW | 250 kcmil (.575 DIA) 37 STR | 1/0 (.373 DIA) 19 STR OR 1/0 CMPCT (.336 DIA) 19 STR | 2.34 [59] | 5.43 [138] | 2-1/2" | 2-1/2" | 299 |
| YRB29U28TW | 250 kcmil (.575 DIA) 37 STR | 4/0 (.528 DIA) 19 STR | 2.34 [59] | 5.43 [138] | 2-1/2" | 2-1/2" | 299 |
| YRB31U25T | 350 kcmil (.681 DIA) 37 STR OR 350 kcmil CMPCT (.616 DIA) 19 STR ALUM; 37 STR ALUM & CU | 1/0 (.373 DIA.) 19 STR OR 1/0 CMPCT (.336 DIA.) 19 STR | 2.34 [59] | 5.43 [138] | 2-1/2" | 2-1/2" | 299 |
| YRB31U28T | 350 kcmil (.681 DIA) 37 STR OR 350 kcmil CMPCT (.616 DIA) 19 STR ALUM; 37 STR ALUM & CU | 4/0 (.528 DIA) 19 STR OR 250 kcmil CMPCT (.520 DIA) 37 STR | 2.34 [59] | 5.43 [138] | 2-1/2" | 2-1/2" | 299 |
| YRB31U29T | 350 kcmil (.681 DIA) 37 STR OR 350 kcmil CMPCT (.616 DIA) 19 STR ALUM; 37 STR ALUM & CU | 250 kcmil (.575 DIA) 37 STR | 2.34 [59] | 5.43 [138] | 2-1/2" | 2-1/2" | 299 |
| YRB31U31T | 350 kcmil (.681 DIA) 37 STR OR 350 kcmil CMPCT (.616 DIA) 19 STR ALUM; 37 STR ALUM & CU | 350 kcmil (.681 DIA) 37 STR OR 350 kcmil CMPCT (.616 DIA) 19 STR ALUM; 37 STR ALUM & CU | 2.34 [59] | 5.43 [138] | 2-1/2" | 2-1/2" | 299 |

| INSTALLATION TOOLING (# OF CRIMPS PER END) | | | | | | | | |
|--|-----------------|---------------|---|-------------------------|-------------------------|----------|-----------------------|--------------------------------------|
| COLOR CODE | DIE INFORMATION | | HYDRAULIC | | | | DIELESS (# OF CRIMPS) | |
| | DIE INDEX | TYPE | Y35, Y39 Y750, BAT35 BAT750, PAT750 | Y46 | Y45 | Y48B | | Y60BHU |
| BROWN | 299 | BROWN DIE SET | U31ART OVERLAP CRIMP | U31ART OVERLAP CRIMP | U31ART OVERLAP CRIMP | C31AR(1) | L31ART(1) | HYDRAULIC: Y644M(1) BAT644M(1) |

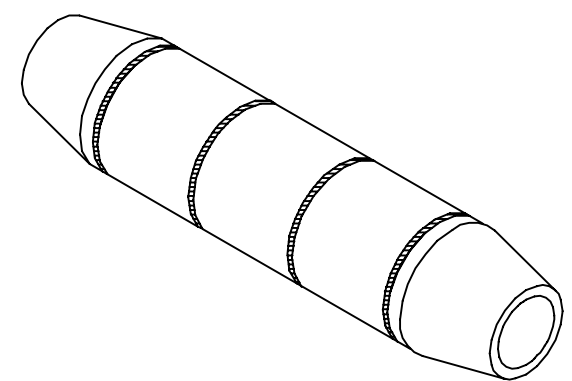
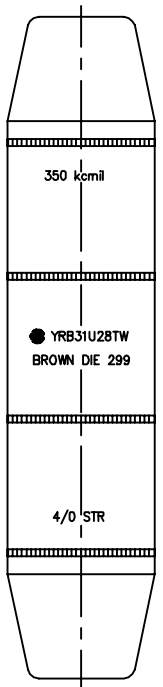
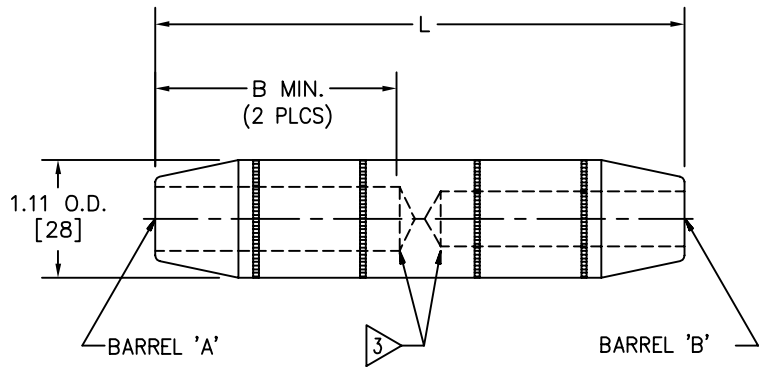

TYPICAL LETTERING VIEW

NOTES:

- MATERIAL: ALUMINUM
- FOR TIN PLATING ADD SUFFIX "TN" TO THE CATALOG NO. (EX. YRB31U25TTN). FOR HOT TIN DIPPED AND SUFFIX "W" TO THE CATALOG NO. (EX. YRB27U25TW).
- BARRELS ARE PARTIALLY FILLED WITH PENETROX™ AND SEALED.
- SCRATCH BRUSHING OF ALL CONDUCTORS BEFORE MAKING INSTALLATION IS RECOMMENDED.
- NOT FOR USE WITH COPPER TO COPPER APPLICATIONS.
- DIMENSIONS IN BRACKETS [] ARE IN MILLIMETERS ROUNDED OFF TO THE NEAREST MILLIMETER, UNLESS OTHERWISE NOTED, AND ARE FOR REFERENCE ONLY.
- CATALOG #PT6515 ADAPTOR IS REQUIRED TO USE "U" DIES IN Y45 SERIES TOOLS.
- CATALOG #PUADP-1 ADAPTOR IS REQUIRED TO USE "U" DIES IN Y46 SERIES TOOLS.

| | | | |
|---|--|---------------|--|
| TO ORDER BURNDY® PRODUCTS CALL UNITED STATES: 1-800-346-4175 (LONDONDERRY, NH) CANADA: 1-800-361-6975 (QUEBEC) 1-800-387-6487 (ALL OTHER PROVINCES) FOR PRODUCT INFO: http://www.burndy.com | | HYREDUCER™ | |
| | | ITEM NO: N/A | |
| CAT NO: YRB--U--TW (TABLE) | | SCALE: 1/1 | |
| DRAWN BY: R.BOISVERT 7/20/98 | | BURNDY | |
| CHECKER: J.MICHAUD 08/05/04 | | | |
| DSN APPVL: D.WALTERS 07/13/98 | | DRAWING NO | |
| MFG APPVL: N/A | | REV | |
| QC APPVL: S.GRAY 07/14/98 | | SE211534 | |
| MKT APPVL: B.HARGROVE 07/14/98 | | SHEET 3 OF 5 | |
| PROJECT #: -- | | D | |
| DOCUMENT TYPE: Sales | | | |
| REL LEVEL: Released | | | |

| REV. | DATE | DESCRIPTION | ECO | BY | C'K'D. |
|------|------------|------------------------------|-------|----|--------|
| D | 12/10/2015 | FOCUS REQUEST PIN FPN1512018 | 42398 | AV | MB |