

REV	DATE	DESCRIPTION	ECO	BY	C'H'K.
B	1/11/2001 12:00:00 AM	REDRAW AND CATALOG NUMBER UPDATON OF SALES DRAWINGS	17057	BSB	BSK

CATALOG NO.	CONDUCTOR		BOLT SIZE	FIG. NO.	DIMENSIONS										INSTALLATION TOOLING (# CRIMPS)										
	FLEX	CODE (AWG)			B	C	E	H	K DIA.	L	N	O.D.	T REF.	Y MIN.	DIE INDEX	COLOR CODE	MECHANICAL				HYDRAULIC			DIELESS (# CRIMPS)	WIRE STRIP LENGTH
																	MD7-34R	OUR840	Y2MR	BCT500 Y500CT	Y750 Y35, BAT35 Y39, BAT750	Y46	Y45		
YAZV2C2TC516FX	#2 WELD 125/24 150/24	#2 AWG	5/16 [M8]	1	1.38	.68	1.00	---	.33	3.45	.34	.46	.10	1.37	10	BROWN	7	7	BROWN (4)	7	7	7	7	MECHANICAL: MY29-11 (1) HYDRAULIC: Y644, Y644M Y644MBH, (1)	1-7/16
YAZV2C2TC516FX45					1.57			3.19		1.37															
YAZV2C2TC516FX90					1.90			2.04		1.37															
YAZV2C2TC38FX	#2 WELD 125/24 150/24	#2 AWG	3/8 [M10]	1	1.38	.68	1.00	---	.40	3.57	.41	.46	.10	1.37	10	BROWN	7	7	BROWN (4)	7	7	7	MECHANICAL: MY29-11 (1) HYDRAULIC: Y644, Y644M Y644MBH, (1)	1-7/16	
YAZV2C2TC38FX45					1.57			3.31		1.37															
YAZV2C2TC38FX90					1.90			2.17		1.37															

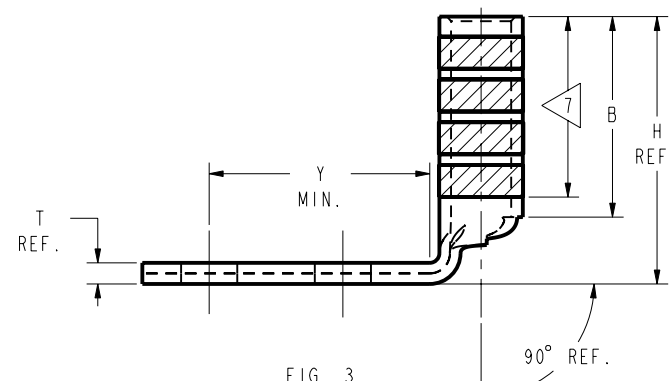
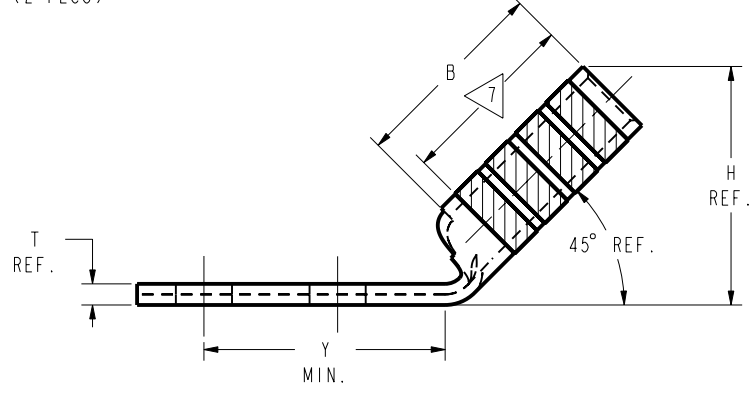
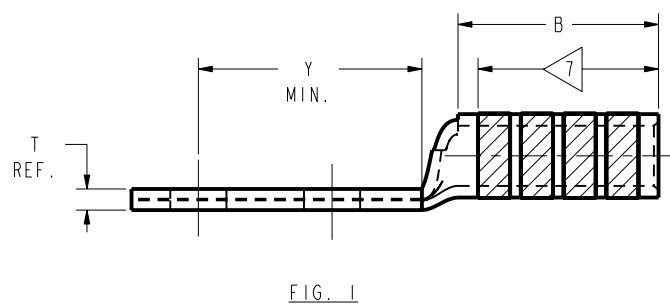
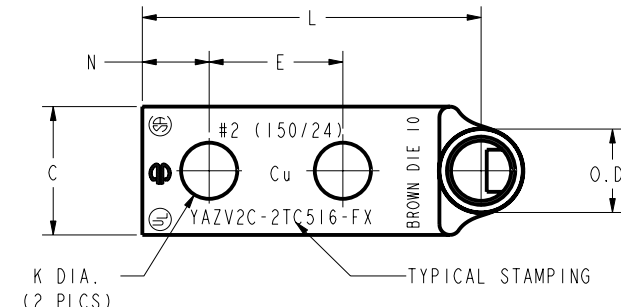
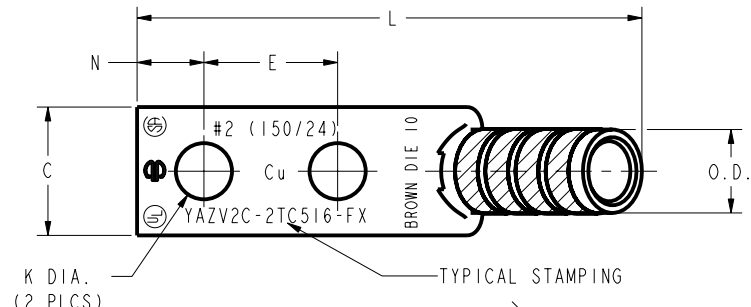
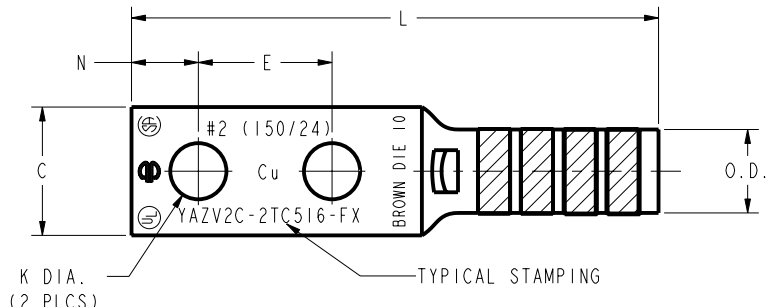

NOTES:

- MATERIAL: COPPER TUBING.
- FINISH: TIN PLATED.
- CATALOG # PT6515 ADAPTOR IS REQUIRED TO USE "U" DIES IN Y45 SERIES TOOLS.
- CATALOG # PUADP-1 ADAPTOR IS REQUIRED TO USE "U" DIES IN Y46 SERIES TOOLS.
- PERMANENT DIE IN TOOLING.
- DIMENSIONS IN BRACKETS [] ARE IN MILLIMETERS ROUNDED OFF TO THE NEAREST MILLIMETER, UNLESS OTHERWISE NOTED, AND ARE FOR REFERENCE ONLY.
- CRIMP (# OF CRIMPS PER TABLE) WITHIN THE LENGTH BETWEEN THE INK STAMPED CRIMPING AREA.

TO ORDER BURNDY® PRODUCTS CALL UNITED STATES 1-800-346-4175 (LONDONDERRY, NH) CANADA: 1-800-361-6975 (QUEBEC) 1-800-387-6487 (ALL OTHER PROVINCES)	HYLUG™ (TWO HOLE FLEX)	
	ITEM NO: N/A	SCALE: NTS
	CAT. NO: YAZV2C- (TABLE)	PROJ. NO: ---
	DRAWN BY: D BOISVERT 8/19/99	SIZE: D
	CHECKER: K HENRY 8/26/00	DRAWING NO: SE212273
DSN APPVL: RR TEAM 9/28/00	REV: B	
MFG APPVL: ---	SHEET 14 OF 48	
QA APPVL: J BRODEUR 10/6/99		
MKT APPVL: R ROBICHEAU 10/5/99		

REV: PE0200