

LINE TERMINAL DETAIL

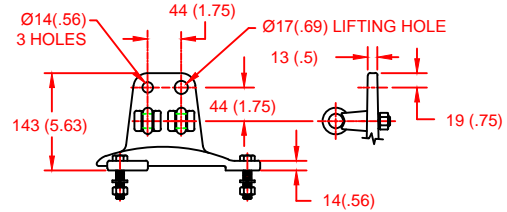

HDG 4-HOLE TERMINAL PAD, PART No. 901704001
 TWO TIN-PLATED TERMINALS, PART No. TLS89LTP
 SUITABLE FOR COPPER OR ALUMINUM CONDUCTOR SIZE
 Ø 11 (.42) - Ø 29 (1.15)
 70 - 500 sq mm
 2/0 - 1000 MCM

GROUND TERMINAL DETAIL

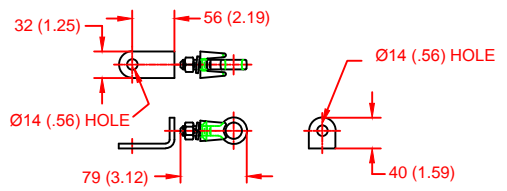

HDG TERMINAL BRACKET, PART No. 896064001
 ONE TIN-PLATED TERMINAL, PART No. TLS89LTP
 SUITABLE FOR COPPER OR ALUMINUM CONDUCTOR SIZE
 Ø 11 (.42) - Ø 29 (1.15)
 70 - 500 sq mm
 2/0 - 1000 MCM

Ø = DIAMETER
 HDG = HOT DIP GALVANIZED

CHARACTERISTICS	
RATED VOLTAGE	144 kVrms
MCOV	115 kVrms
MASS	84kg (186lb)
CREEPAGE DISTANCE	4370 (172.0)
LIGHTNING IMP W/S	680 kV
SWITCHING IMP W/S	581 kV
POWER FREQ W/S	349 kVrms
TOV 1s	168 kVrms
TOV 10s	161 kVrms
COG ABOVE BASE	715 (28.2)
HOUSING	GREY SILICONE

CANTILEVER FORCE	
MAX CONTINUOUS (MDCL)	2679 N (602lbf)
ULTIMATE	5358 N (1205lbf)

RECOMMENDED CLEARANCE (TO METAL PARTS)	
PHASE TO GROUND	645 (25.4)
PHASE TO PHASE	743 (29.3)

- NOTES:
 1. DIMENSIONS IN millimeters(inches) SUBJECT TO ±3% TOLERANCE
 2. CLEARANCE AND INSULATION W/S VOLTAGE APPLY AT SEA LEVEL
 3. ARRESTER SUITABLE FOR OPERATION AT ALTITUDES UP TO 3650m (12000ft)

DISCHARGE VOLTAGE (kV) FOR INDICATED IMPULSE TYPES AND CURRENT MAGNITUDES							
FRONT OF WAVE	SWITCHING SURGE	8/20 LIGHTNING IMPULSE					
10 kA	1 kA	1.5 kA	3 kA	5 kA	10 kA	20 kA	40 kA
363	283	296	308	318	334	357	393

IEEE C62.11
 STATION CLASS
 SURGE ARRESTER
 Program Revision
 2018.12.3.03.25.15
 REV DATE 04/14/11

CONFIDENTIAL: THIS DRAWING AND ITS CONTENTS ARE CONFIDENTIAL AND THE EXCLUSIVE PROPERTY OF HUBBELL POWER SYSTEMS. NO PUBLICATION, DISTRIBUTION OR COPIES MAY BE MADE WITHOUT THE WRITTEN CONSENT OF HUBBELL POWER SYSTEMS. HUBBELL POWER SYSTEMS UNPUBLISHED ALL RIGHTS RESERVED UNDER THE COPYRIGHT LAWS.

TITLE SVN ARRESTER 115 KV MCOV			
SIZE S	DWG NO. 191054432	CAT / PART / ASSY NO. SVN144GA115BB	REV 0
DO NOT SCALE THIS DRAWING	DRN BY NON	DATE 04/14/11	SHEET 1 OF 1

