

LINE TERMINAL DETAIL

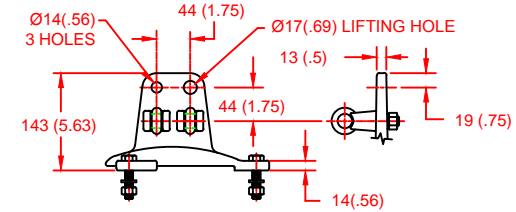

HDG 4-HOLE TERMINAL PAD, PART No. 901704001
 TWO TIN-PLATED TERMINALS, PART No. TLS89LTP
 SUITABLE FOR COPPER OR ALUMINUM CONDUCTOR SIZE
 Ø 11 (.42) - Ø 29 (1.15)
 70 - 500 sq mm
 2/0 - 1000 MCM

GROUND TERMINAL DETAIL

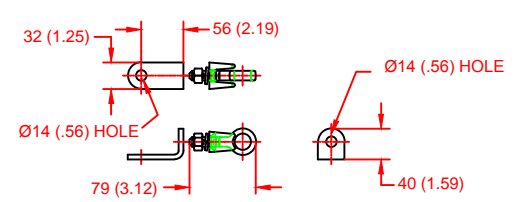

HDG TERMINAL BRACKET, PART No. 896064001
 ONE TIN-PLATED TERMINAL, PART No. TLS89LTP
 SUITABLE FOR COPPER OR ALUMINUM CONDUCTOR SIZE
 Ø 11 (.42) - Ø 29 (1.15)
 70 - 500 sq mm
 2/0 - 1000 MCM

Ø = DIAMETER
 HDG = HOT DIP GALVANIZED

CHARACTERISTICS	
RATED VOLTAGE	228 kVrms
MCOV	180 kVrms
MASS	147kg (323lb)
CREEPAGE DISTANCE	6500 (255.9)
LIGHTNING IMP W/S	1043 kV
SWITCHING IMP W/S	930 kV
POWER FREQ W/S	559 kVrms
TOV 1s	262 kVrms
TOV 10s	252 kVrms
COG ABOVE BASE	1170 (46.1)
HOUSING	GREY SILICONE

CANTILEVER FORCE	
MAX CONTINUOUS (MDCL)	1734 N (390lbf)
ULTIMATE	3468 N (780lbf)

RECOMMENDED CLEARANCE (TO METAL PARTS)	
PHASE TO GROUND	1029 (40.5)
PHASE TO PHASE	1177 (46.4)

- NOTES:
 1. DIMENSIONS IN millimeters(inches) SUBJECT TO ±3% TOLERANCE
 2. CLEARANCE AND INSULATION W/S VOLTAGE APPLY AT SEA LEVEL
 3. ARRESTER SUITABLE FOR OPERATION AT ALTITUDES UP TO 3650m (12000ft)

DISCHARGE VOLTAGE (kV) FOR INDICATED IMPULSE TYPES AND CURRENT MAGNITUDES							
FRONT OF WAVE	SWITCHING SURGE	8/20 LIGHTNING IMPULSE					
10 kA	1 kA	1.5 kA	3 kA	5 kA	10 kA	20 kA	40 kA
566	443	462	481	497	522	557	613

IEEE C62.11
 STATION CLASS
 SURGE ARRESTER
 Program Revision
 2018.12.3.03.25.15
 REV DATE 04/14/11

CONFIDENTIAL: THIS DRAWING AND ITS CONTENTS ARE CONFIDENTIAL AND THE EXCLUSIVE PROPERTY OF HUBBELL POWER SYSTEMS. NO PUBLICATION, DISTRIBUTION OR COPIES MAY BE MADE WITHOUT THE WRITTEN CONSENT OF HUBBELL POWER SYSTEMS. HUBBELL POWER SYSTEMS UNPUBLISHED ALL RIGHTS RESERVED UNDER THE COPYRIGHT LAWS.

TITLE			
SVN ARRESTER 180 KV MCOV			
SIZE	DWG NO.	CAT / PART / ASSY NO.	REV
S	191054366	SVN228GA180BB	0
DO NOT SCALE THIS DRAWING	DRN BY	DATE	SHEET
	NON	04/14/11	1 OF 1

