

**LINE TERMINAL DETAIL**

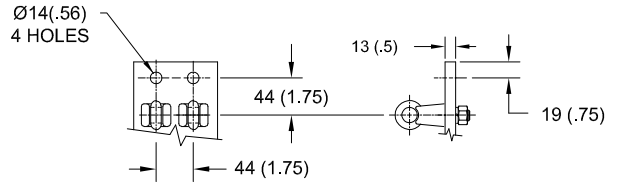

HDG 4-HOLE TERMINAL PAD, PART No. 32A161036G01  
 TWO HDG TERMINALS, PART No. 2714143001  
 SUITABLE FOR Cu OR Al CONDUCTOR SIZE  
 Ø 7 (.25) - Ø 21 (.81) DIA  
 25 - 240 sq mm  
 AWG#4 - 500 MCM

**GROUND TERMINAL DETAIL**

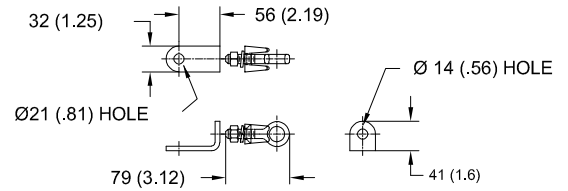

HDG TERMINAL BRACKET, PART No. 719454001  
 ONE HDG TERMINAL, PART No. 2714143001  
 SUITABLE FOR Cu OR Al CONDUCTOR SIZE  
 Ø 7 (.25) - Ø 21 (.81) DIA  
 25 - 240 sq mm  
 AWG#4 - 500 MCM

CHARACTERISTICS	
RATED VOLTAGE	468 kVrms
MCOV	372 kVrms
MASS	632 kg (1393 lb)
CREEPAGE DISTANCE	16084 (633.2)
TOV 1s NO PRIOR DUTY	558 kVrms
TOV 10s NO PRIOR DUTY	534 kVrms
TOV 1s W/PRIOR DUTY	532 kVrms
TOV 10s W/PRIOR DUTY	502 kVrms
COG ABOVE BASE	2814 (110.8)
HOUSING	GREY SILICONE
ENERGY CLASS	H-15 KJ/KV MCOV

CANTILEVER FORCE	
MAX CONTINUOUS (MDCL)	3692 N (830 lbf)
ULTIMATE	7383 N (1660 lbf)

RECOMMENDED CLEARANCE (TO METAL PARTS)	
PHASE TO GROUND	2170 (85.4)
PHASE TO PHASE	2467 (97.1)

- NOTES:  
 1. DIMENSIONS IN millimeters(inches) SUBJECT TO ±3% TOLERANCE  
 2. CLEARANCE AND INSULATION W/S VOLTAGE APPLY AT SEA LEVEL  
 3. ARRESTER SUITABLE FOR OPERATION AT ALTITUDES UP TO 3650m (12000ft)

DISCHARGE VOLTAGE (kV) FOR INDICATED IMPULSE TYPES AND CURRENT MAGNITUDES							
FRONT OF WAVE	SWITCHING SURGE	8/20 LIGHTNING IMPULSE					
		1.5 kA	3 kA	5 kA	10 kA	20 kA	40 kA
15 kA	2 kA	948	992	1020	1077	1151	1241
1185	959						

IEEE C62.11  
 STATION CLASS  
 SURGE ARRESTER

CONFIDENTIAL: THIS DRAWING AND ITS CONTENTS ARE CONFIDENTIAL AND THE EXCLUSIVE PROPERTY OF HUBBELL POWER SYSTEMS. NO PUBLICATION, DISTRIBUTION OR COPIES MAY BE MADE WITHOUT THE WRITTEN CONSENT OF HUBBELL POWER SYSTEMS. HUBBELL POWER SYSTEMS UNPUBLISHED ALL RIGHTS RESERVED UNDER THE COPYRIGHT LAWS.

TITLE				<b>SVNR ARRESTER 372 KV MCOV</b>			
SIZE	DWG NO.	CAT / PART / ASSY NO.		REV			
S	--	SVNR468GA372AA		3			
DO NOT SCALE THIS DRAWING		DRN BY	RVK	DATE	10/08/18	SHEET 1 OF 1	

REV DATE **12/27/19**