

(3) 22.4 (0.88 in) X 28.4 (1.12 in) SLOTS @ 120° ON 419.1 (16.5 in) B.C.

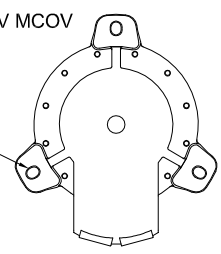

**LINE TERMINAL DETAIL**

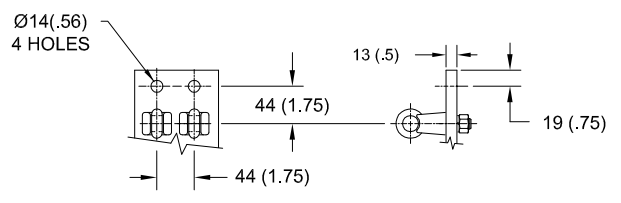

HDG 4-HOLE TERMINAL PAD, PART No. 32A161036G01  
 TWO HDG TERMINALS, PART No. 2714143001  
 SUITABLE FOR Cu OR Al CONDUCTOR  
 SIZE  
 Ø 7 (.25) - Ø 21 (.81) DIA  
 25 - 240 sq mm  
 AWG#4 - 500 MCM

**GROUND TERMINAL DETAIL**

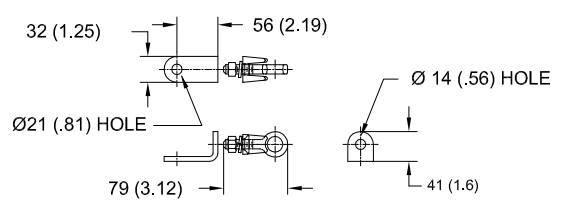

HDG TERMINAL BRACKET, PART No. 719454001  
 ONE HDG TERMINAL, PART No. 2714143001  
 SUITABLE FOR Cu OR Al CONDUCTOR  
 SIZE  
 Ø 7 (.25) - Ø 21 (.81) DIA  
 25 - 240 sq mm  
 AWG#4 - 500 MCM

**CHARACTERISTICS**

RATED VOLTAGE	444 kVrms
MCOV	353 kVrms
MASS	587 kg (1295.2lb)
CREPAGE DISTANCE	11906 (468.7)
TOV 1s NO PRIOR DUTY	513 kVrms
TOV 10s NO PRIOR DUTY	491 kVrms
TOV 1s W/PRIOR DUTY	495 kVrms
TOV 10s W/PRIOR DUTY	469 kVrms
COG ABOVE BASE	2294 (90.3)
HOUSING	GREY SILICONE

**CANTILEVER FORCE**

MAX CONTINUOUS (MDCL)	4516 N (1015 lbf)
ULTIMATE	9032 N (2030 lbf)

**RECOMMENDED CLEARANCE (TO METAL PARTS)**

PHASE TO GROUND	1901 (74.9)
PHASE TO PHASE	2163 (85.2)

- NOTES:  
 1. DIMENSIONS IN millimeters(inches) SUBJECT TO ±3% TOLERANCE  
 2. CLEARANCE AND INSULATION W/S VOLTAGE APPLY AT SEA LEVEL  
 3. ARRESTER SUITABLE FOR OPERATION AT ALTITUDES UP TO 3350m (11000ft)

DISCHARGE VOLTAGE (kV) FOR INDICATED IMPULSE TYPES AND CURRENT MAGNITUDES								
FRONT OF WAVE	SWITCHING SURGE		8/20 LIGHTNING IMPULSE					
	20 kA	2 kA	1.5 kA	3 kA	5 kA	10 kA	20 kA	40 kA
1077	859	853	882	910	954	1011	1082	

IEEE C62.11  
 STATION CLASS  
 SURGE ARRESTER

CONFIDENTIAL: THIS DRAWING AND ITS CONTENTS ARE CONFIDENTIAL AND THE EXCLUSIVE PROPERTY OF HUBBELL POWER SYSTEMS. NO PUBLICATION, DISTRIBUTION OR COPIES MAY BE MADE WITHOUT THE WRITTEN CONSENT OF HUBBELL POWER SYSTEMS. HUBBELL POWER SYSTEMS UNPUBLISHED ALL RIGHTS RESERVED UNDER THE COPYRIGHT LAWS.

TITLE **SVNX ARRESTER**  
**353 KV MCOV**

SIZE	DWG NO.	CAT / PART / ASSY NO.	REV
S	--	SVNX444GA353AA	2
DO NOT SCALE THIS DRAWING	DRN BY RVK	DATE 11/04/14	SHEET 1 OF 1

REV DATE **10/13/17**

