

ZONE	REV	DESCRIPTION	DRAWN BY	DATE	APPR.
A		Modifications à la géométrie de l'isolateur	SR	12/06/11	SR
B		Rejete sans description	SR	02/09/10	SR
C		Modif. rayon R80	SR	12/20/10	SR
D		Update actual leakage distance	SR	2002/11	SR
E		Complete update of drawing	SR	3/10/02	SR

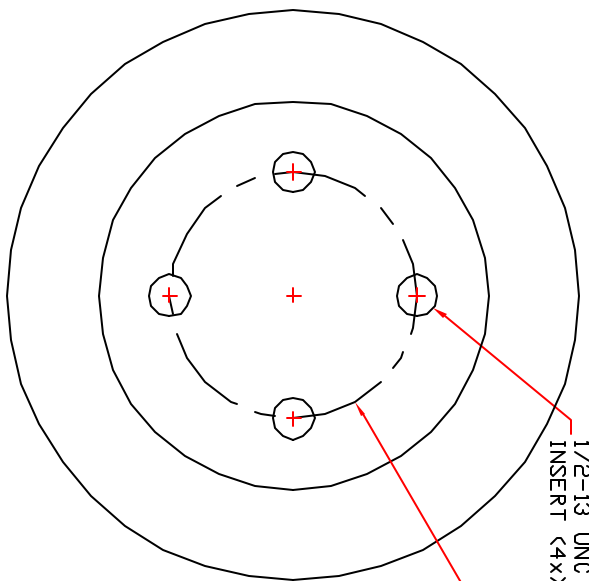
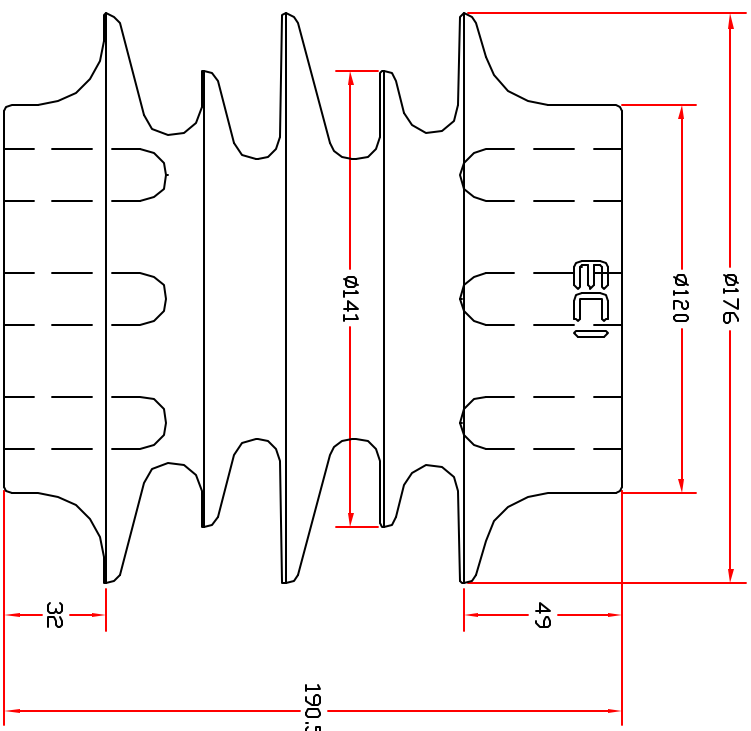

TOP AND BOTTOM FACES

Model	T202A
Physical Characteristics	
Height - in[mm]	7.5 [194.0.81]
Major Diameter - in[mm]	6.9 [178.1.81]
Head Diameter - in[mm]	4.7 [120.4.1.81]
Weight - lbs[kg]	9.5 [4.340.21]
Color	grey
Electrical Properties	
BL - kV	95
Leakage Distance - in[mm]	16.86 [428.45]
Dry Arc Distance - in[mm]	8.37 [213.42]
No. of Sheds	5
Minimum Mechanical Properties	
Compressive - lbs[kN]	10,000 [44.5]
Cantilever - lbs[kN]	2,000 [8.91]
Torsional - lbs-in[N-m]	6,000 [67.8]
Tensile - lbs[kN]	7,000 [31.1]

- NOTES:
- 1- SPECIFICATIONS IN ACCORDANCE WITH ANSI C29.9.
 - 2- TESTED IN ACCORDANCE WITH ANSI C29.1.
 - 3- MECHANICAL PROPERTIES ARE FOR BOLT PATTERN AS SHOWN.
 - 4- BRASS INSERTS AVAILABLE UPON REQUEST.

This drawing is the proprietary property of Electro Composites Inc, not part of the public domain, and is issued with the express understanding and agreement that it is not to be reproduced or copied in whole or in part or issued for furnishing information to others, or used directly or indirectly, in any way detrimental to the interest of Electro Composites Inc, and is to be returned upon request by Electro Composites Inc. All Rights Reserved.

ITEM NO.	QTY	DESCRIPTION	PART NO.	PARTS LIST
3	4	S-1001-593		TOP INSERTS 1/2-13x30mm
2	4	S-1001-593		BOLT INSERTS 1/2-13x50mm
1	1	S-1001-694		BODY: CYCLOALIPHATIC RESIN

GENERAL TOLERANCES UNLESS OTHERWISE SPECIFIED

X ±.16
 XX ±.04
 XXX ±.04
 ANGLES 45°
 RADIUS R1.5
 REMOVE BURRS AND BREAK SHARP EDGES

DIMENSIONS ARE IN MILLIMETERS (UNLESS OTHERWISE SPECIFIED)

CUSTOMER: ---

DATE: 08/05/26

SCALE: NONE

GENERATED BY: S-1001-694

PAGE: 1 OF 1

REVISIONS: E

TITLE: OUTDOOR APPARATUS INSULATOR
 ANSI C29.9 - T202A

SCALE: NONE

GENERATED BY: S-1001-694

PAGE: 1 OF 1