

ZONE		REV.	DESCRIPTION	DRAWN BY	DATE	APPR.
			GENERAL UPDATE OF THE DRAWING TO THE NEW STANDARD.	J. CLICHE	2017-01-12	Y.V.
			THE DISTANCE BETWEEN THE TOP AND THE FIRST SHED CHANGE FROM 40.6 TO 33.4mm.			
			THE DISTANCE BETWEEN THE BOTTOM AND THE LAST SHED CHANGE FROM 31.6 TO 38.9mm			
			THE TOTAL HEIGHT OF THE INSULATOR CHANGE FROM 457.2 mm TO 457.9 mm			

- NOTES:
- SPECIFICATIONS IN ACCORDANCE WITH ANSI C29.9
  - TESTED IN ACCORDANCE WITH ANSI C29.1
  - MECHANICAL PROPERTIES ARE FOR BOLT PATTERN AS SHOWN.
  - MAX. TORQUE APPLIED ON SCREWS: 40.7 N·m / 30 lbf·ft

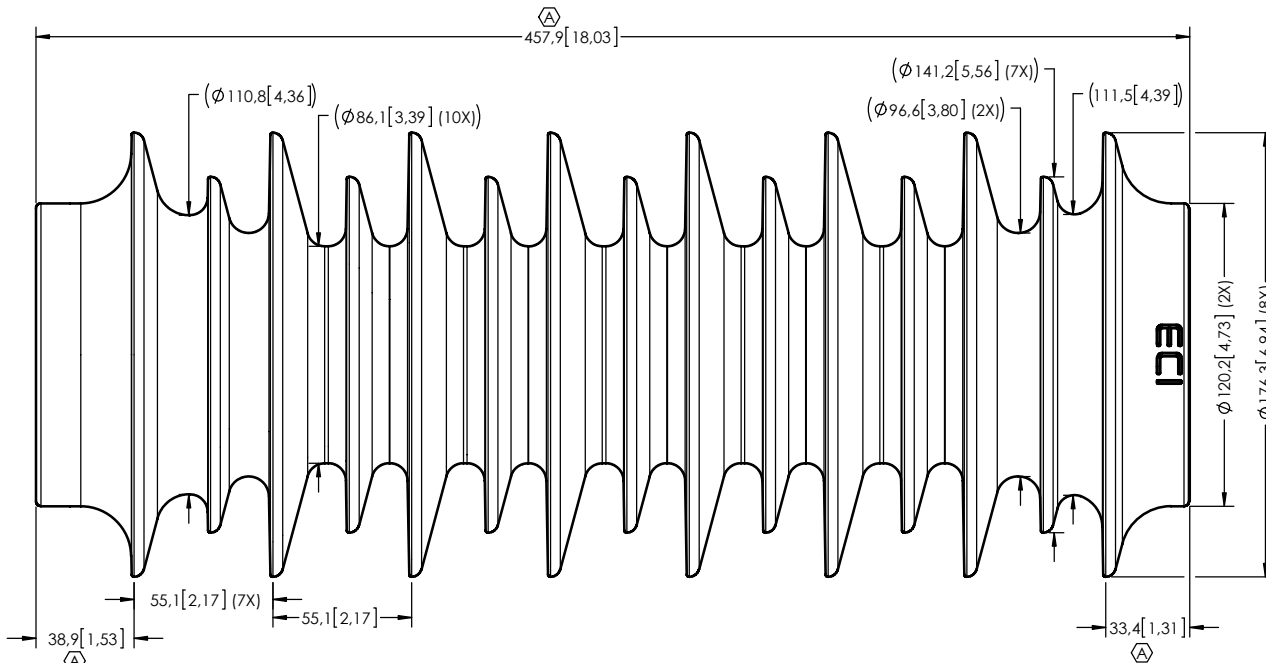

<b>Model:</b>	T210A
<b>Physical Characteristics</b>	
Height - in (mm)	18.0 (458)
Major Diameter - in(mm)	6.9 (176)
Head Diameter - in(mm)	4.7 (120)
Weight - lb(Kg)	21.5 (9.75)
Color	Grey
<b>Electrical Properties</b>	
BIL - kV	200
Leakage Distance - in (mm)	48.7 (1237)
Arc Distance - in (mm)	18.9 (480)
No. of Sheds	15
<b>Mechanical Properties</b>	
Compressive - lb (kN)	15 000 (66.7)
Cantilever - lb (kN)	2 000 (8.9)
Torsional - lb·in (N·m)	10 000 (1130)
Tensile - lb (kN)	12 000 (53.4)

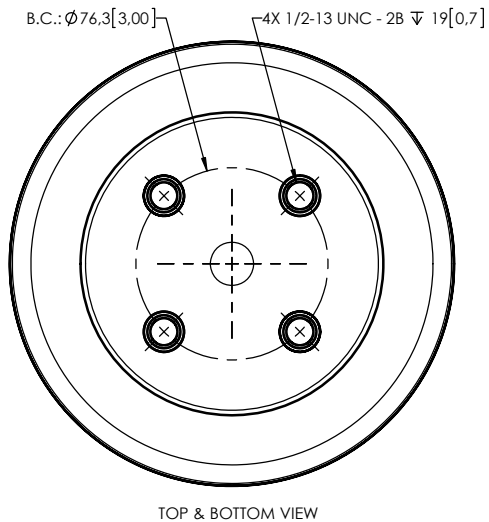
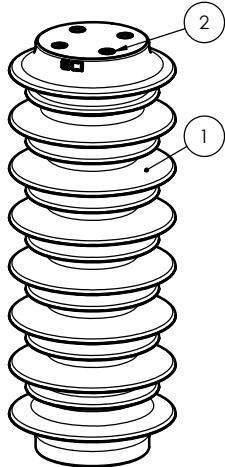

ITEM NO.	QTY	DRAWING NO.	PART NO.	DESCRIPTION	NOTE / MAT'L
2	8		S-1001-0955-001	BLIND THREADED INSERT 1/2-13 X 3/4" (50mm LONG)	STEEL
1	1	S-1001-1687		POST INSULATOR T210A, CYCLOALIPHATIC RESIN	EC-APG-02

PARTS LIST

GENERAL TOLERANCES (UNLESS OTHERWISE SPECIFIED)

X.	±1.5
.X	±0.8
.XX	±0.4
.XXX	±
.XXX	±
ANGLES	±1.0°
RADIUS	±1.0

REMOVE BURRS AND BREAK SHARP EDGES

DIMENSIONS ARE IN MILLIMETERS (UNLESS OTHERWISE SPECIFIED)

**Electro Composites**  
solid HV bushings solution

TITLE: OUTDOOR APPARATUS INSULATOR  
MODEL: T210A ANSI C29.9  
HEIGHT : 458mm (18.0 in)

DRAWN BY: S. RIOPEL DATE: 2002/06/02

CHECK BY:

PROJECTING:

PROJECT MANAGER:

FORMAT	CAGE CODE	DRAWING NO.	REVISION
A		S-1001-1687	A
SCALE	GENERATED BY:	SHEET	
1:3	SolidWorks 2013	1 of 1	

This drawing is the proprietary property of Electro Composites (2008) ULC, not part of the public domain, and is issued with the express understanding and agreement that it is not to be reproduced or copied in whole or in part or issued for furnishing information to others, or used directly or indirectly, in any way detrimental to the interest of Electro Composites (2008) ULC and is to be returned upon request by Electro Composites (2008) ULC. All Rights Reserved.