

**M-13104 2**

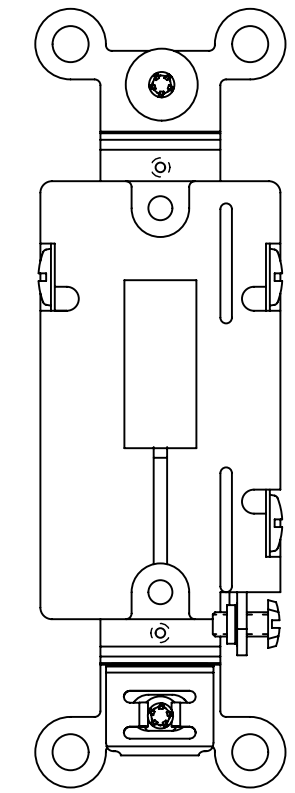
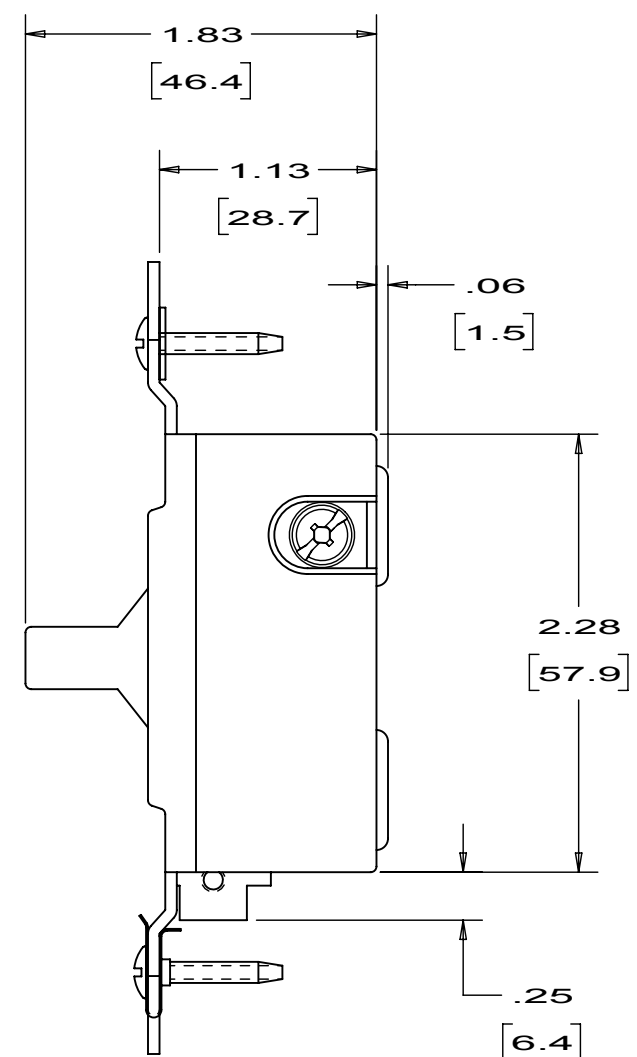
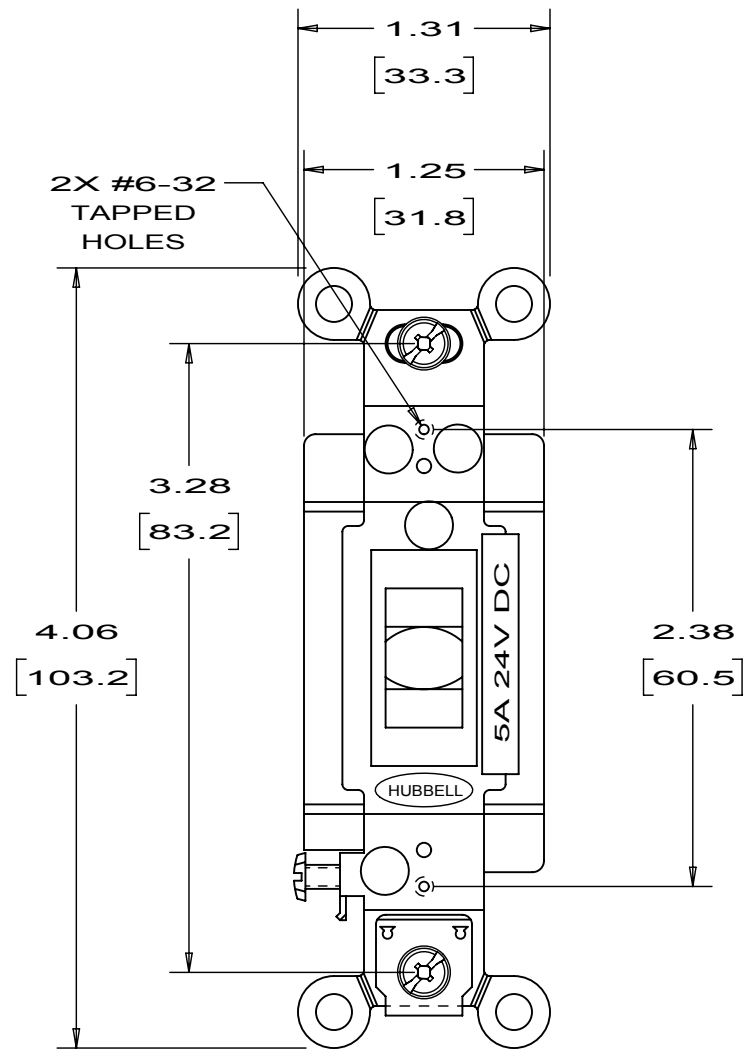

CATALOG NUMBER	TOGGLE COLOR	AMPERAGE / VOLTAGE RATING
HBL1557LV	BROWN	5A 24V DC
HBL1557GYLV	GRAY	5A 24V DC
HBL1557ILV	IVORY	5A 24V DC
HBL1557WLV	WHITE	5A 24V DC
HBL1557RLV	RED	5A 24V DC

**NOTES:**

- 1) DIMENSIONS ARE: INCHES [MM]
- 2) .XX TOLERANCE TO BE ±.03 [0.76]

LIST OF PARTS		
DESCRIPTION	MATERIAL	FINISH
HOUSING	UREA	
COVER	UREA	
TOGGLE	NYLON	
STATIONARY TERMINAL	.031 BRASS	
SPRING ARM TERMINAL	.031 BRASS	
WIRE CLAMP	.062 STEEL	TIN PLATE
BRIDGE	.050 STEEL	NICKEL PLATE
CONTACTS	SILVER/CAD. OXIDE	
BINDING SCREWS	BRASS	
MOUNTING SCREWS	STEEL	ZINC PLATE

REVISIONS	APP	DATE
2	EJM	12/13/17
1	PJB	12/04/15

SYM	REVISIONS	APP	DATE

THE DESIGN AND DIMENSIONS OF THE PRODUCT SHOWN ON THIS DRAWING ARE SUBJECT TO CHANGE WITHOUT NOTICE

**TITLE**  
LOW VOLTAGE TOGGLE SWITCH  
SINGLE POLE DOUBLE THROW  
CENTER OFF MOMENTARY

TOLERANCES UNLESS OTHERWISE SPECIFIED  .XX = ± .01 .XXX = ± .005 ANGLES = ± 2°	WIRING DEVICE-KELLEMS HUBBELL INCORPORATED SHELTON, CT	
	DR. BY DDL	APP. BY PJB
	TR. BY	SCALE 1:1
	CHK. BY PJB	DATE 12/04/15

DIMENSION SHEET FOR CAT. NO. **M-13104**  
 REPAIRABLE  NON-REPAIRABLE   
**B**  
**2**