

M-6577 1

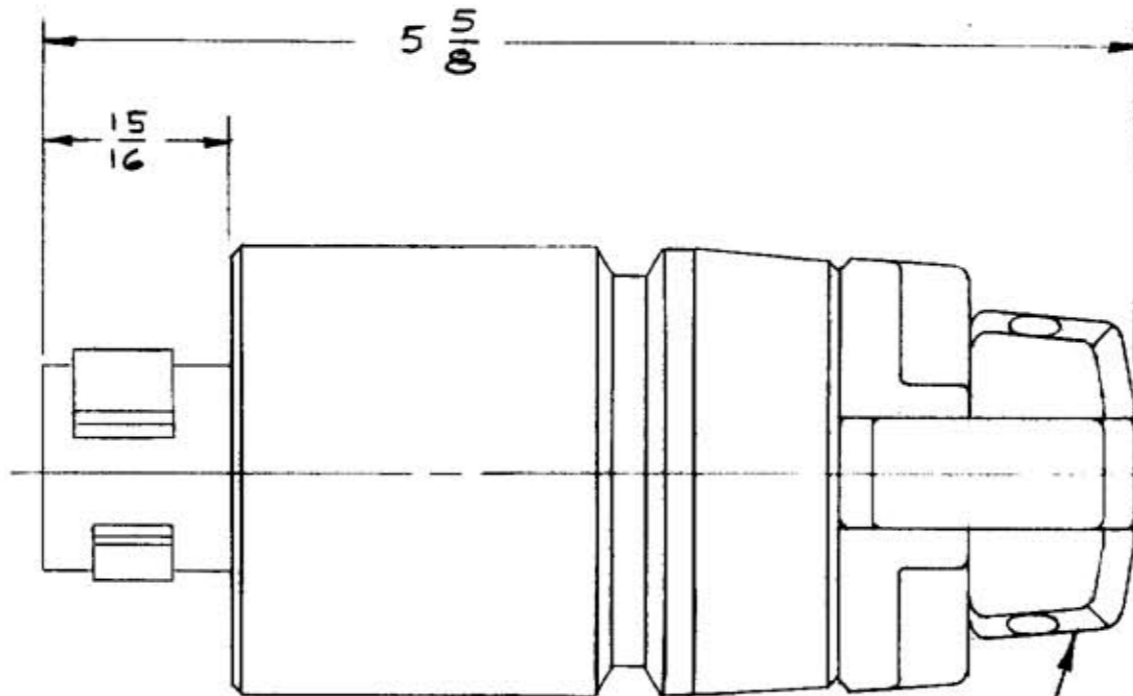
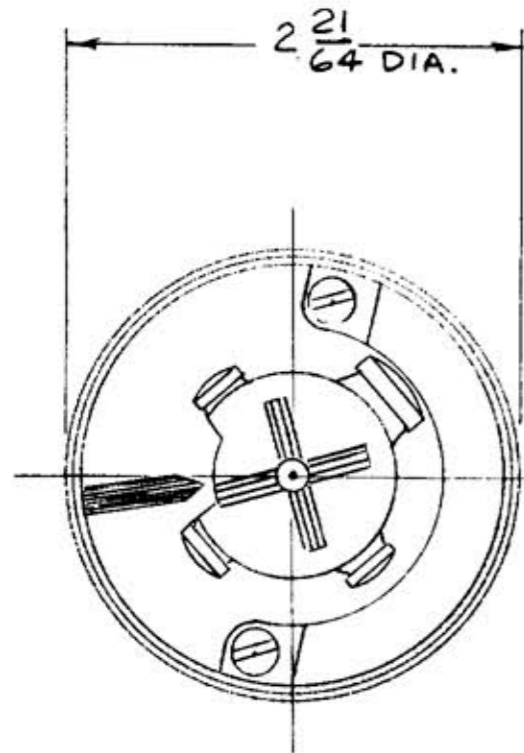

CORD GRIPS TAKE CORDS FROM .625 TO 1.050 DIA.

LIST OF PARTS

DESCRIPTION	MATERIAL	FINISH
BLADE HOLDER	PHENOLIC	BLACK
CONTACT	BRONZE	
TERMINAL	COPPER	
EYELET	BRASS	
THREADED SLUG	STEEL	ZINC PL.
HOUSING	NYLON	BLACK
GLAND CAP	NYLON	BLACK
GLAND CAP SCREW	STAIN. ST.	
MTG. SCREW	STAIN. ST.	
CORD GRIP	POLYESTER	
CORD GRIP SCREW	STAIN. ST.	
GLAND	RUBBER	BLACK

NOTE:
ON "CM" DEVICES STEEL PARTS ARE MADE OF BRASS OR STAINLESS STEEL & BRASS & COPPER PARTS ARE .0003 NICKEL PLATED.

SYM	REVISIONS	APP	DATE
1	CORD GRIP MATL. WAS NYLON REVISIONS LIBRARY ALL	MM	12-4-89

THE DESIGN AND DIMENSIONS OF THE PRODUCT SHOWN ON THIS DRAWING ARE SUBJECT TO CHANGE WITHOUT NOTICE.

TITLE
30A, 600V A.C. 20A 250V D.C.,
FOUR-WIRE HUBBELLOCK PLUG
WITH CORD GRIP

TOLERANCES UNLESS OTHERWISE SPECIFIED
 FRACTIONS ± 1/64
 DECIMALS ± .005
 ANGLES ± 2°

WIRING DEVICE DIVISION
HARVEY HUBBELL, INC.
 BRIDGEPORT, CONN.
 DR. BY AJL APP. BY _____
 TR. BY _____ SCALE FULL
 CHK'D. BY _____ DATE 6-22-87

DIMENSION SHEET FOR CAT. NO. 21415B, 21CM415B
 REPAIRABLE NON-REPAIRABLE **B**
M-6577
1