

M-7820 3

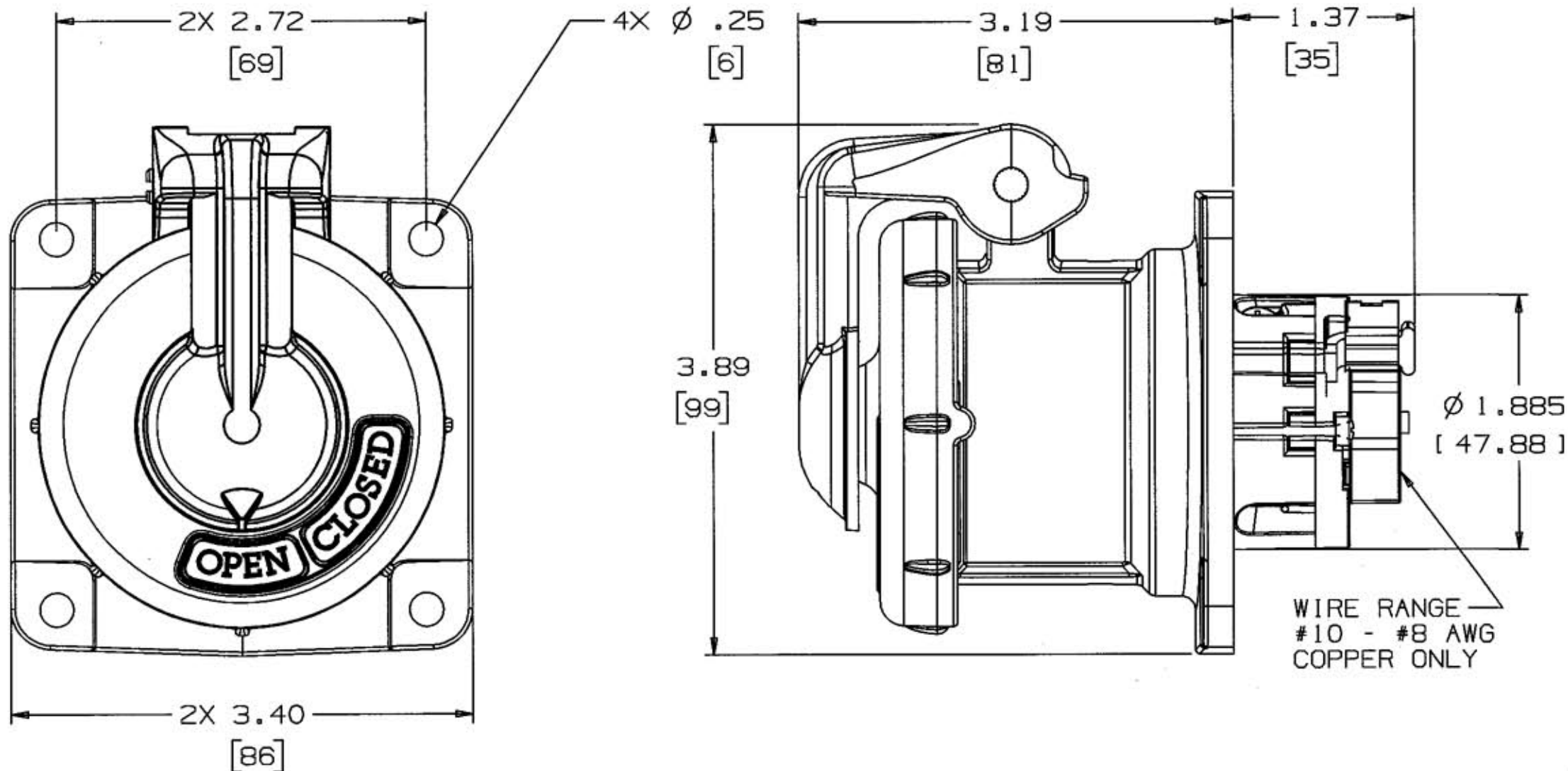

NOTES: (UNLESS OTHERWISE SPECIFIED)

1) DIMENSION FORMAT IS: INCHES
[mm]

AMPS	POLES AND WIRES	MAX VOLTAGE AC/DC	STYLE	CONNECTOR CATALOG NUMBER
30	2P3W	600/250	S1	HBL330RS1W
30	3P4W	600/250	S1	HBL430RS1W
30	4P5W	600/250	S1	HBL530RS1W
30	2P3W	600/250	S2	HBL330RS2W
30	3P4W	600/250	S2	HBL430RS2W

LIST OF PARTS

DESCRIPTION	MATERIAL	FINISH
BOX TERMINAL	STEEL	NICKEL PLATE
GROUND STANDOFF	BRASS	
GROUND BRACKET	COPPER ALLOY	NICKEL PLATE
HINGE BUSHING	ALUMINUM	
SPRING GUIDE	STAIN STEEL	
LID SPRING	STAIN STEEL	
LID	ALUMINUM	GRAY EPOXY
LID LIFTER	ALUMINUM	GRAY EPOXY
O-RING	RUBBER	
LID GASKET	RUBBER	
SPRING WASHER	STAIN STEEL	
SCREW - LID	STAIN STEEL	
WAVE SPRING	STAIN STEEL	
RIVET	ALUMINUM	
RECEPTACLE	ALUMINUM	GRAY EPOXY
SCREWS	STAIN STEEL	
INTERIOR	THERMOSET POLYESTER	
PIN SPRING	COPPER ALLOY	SILVER COATED
PINS	BRASS	

SYM	REVISIONS	APP	DATE
3	ADDED TABLE, "SEE TABLE", NOTE 1, AND Ø 1.885 [47.88]; DRAWING TITLE WAS "30A PIN & SLEEVE RECEPTACLE ASSEMBLY STYLES 1 & 2"; REMOVED "mm" FROM DIMENSIONS; ADDED "COPPER ONLY" TO "WIRE RANGE #10-#8 AWG" PER DCN #8695. JMN	TCM	1/23/02
2	DCN 5807-8 2/9/99 UPDATED LIST OF PARTS		
1	RELEASED PER DCN-5357 FMB	RDK	10/01/97

THE DESIGN AND DIMENSIONS OF THE PRODUCT SHOWN ON THIS DRAWING ARE SUBJECT TO CHANGE WITHOUT NOTICE

TITLE
30A INSULGRIP PIN & SLEEVE RECEPTACLE STYLES 1 & 2

TOLERANCES UNLESS OTHERWISE SPECIFIED
FRACTIONS ±1/64
3DECIMALS ±.005
ANGLES ±2°
2DECIMALS ±.01

WIRING DEVICE-KELLEMS HUBBELL INCORPORATED BRIDGEPORT, CT
DR. BY FMB APP. BY RDK
TR. BY SCALE 1:1
CHK'D BY RDK DATE 10/01/97