

M-12647

2

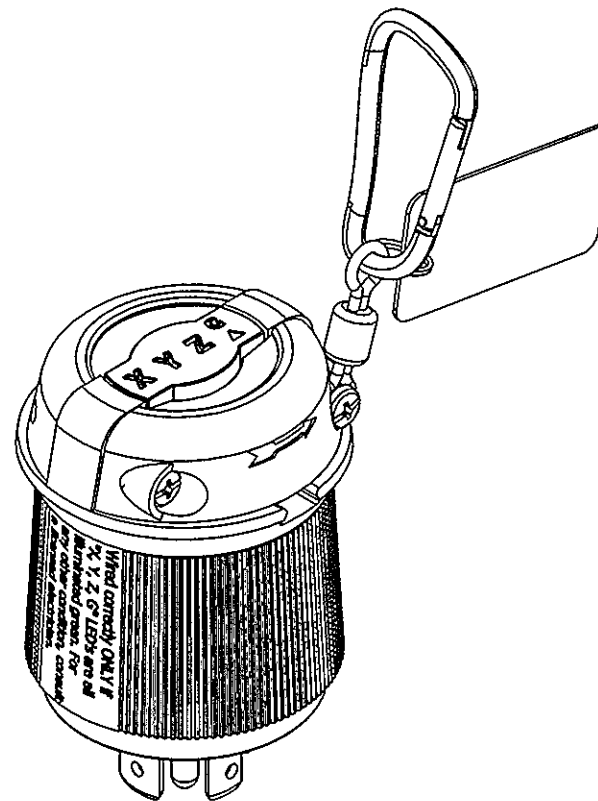
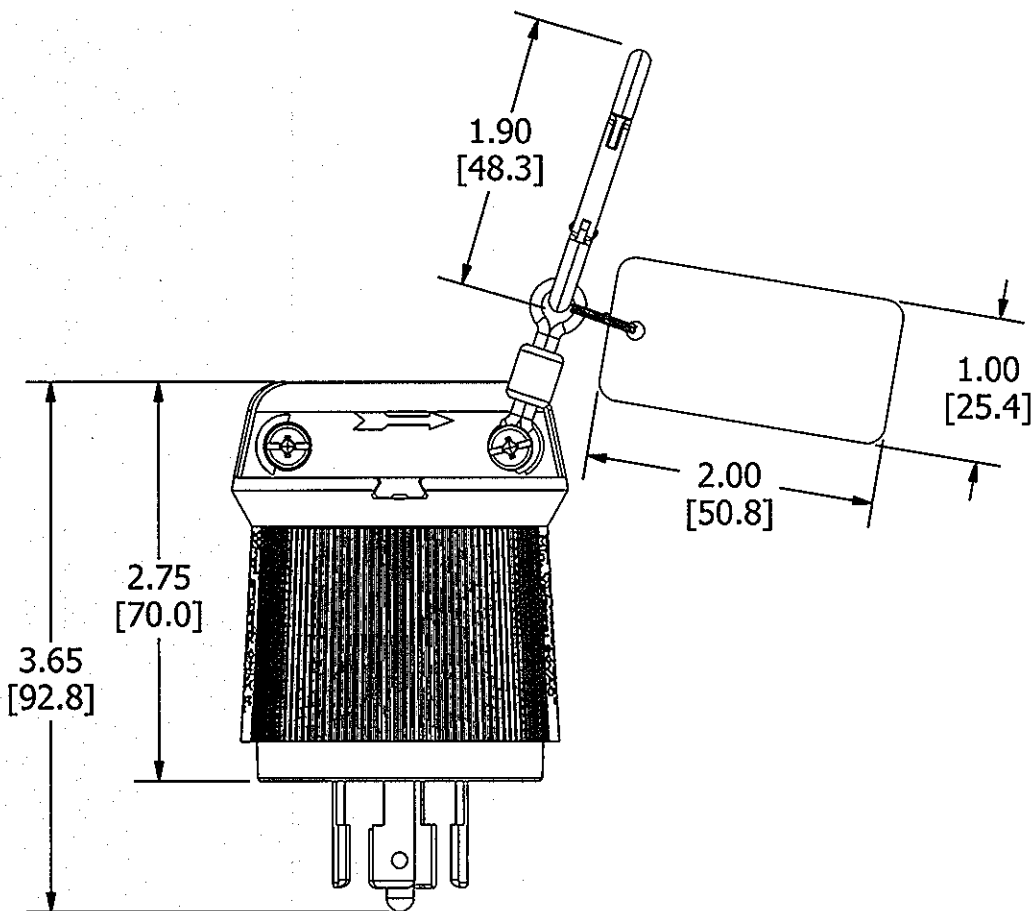
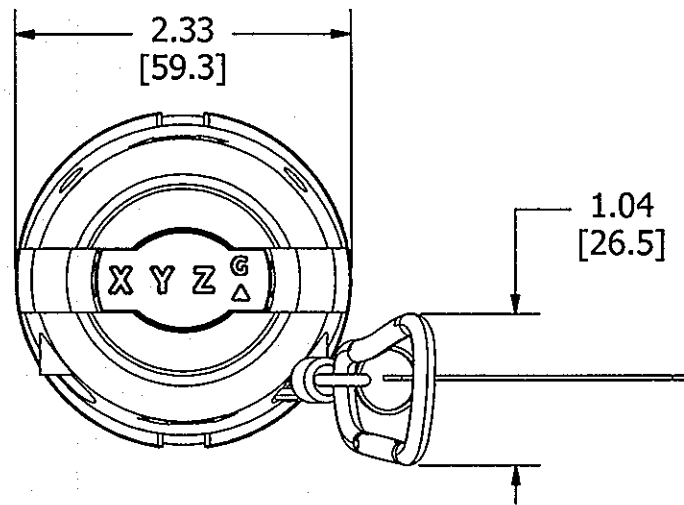

NEMA NO.	RATING	POLE/WIRE	CAT NO.	CONFIGURATION
L21-20	20A 3∅ 120/208 VAC	4P/5W GROUNDING	HBL3PT2511	
L21-30	30A 3∅ 120/208 VAC	4P/5W GROUNDING	HBL3PT2811	

CONDITIONS	X	Y	Z	G
Correct	X	Y	Z	G
Open Neutral				G
Open Ground	X	Y	Z	
Open X		Y	Z	
Open Y	X		Z	G
Open Z	X	Y		G
X & N Rev.	X	Y	Z	▲
Y & N Rev.	X	Y	Z	G ▲
Z & N Rev.	X	Y	Z	G ▲
X & G Rev.		Y	Z	G ▲
Y & G Rev.	X		Z	G ▲
Z & G Rev.	X	Y		G ▲

LIST OF PARTS

DESCRIPTION	MATERIAL	FINISH
CARABINER	ALUMINUM	ANODIZED
KEY RING	COPPER	PLATED
KEY TAG	PLASTIC	LAMINATED
LED HOUSING	NYLON 6/6	---
CORD CLAMPS	NYLON 6/6	---
CORD CLAMP SCREWS	STAINLESS STEEL	PASSIVATE
COVER	NYLON 6/6	---
BLADE HOLDER	NYLON 6/6	---
ASSEMBLY SCREWS	STAINLESS STEEL	PASSIVATE
BLADES	BRASS	PLATED

SYM	DESCRIPTION	APPROVED	DATE
2	REPLACED "HOT" WITH "X, Y & Z" IN CONDITION TABLE PER DCN # 20817	TLS	10/02/14
1	RELEASED FOR PRODUCTION PER DCN # 20723	TLS	08/14/14

THE DESIGN AND DIMENSIONS OF THE PRODUCT SHOWN ON THIS DRAWING ARE SUBJECT TO CHANGE WITHOUT NOTICE

TITLE
3 PHASE TESTER

TOLERANCES UNLESS OTHERWISE SPECIFIED		WIRING DEVICE-KELLEMS HUBBELL INCORPORATED SHELTON, CT	
FRACTIONS	±1/64	DR. BY	RGP
DECIMALS	±0.015	APP. BY	TLS
ANGLES	±2°	TR. BY	SCALE 3 : 4
		CHK'D BY	TLS
		DATE	7/24/2014

DIMENSION SHEET FOR CAT. NO. SEE TABLE

REPAIRABLE NON-REPAIRABLE

B

M-12647

2