

M-13495

1

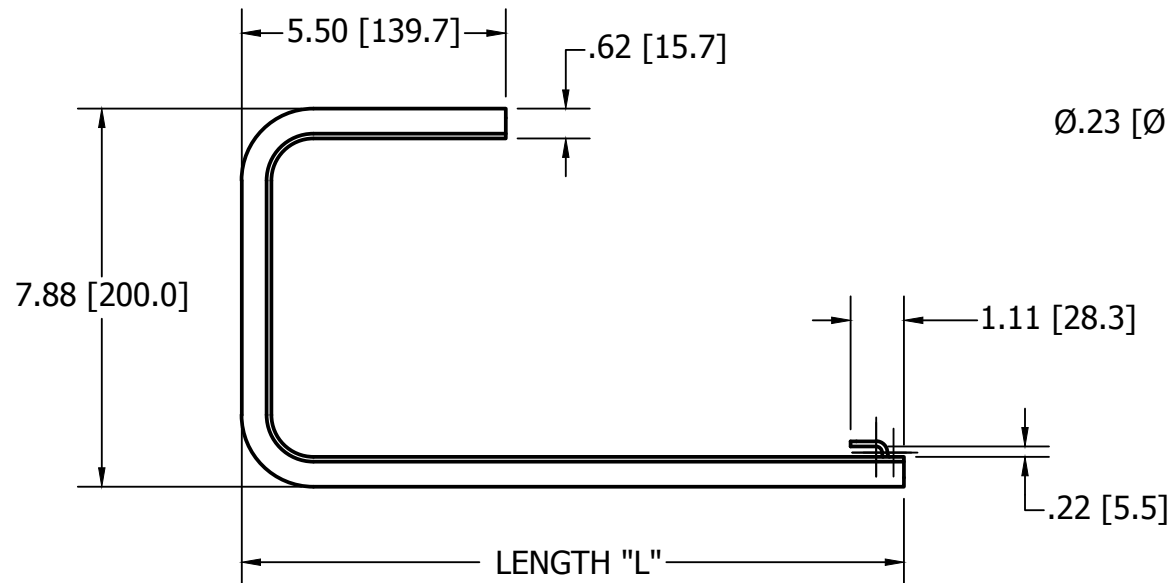

Ø.23 [Ø 5.8] X 1.18 [30] SLOT (TYP)

Ø.23 [Ø5.8] TYP.

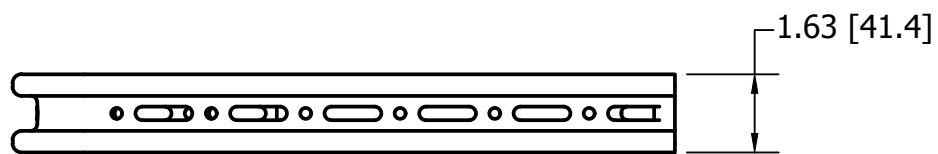

TRAY WIDTH	LENGTH "L"	PRE-GALVANIZED	BLACK POWDER COAT
4 [101.6]	5.94 [150.9]	HBTCB4	HBTCB4BK
8 [203.2]	9.88 [251.0]	HBTCB8	HBTCB8BK
12 [304.8]	13.75 [349.3]	HBTCB12	HBTCB12BK
18 [457.2]	17.69 [449.3]	HBTCB18	HBTCB18BK

LIST OF PARTS

DESCRIPTION	MATERIAL	FINISH
C BRACKET	STEEL	SEE TABLE

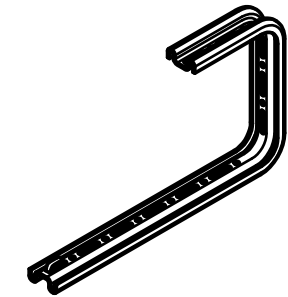

CATALOG NO. HBTCB12 (NOT SHOWN TO SCALE)

1	INITIAL DOCUMENT	DDL	11/15/16
	RELEASE PER DCN 22750		
REV	DESCRIPTION	APP	DATE

THE DESIGN AND DIMENSIONS OF THE PRODUCT SHOWN ON THIS DRAWING ARE SUBJECT TO CHANGE WITHOUT NOTICE. DIMENSIONS ARE IN INCHES [mm].

TITLE
C-BRACKET

WIRING DEVICE-KELLEMS
HUBBELL INCORPORATED
SHELTON, CT

TOLERANCES UNLESS OTHERWISE SPECIFIED .XX = ±.01 .XXX = ±.005 ANGLE TOL. ±2'	DR. BY GM	SCALE NONE
	CHK. BY MN	DATE 09/09/16

NOTES:
1. INSTALL EVERY 6 FEET