

M-13504

1

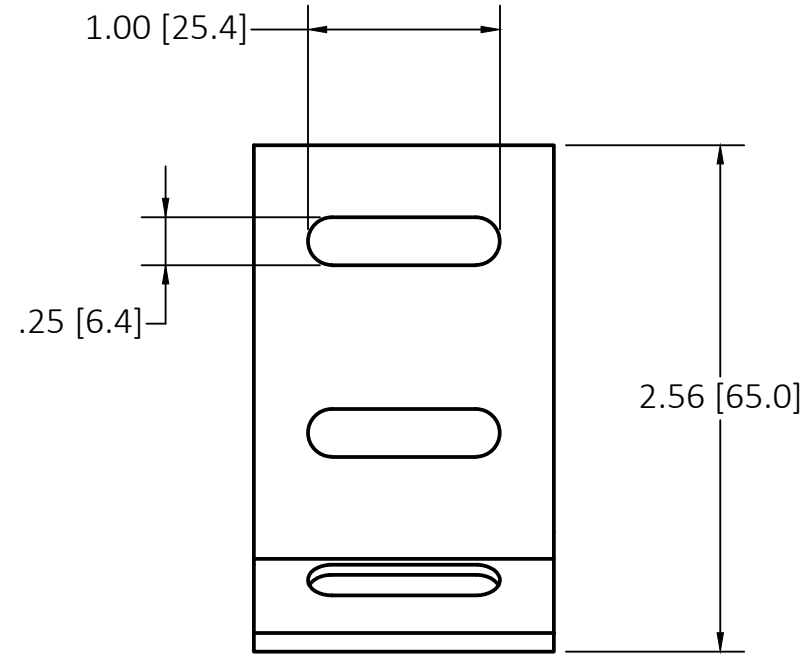

FINISH	CATALOG NUMBER
ZINC PLATED	HBTRA
BLACK	HBTRABK

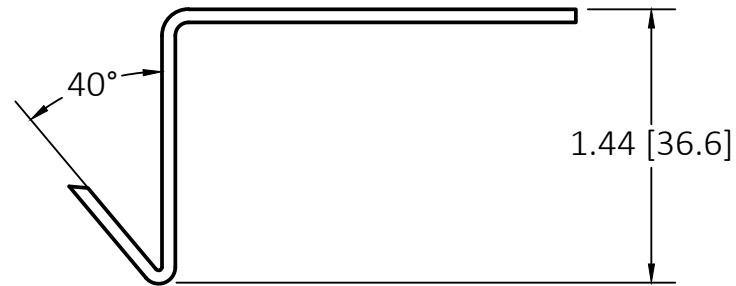
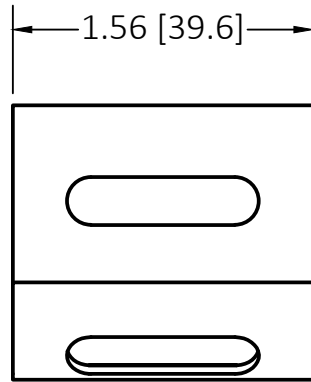

LIST OF PARTS

DESCRIPTION	MATERIAL	FINISH
RACK ATTACHMENT	GALV STEEL	SEE TABLE

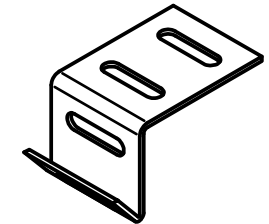

CATALOG NO. HBTRA
(NOT SHOWN TO SCALE)

1	INITIAL DOCUMENT	DDL	11/15/16
	RELEASE PER DCN 22750		
REV	DESCRIPTION	APP	DATE

THE DESIGN AND DIMENSIONS OF THE PRODUCT SHOWN ON THIS DRAWING ARE SUBJECT TO CHANGE WITHOUT NOTICE. DIMENSIONS ARE IN INCHES [mm].

TITLE
RACK ATTACHMENT

WIRING DEVICE-KELLEMS HUBBELL INCORPORATED
 SHELTON, CT

TOLERANCES UNLESS OTHERWISE SPECIFIED .XX = ± .01 .XXX = ± .005 ANGLE TOL. ±2°	DR. BY BJ	SCALE NONE
	CHK. BY MN	DATE 08/16/16

NOTES:
1. ATTACHES TRAY DIRECTLY TO THE TOP OF A STANDARD RACK

DIMENSION SHEET FOR CAT. NO. M-13504