

M-11420 3

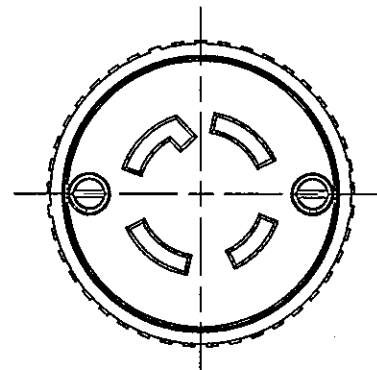
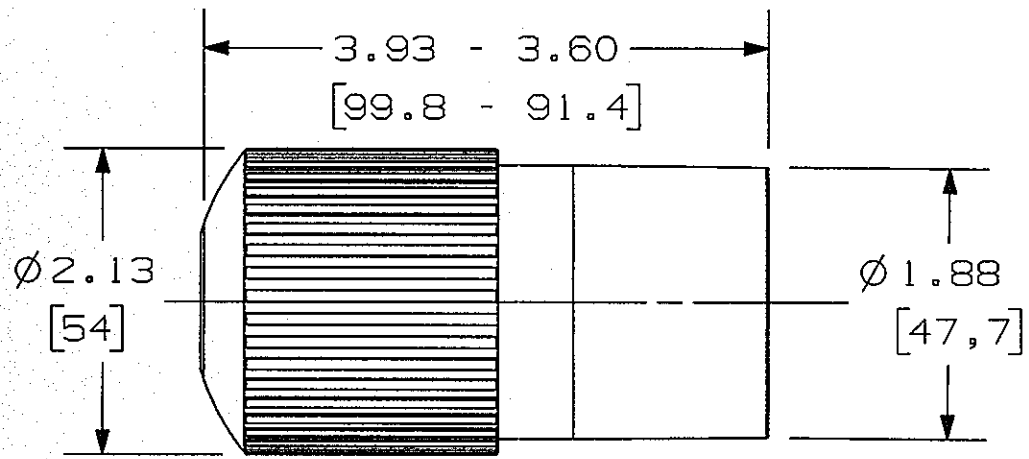

L1430C SHOWN

NOTES:

1. ALL DEVICES ARE UL LISTED, CSA CERTIFIED.
2. ALL DEVICES ARE FED SPEC. EXCEPT FOR L1620C, L1630C AND L2320C.

CORD RANGE
4 CONDUCTOR

10/4 SJ, 14/4 SO - 8/4 SO
.625 in - 1.050 in
15.9 mm - 26.67 mm

5 CONDUCTOR

14/5 SO - 8/5 SO
.625 in - 1.050 in
15.9 mm - 26.67 mm

LIST OF PARTS

DESCRIPTION	MATERIAL	FINISH
PULL DOWN RING	NYLON	BLACK
GRIP BODY	NYLON	BLACK
TERMINAL COVER	LEXAN	
DRIVE SCREW	STEEL	ZINC PLATE
DUST COVER	RUBBER	
ASSEMBLY SCREW	STEEL	ZINC PLATE
TERMINAL SCREW	STEEL	GREEN/NICKEL/BRASS
WIRE CLAMP NUT	STEEL	BRASS/STEEL/TIN PLATE
CONTACTS	BRASS	
PLUG FACE	NYLON	WHITE

DIMENSION SHEET FOR CAT. NO. SEE TABLE

REPAIRABLE NON-REPAIRABLE

B

M-11420

3

NEMA NO.	RATING	POLE/WIRE	CAT. NO.	CONFIG.
L14-20R	20A, 125/250VAC	3P, 4W GROUNDING	L1420C	
L15-20R	20A, 3Ø 250VAC	3P, 4W GROUNDING	L1520C	
L16-20R	20A, 3Ø 480VAC	3P, 4W GROUNDING	L1620C	
L14-30R	30A, 125/250VAC	3P, 4W GROUNDING	L1430C	
L15-30R	30A, 3Ø 250VAC	3P, 4W GROUNDING	L1530C	
L16-30R	30A, 3Ø 480VAC	3P, 4W GROUNDING	L1630C	
L21-20R	20A, 3ØY 120/208VAC	4P, 5W GROUNDING	L2120C	
L22-20R	20A, 3ØY 277/480VAC	4P, 5W GROUNDING	L2220C	
L23-20R	20A, 3ØY 347/600VAC	4P, 5W GROUNDING	L2320C	
L21-30R	30A, 3ØY 120/208VAC	4P, 5W GROUNDING	L2130C	
L22-30R	30A, 3ØY 277/480VAC	4P, 5W GROUNDING	L2230C	
L23-30R	30A, 3ØY 347/600VAC	4P, 5W GROUNDING	L2330C	

3	NOTE 2 ADDED L2320C. PER DCN 22737 SPN	DJP	11/28/16
2	ADDED CATS. L2120C, L2220C, L2320C, L2130C, L2230C AND L2330C. PER DCN 17744 SPN	DJP	7/8/11
1	RELEASE FOR PRODUCTION PER DCN 16041 MJM MAM	TLS	10/13/09
SYM	REVISIONS	APP	DATE

THE DESIGN AND DIMENSIONS OF THE PRODUCT SHOWN ON THIS DRAWING ARE SUBJECT TO CHANGE WITHOUT NOTICE

TITLE
20 & 30A LOCKING
4 & 5 WIRE CONNECTORS

TOLERANCES UNLESS OTHERWISE SPECIFIED .XX = ±.01 .XXX = ±.005 ANGLES = ±2°	WIRING DEVICE-KELLEMS HUBBELL INCORPORATED SHELTON, CT	
	DR. BY MJM	APP. BY TLS
	TR. BY	SCALE 1:1
	CHK. BY	DATE 10/13/09