

M-14499

1

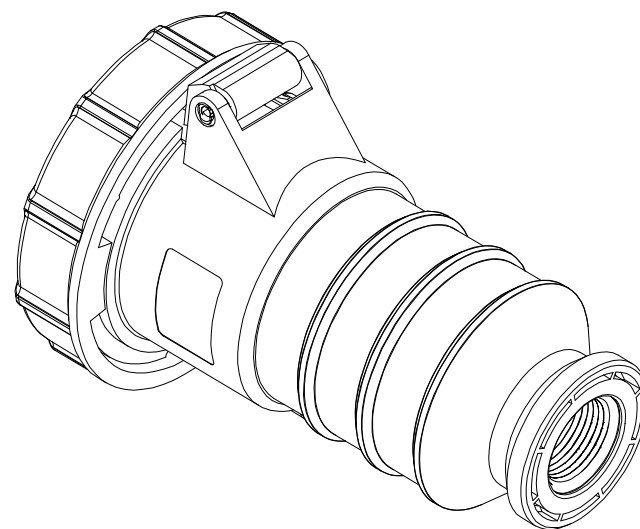
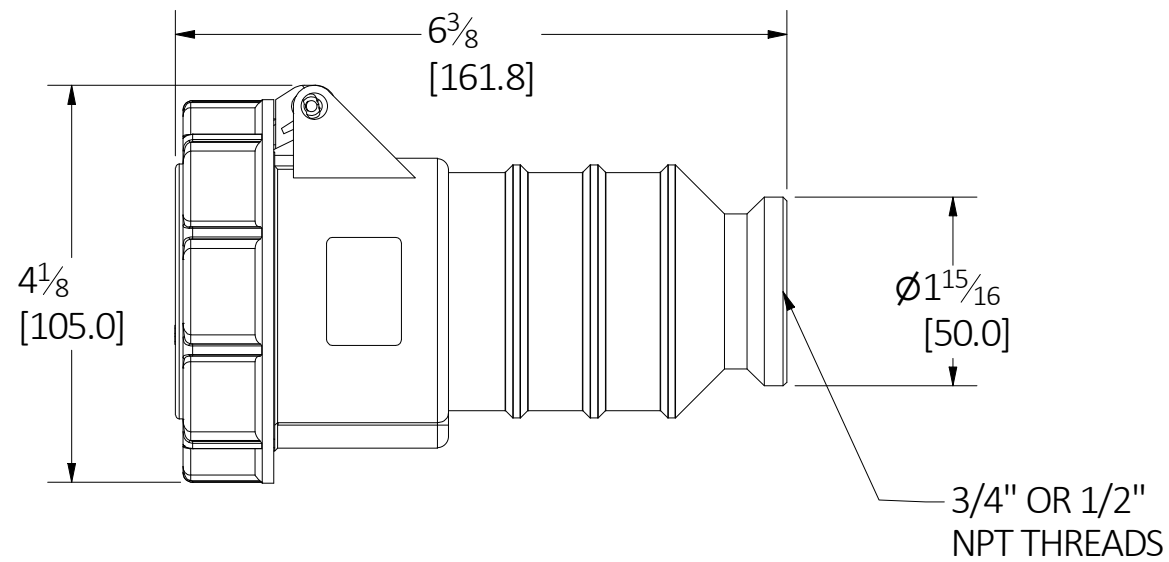
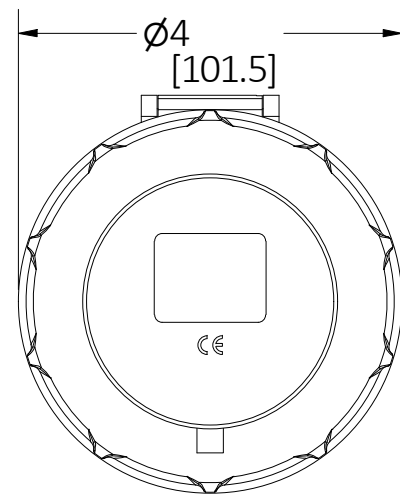

LIST OF PARTS		
DESCRIPTION	MATERIAL	FINISH
HOUSING	PBT/PC	
INTERIOR	NYLON GF	
SLEEVES	COPPER ALLOY	
COVER	PBT/PC	
GASKET	TPE/EPDM	
HINGE ARM	PBT/PC	
HINGE PIN	COPPER ALLOY	NICKEL PL.
HINGE SPRING	ST. STEEL	
ASSY. SCREWS	ST. STEEL	

DIMENSION SHEET FOR CAT. NO. SEE TABLE

NOTES:

1. UNITS ARE INCHES [mm].
2. UL LISTED. ENV. RATING IP67.
3. WIRE RANGE #12 AWG TO #8 AWG.
4. USES SPRING TERMINATIONS FOR EASY WIRE INSTALLATIONS.
5. ACCEPTS STANDARD UL LISTED 1/2", 3/4" TRADE SIZE LIQUID TIGHT FITTINGS BOTH METALLIC & NON METALLIC.

SUB.	REVISIONS
1	01/24/22 NEW RELEASE PER DCN 220124016287 CAC

LIQUID TIGHT CAT. NO.'S	
CATALOG NO.	TRADE SIZE
C530C5WLT34	3/4 IN.
C530C6WLT34	3/4 IN.
C530C7WLT34	3/4 IN.
C530C9WLT34	3/4 IN.
C530C5WLT12	1/2 IN.
C530C6WLT12	1/2 IN.
C530C7WLT12	1/2 IN.
C530C9WLT12	1/2 IN.

THE DESIGN AND DIMENSIONS OF THE PRODUCT SHOWN ON THIS DRAWING ARE SUBJECT TO CHANGE WITHOUT NOTICE. DIMENSIONS ARE IN INCHES [mm].

TITLE  
30A PIN AND SLEEVE HUBBELL PRO WLT (IP67) LIQUID TIGHT CONNECTOR

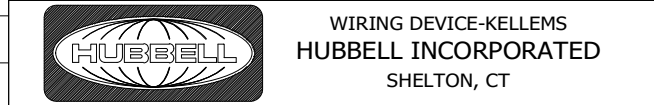

TOLERANCES UNLESS OTHERWISE SPECIFIED -XX = ±.01 -XXX = ±.005 ANGLE TOL. ±2'	DR. BY CAC	SCALE 1/2
	CHK. BY	DATE 01/15/22

B

M-14499

1