

S1R8PTFITX

NOTES:

1. S1R8PT SUB-PLATES SUPPLIED WITH PRE WIRED , MOLDED , FOUR POSITION 20A, 125V BLACK RECEPTACLES.
2. FOLLOW MANUFACTURERS DIRECTIONS AND GUIDELINES FOR THE INSTALLATION AND MOUNTING OF THE POKE THRU AND ALL OF THE ASSOCIATED COMPONENTS.
3. FITX REPRESENTS FIT1,FIT2 OR FIT3 BASED ON REPLACEMENT FITTING BOX.
4. INCLUDES FLANGE AND UNIVERSAL COVER ASSEMBLY (S1R8CVRxx).
5. xx INDICATES FINISH OPTIONS. (BRUSHED ALUMINUM, BLACK POWDER COAT, BRASS , BRONZE , NICKEL PLATED)

REV	DESCRIPTION	APP	DATE
-----	-------------	-----	------

THE DESIGN AND DIMENSIONS OF THE PRODUCT SHOWN ON THIS DRAWING ARE SUBJECT TO CHANGE WITHOUT NOTICE

TITLE
8" RECESSED POKE-THROUGH

TOLERANCES UNLESS OTHERWISE SPECIFIED .XX = ± .01 .XXX = ± .005 ANGLES = ± 2'	WIRING DEVICE-KELLEMS HUBBELL INCORPORATED SHELTON, CT	
	DR. BY	APP. BY
	TR. BY	SCALE
	CHK. BY	DATE

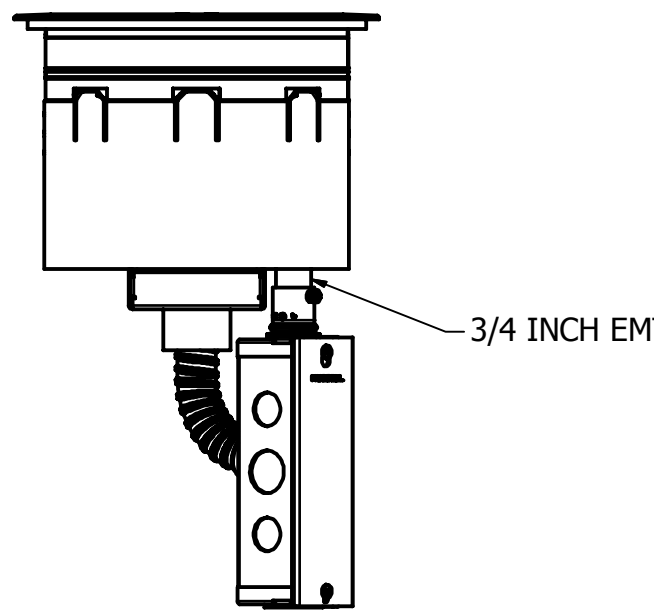

CATALOG NUMBER- S1R8PTFIT*

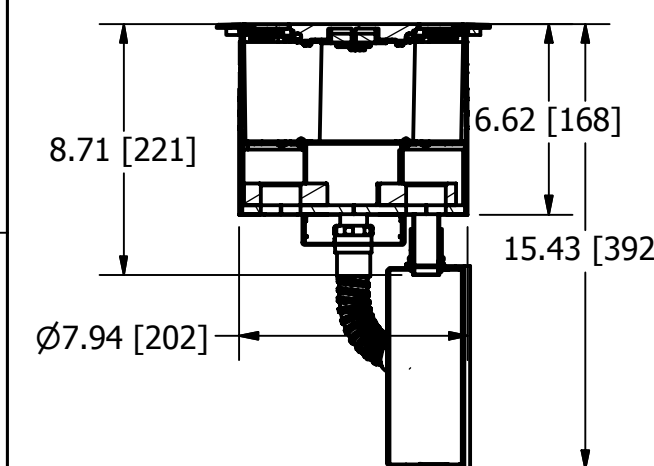
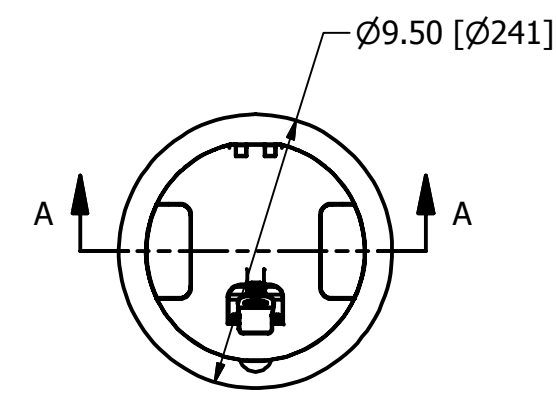

SECTION A-A
SCALE .15

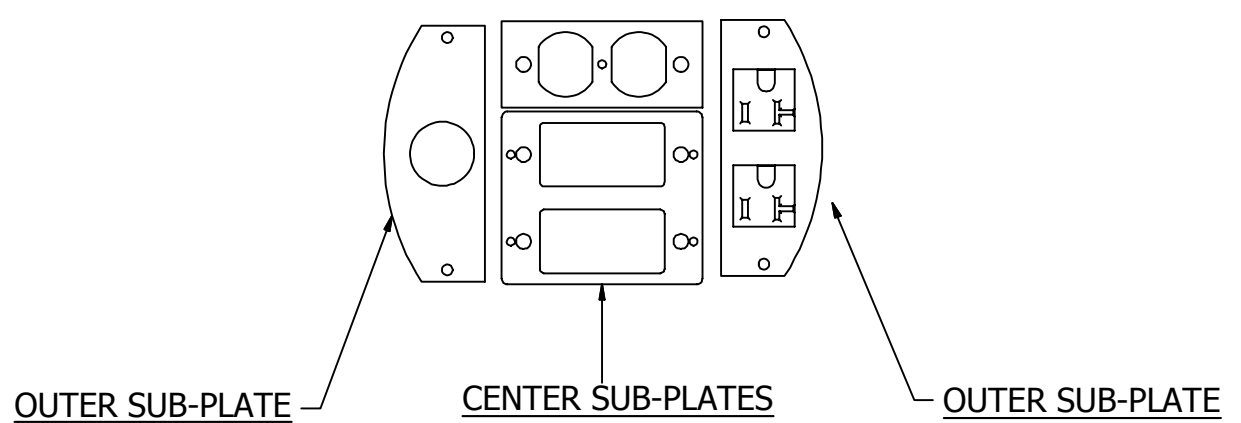

CENTER SUB-PLATES WITH OUTER SUB PLATES

NOTES:

1. SUB PLATES INCLUDES CENTER SUB-PLATES WITH OUTER SUB-PLATES.
2. CENTER PLATE CONFIGURATIONS ALLOWS FOR 3 DUPLEXES OR UPTO 18DATA/AV JACKS. OTHER COMBINATION POSSIBLE.
3. OUTER PLATE CONFIGURATIONS AVAILABLE IN PRE-WIRED DUPLEXES OR OPENINGS TO ACCOMMODATE THIRD PARTY AV DEVICES.

REV	DESCRIPTION	APP	DATE

THE DESIGN AND DIMENSIONS OF THE PRODUCT SHOWN ON THIS DRAWING ARE SUBJECT TO CHANGE WITHOUT NOTICE

TITLE
8" RECESSED POKE-THROUGH

TOLERANCES UNLESS OTHERWISE SPECIFIED		WIRING DEVICE-KELLEMS HUBBELL INCORPORATED SHELTON, CT	
.XX = ± .01	DR. BY	APP. BY	
.XXX = ± .005	TR. BY	SCALE	
ANGLES = ± 2'	CHK. BY	DATE	

BOTTOM JUNCTION BOXES

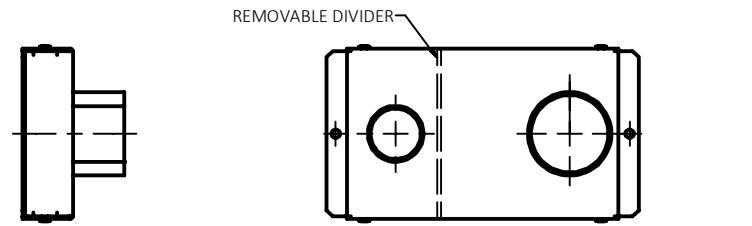

S1R8JNC1
1" & 1-1/2" EMT

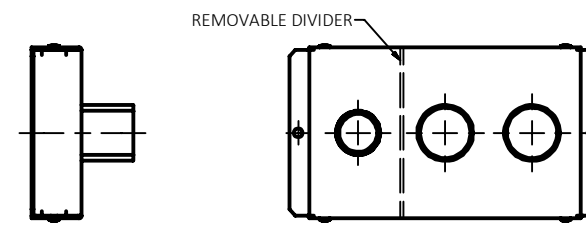

S1R8JNC7
3/4" & (2) 1" EMT

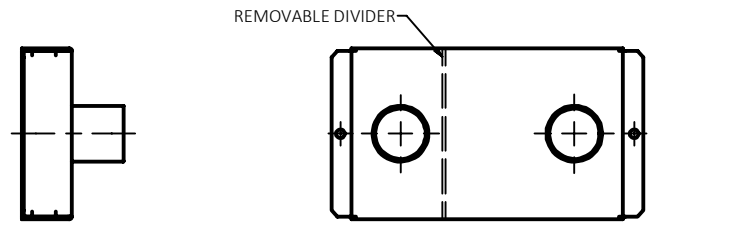

S1R8JNC2
(2) 1" EMT

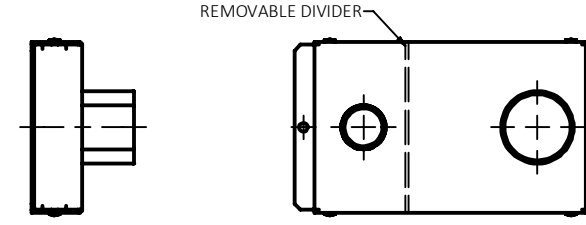

S1R8JNC8
3/4" & 1-1/4" EMT

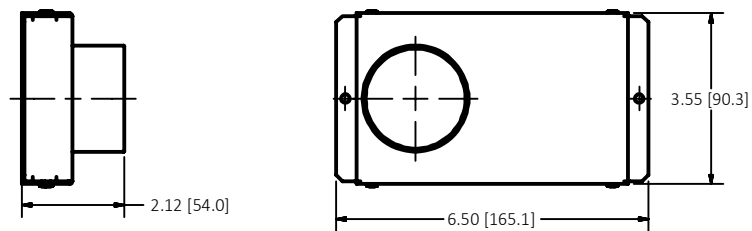

S1R8JNC3
2" EMT

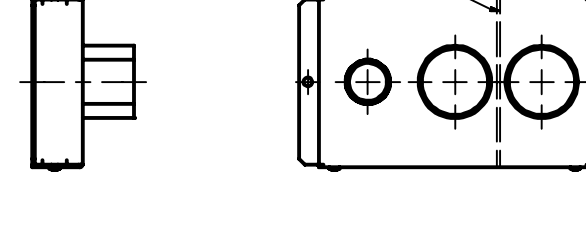

S1R8JNC9
3/4" & (2) 1-1/4" EMT

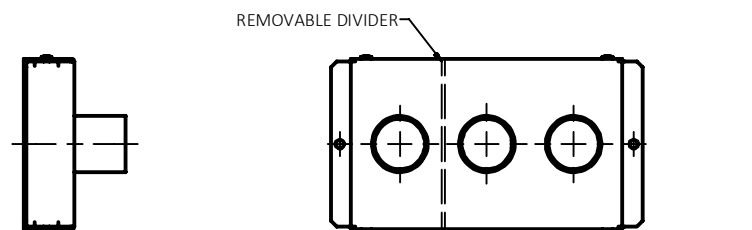

S1R8JNC4
(3) 1" EMT

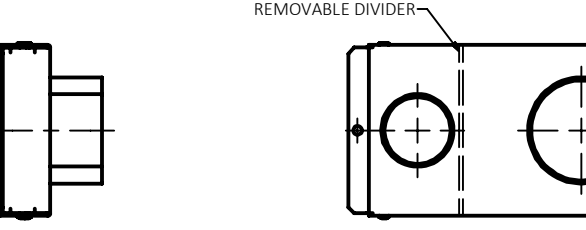

S1R8JNC10
2" & 1-1/4" EMT

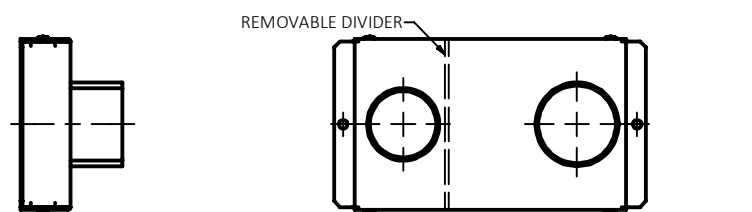

S1R8JNC5
1-1/2" & 1-1/4" EMT

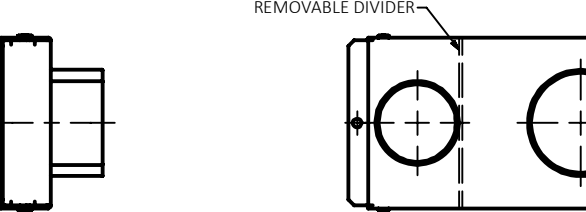

S1R8JNC11
2" & 1-1/2" EMT

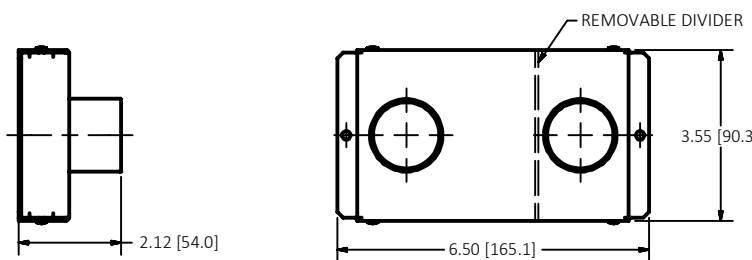

S1R8JNC6
(2) 1-1/4" EMT

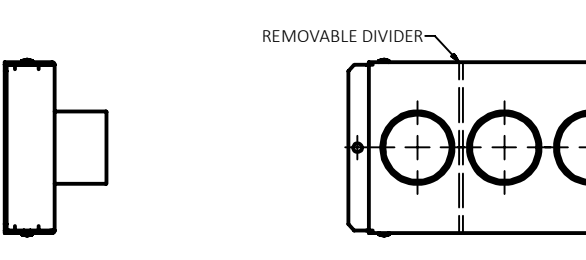

S1R8JNC12
(3) 1-1/4" EMT

- NOTE:**
1. ALL DIMENSIONS ARE COMMON TO ALL CATALOG NUMBERS. BOTTOM FEED BOXES VARY AS SPECIFIED.
 2. (2) MOUNTING SCREWS SHIPPED LOOSELY (NOT SHOWN).

THE DESIGN AND DIMENSIONS OF THE PRODUCT SHOWN ON THIS DRAWING ARE SUBJECT TO CHANGE WITHOUT NOTICE

TITLE
8" RECESSED POKE-THROUGH

TOLERANCES UNLESS OTHERWISE SPECIFIED .XX = ± .01 .XXX = ± .005 ANGLES = ± 2'	WIRING DEVICE-KELLEMS HUBBELL INCORPORATED SHELTON, CT	
	DR. BY	APP. BY
	TR. BY	SCALE
	CHK. BY	DATE

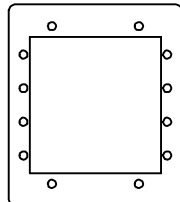
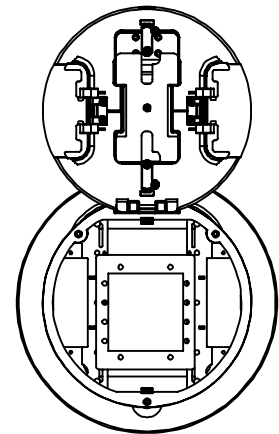

S1R8CSPA

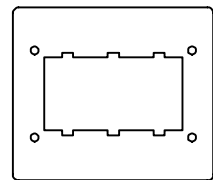
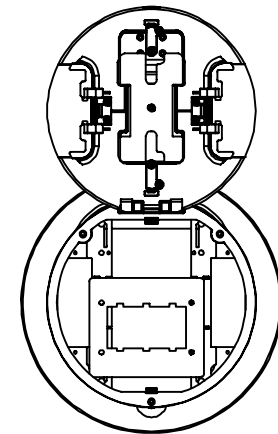

S1R8CSPL

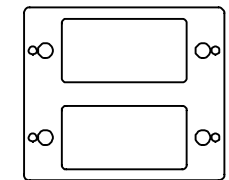
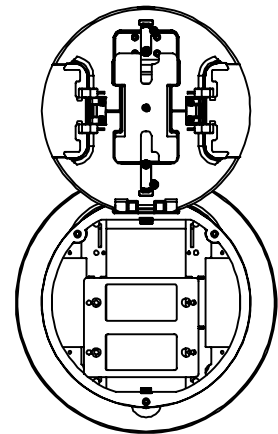

S1R8CSPM

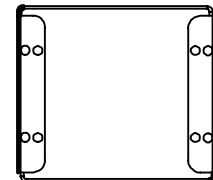
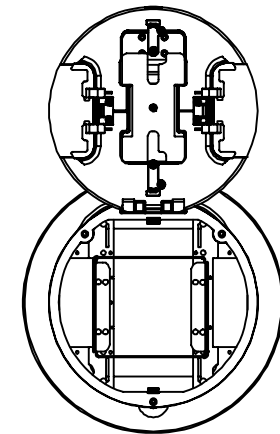

S1R8CSPEXT

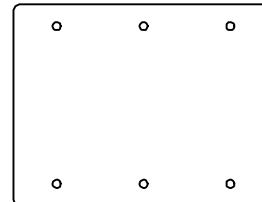
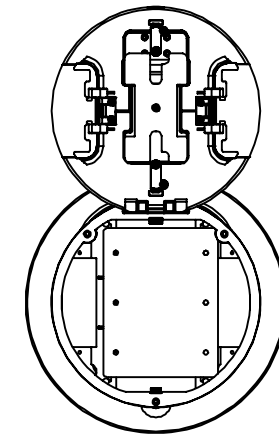

S1R8CSPN

CENTER SUB-PLATES - TWO AND THREE GANG

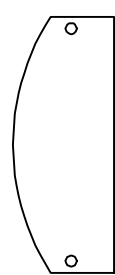
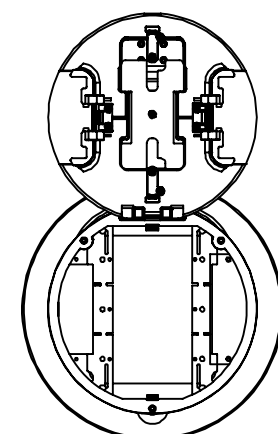

S1R8PSPU

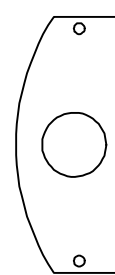
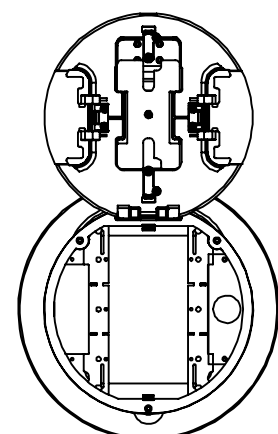

S1R8PSPW

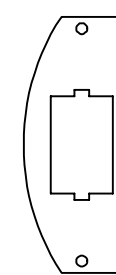
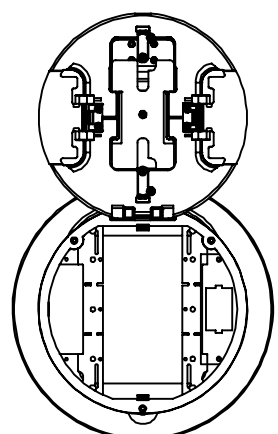

S1R8PSPY

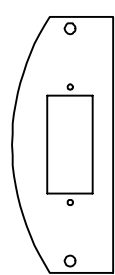
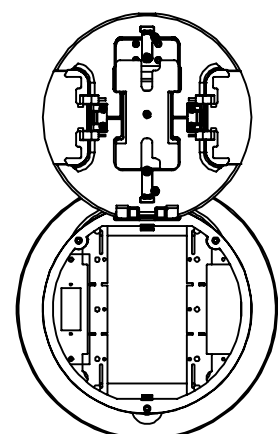

S1R8PSPV

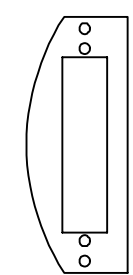
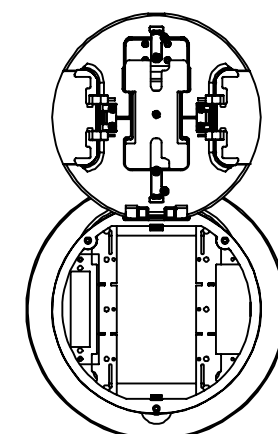

S1R8PSPX

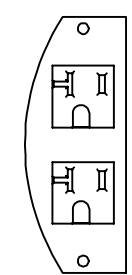
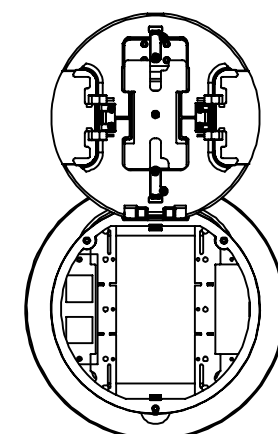

S1R8PSPZ

OUTER SUB-PLATES

FRPT ASSEMBLY 8 INCH SUBPLATE REQUIRED FOR ALL APPLICATIONS, SOLD SEPARATELY

THE DESIGN AND DIMENSIONS OF THE PRODUCT SHOWN ON THIS DRAWING ARE SUBJECT TO CHANGE WITHOUT NOTICE

TITLE
8" RECESSED POKE-THROUGH

TOLERANCES UNLESS OTHERWISE SPECIFIED .XX = ± .01 .XXX = ± .005 ANGLES = ± 2'	WIRING DEVICE-KELLEMS HUBBELL INCORPORATED SHELTON, CT	
	DR. BY	APP. BY
	TR. BY	SCALE
	CHK. BY	DATE

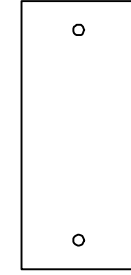
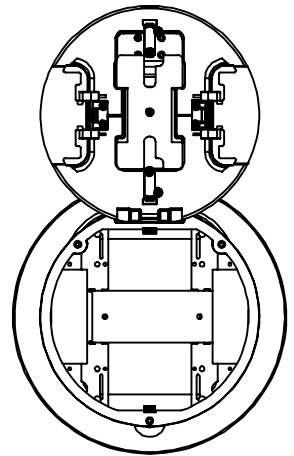

S1R8CSPB

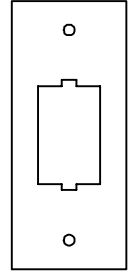
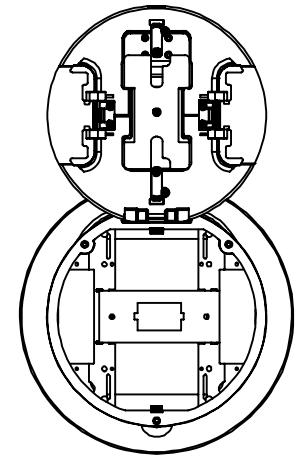

S1R8CSPD

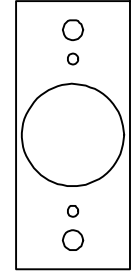
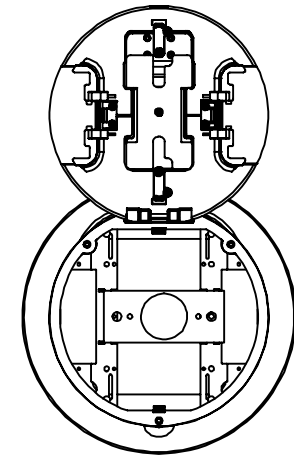

S1R8CSPG

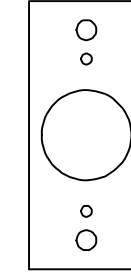
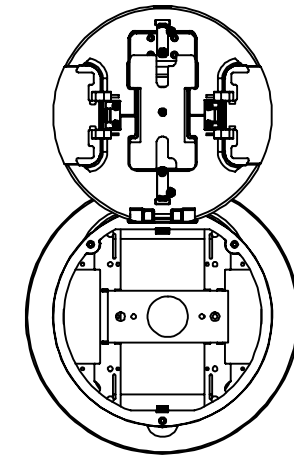

S1R8CSPJ

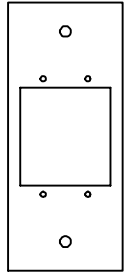
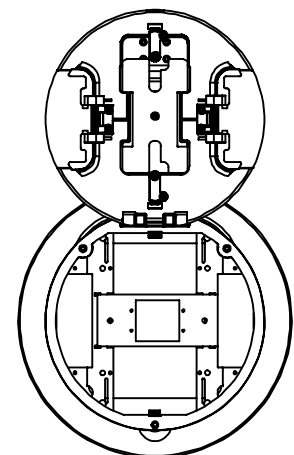

S1R8CSPC

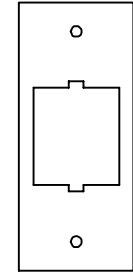
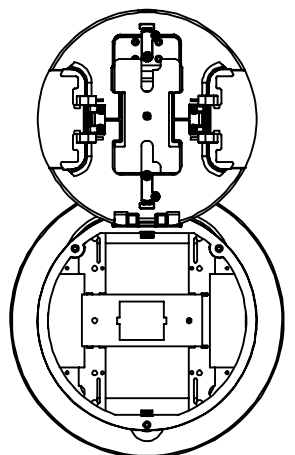

S1R8CSPE

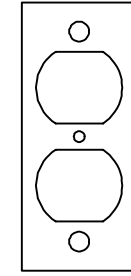
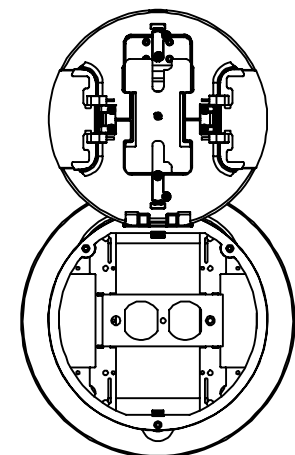

S1R8CSPI

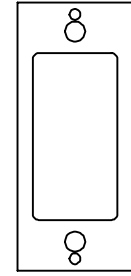
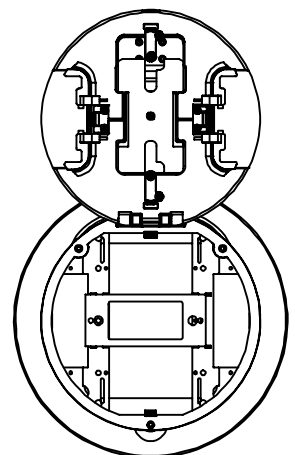

S1R8CSPK

CENTER SUB-PLATES - SINGLE GANG

NOTE:

1. RECTANGULAR SUB PLATES ARE FOR CENTER COMPARTMENT , CRESCENT SUB PLATES ARE FOR OUTER COMPARTMENTS AND ARE NOT INTER-CHANGEABLE.

THE DESIGN AND DIMENSIONS OF THE PRODUCT SHOWN ON THIS DRAWING ARE SUBJECT TO CHANGE WITHOUT NOTICE

TITLE
8" RECESSED POKE-THROUGH

TOLERANCES UNLESS OTHERWISE SPECIFIED .XX = ± .01 .XXX = ± .005 ANGLES = ± 2'	WIRING DEVICE-KELLEMS HUBBELL INCORPORATED SHELTON, CT	
	DR. BY	APP. BY
	TR. BY	SCALE
	CHK. BY	DATE