

TOP VIEW 1

M-12149			1	
WLP150H	HALLWAY PASSIVE INFRARED OCCUPANCY/VACANCY SENSOR	SAME AS WLP3000W	1	1
WLP2500W	CORNER-MOUNT (90 DEGREE) PASSIVE INFRARED OCCUPANCY/VACANCY SENSOR	SAME AS WLP3000W	2	2
WLP3000W	WALL-MOUNT (180 DEGREE) PASSIVE INFRARED OCCUPANCY/VACANCY SENSOR	OCCUPANCY - ON /VACANCY - OFF, MANUAL ON OR AUTO OFF	1	1
CAT. #	DESCRIPTION	CONTROL TYPE	SIDE VIEW	TOP VIEW

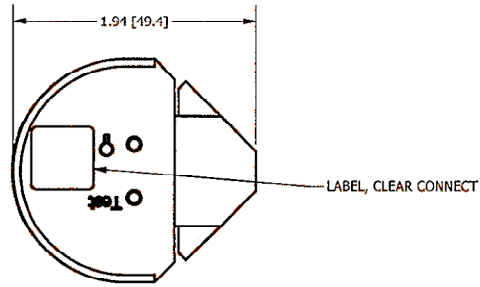

TOP VIEW 2

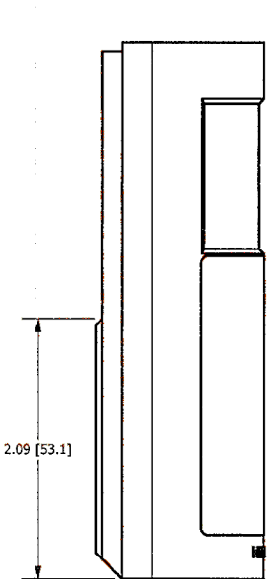

SIDE VIEW 1

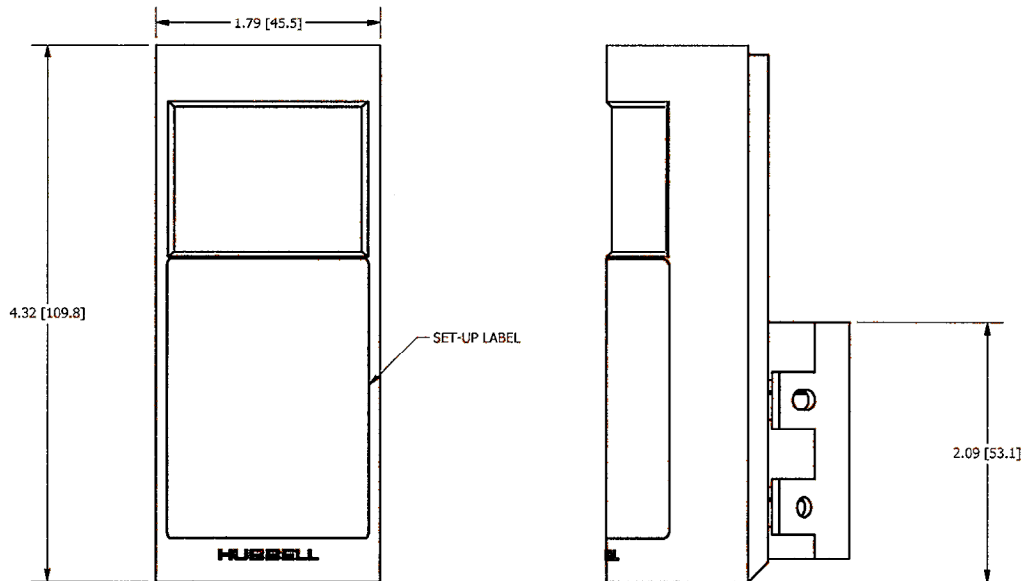

FRONT VIEW

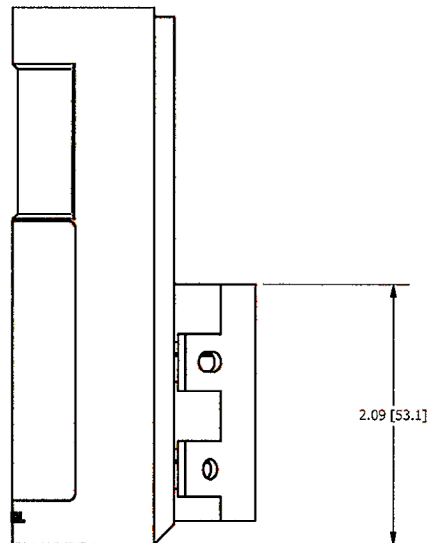

SIDE VIEW 2

NOTES: (UNLESS OTHERWISE SPECIFIED)

1. ALL DIMENSIONS ARE IN INCHES [mm].
2. OPERATING POWER SOURCE: 3 VDC 14  $\mu$ A.
3. OPERATING FREQUENCY: 434 MHz.
4. ENVIRONMENT: FOR INDOOR USE ONLY, TEMP. 32 °F ~ 104 °F (0 °C ~ 40 °C).
5. SENSORS CAN BE ADDED TO EACH RF SWITCHING DEVICE FOR EXTENDED COVERAGE.
6. EACH SENSOR MAY BE ADDED TO COMPATIBLE RF SWITCHING DEVICES FOR SPACES WITH MULTIPLE ZONES OF LIGHTING.

CODE 74545

LIST OF PARTS		
DESCRIPTION	MATERIAL	FINISH
FRONT	POLYESTER	
BACK	POLYESTER	
BATTERY COVER	POLYESTER	
PCB	EPOXY RESIN	
SCREWS	STEEL	Zn PLATE

1	NEW RELEASE PER DCN #18001	DL	4/18/12
SYM	DESCRIPTION	APPRO	DATE

THE DESIGN AND DIMENSIONS OF THE PRODUCT SHOWN ON THIS DRAWING ARE SUBJECT TO CHANGE WITHOUT NOTICE

TITLE OCCUPANCY/ VACANCY SENSOR; WALL, CORNER OR HALLWAY MOUNT

TOLERANCES UNLESS OTHERWISE SPECIFIED FRACTIONS $\pm 1/64$ DECIMALS $\pm .005$ ANGLES $\pm 2'$	WIRING DEVICE-HELLEMS HUBBELL INCORPORATED SHELTON, CT		
	DR. BY	DL	APP. BY <i>SM</i>
	TR. BY		SCALE 1:1
	CHK'D BY <i>SM</i>		DATE 1/17/2012