

M-10048 2

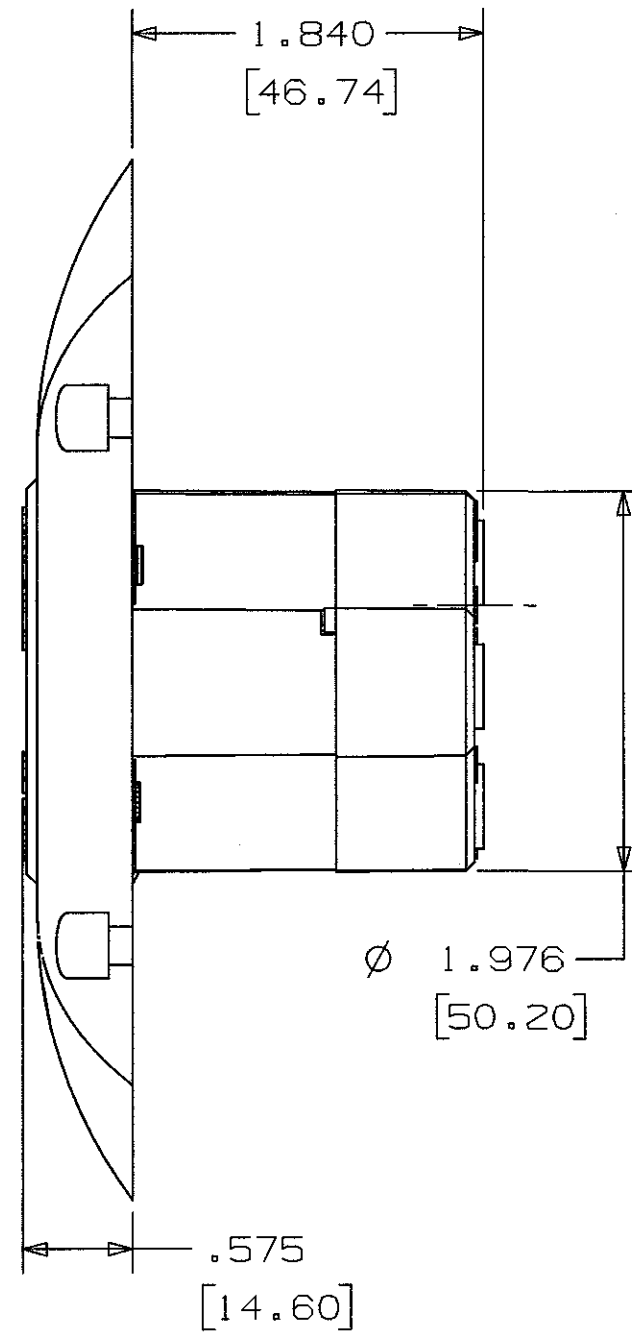
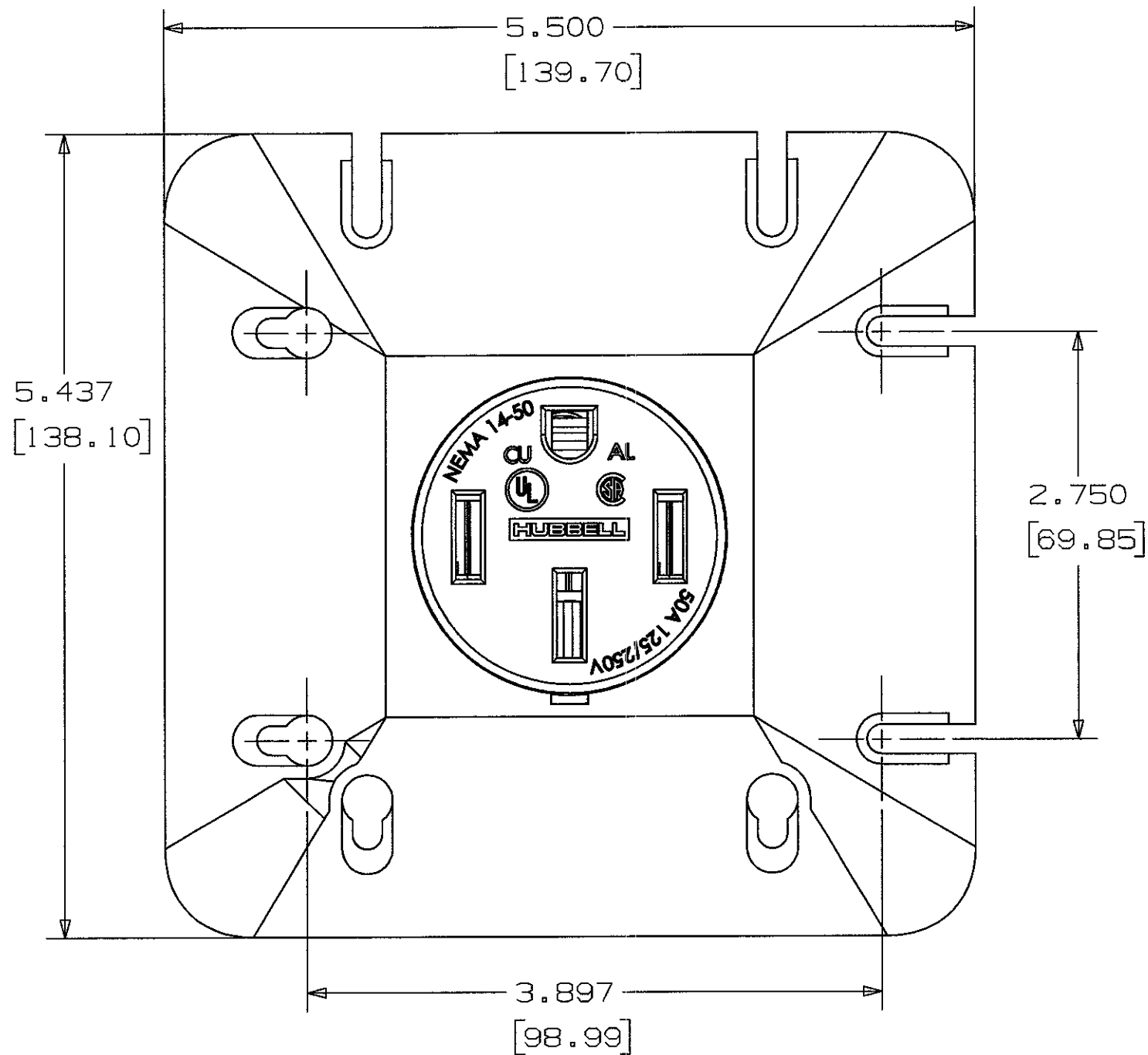

| LIST OF PARTS | | |
|-----------------|----------|--------|
| DESCRIPTION | MATERIAL | FINISH |
| WALLPLATE | PLASTIC | |
| HOUSING | PLASTIC | |
| CONTACTS | BRASS | |
| WIRE TERMINALS | ALUMINUM | TIN |
| TERMINAL SCREWS | STEEL | ZINC |
| MOUNTING SCREWS | STEEL | ZINC |
| GROUND SHUNT | BRASS | |
| | | |
| | | |
| | | |
| | | |
| | | |
| | | |

- NOTES: (UNLESS OTHERWISE SPECIFIED)
1. ALL DIMENSIONS ARE INCHES [MM].
 2. FOR USE WITH ALUMINUM AND COPPER WIRE SOLID OR STRANDED.
 3. AWG WIRE RANGE #4-#10.
 4. MOUNTS ON 4 1/16" SQUARE BOX.
 4. (4) MOUNTING SCREWS - NOT SHOWN (#6 32UNC).

| | | | |
|--|--|--|--|
| | | | |
| | | | |
| | | | |
| | | | |
| | | | |
| | | | |
| | | | |
| | | | |
| | | | |
| | | | |

| | | | |
|-----|--|-----|----------|
| 2 | 11/21/07 REVISED VIEWS TO SHOW NEW 8 HOLE PLATE PER EC 14289 | DMP | 11/21/07 |
| 1 | RELEASED PER DCN 13450 AMZ | DMP | 11/17/06 |
| SYM | REVISIONS | APP | DATE |

THE DESIGN AND DIMENSIONS OF THE PRODUCT SHOWN ON THIS DRAWING ARE SUBJECT TO CHANGE WITHOUT NOTICE

TITLE
 FLUSH MOUNT POWER RECEPT.
 4 WIRE 50 AMP

| | | |
|---------------------------------------|---|---------------|
| TOLERANCES UNLESS OTHERWISE SPECIFIED | WIRING DEVICE-KELLEMS HUBBELL INCORPORATED BRIDGEPORT, CT | |
| FRACTIONS ± 1/64 | DR. BY AMZ | APP. BY DMP |
| DECIMALS ± .005 | TR. BY | SCALE NONE |
| ANGLES ± 2° | CHK'D BY DMP | DATE 11/15/06 |